

VAIA Five-hole bath mixer for deck mounting with diverter - Brushed Champagne (22kt Gold)

VAIA

27 522 819 Product version from 3/13/2017



- spout: circular, air-enriched flow
- max. flow 21.5 l/min at 3 bar flow pressure
- Hand shower: COMPACT RAIN, max. flow rate 6.8 l/min (at 3 bar)
- complete hand shower set with anti-scale system
- automatic bath/shower diverter
- 220mm projection
- height of mixer 347 mm
- height up to aerator 244 mm
- hole diameter spout 32 mm
- hole diameter valve 32 mm
- hole diameter for complete hand shower set 32 mm
- rosette for spout Ø 60mm
- rosette for complete hand shower set Ø 60mm
- rosette for deck valve Ø 60mm
- metal shower hose 1750mm with integrated anti-twist protection
- WRAS

Intrinsic protection against back flow.

	Brushed Champagne (22kt Gold)	27 522 819-46
	Chrome	27 522 819-00
	Brushed Platinum	27 522 819-06
	Platinum	27 522 819-08
	Dark Chrome	27 522 819-19
	Brushed Durabronze (23kt Gold)	27 522 819-28
	Brushed Dark Brass	27 522 819-39
	Brushed Bronze	27 522 819-42
	Champagne (22kt Gold)	27 522 819-47
	Brushed Dark Platinum	27 522 819-99

VAIA Five-hole bath mixer for deck mounting with diverter - Brushed Champagne (22kt Gold)

VAIA

27 522 819 Product version from 3/13/2017
mm [inches]
M 1:10

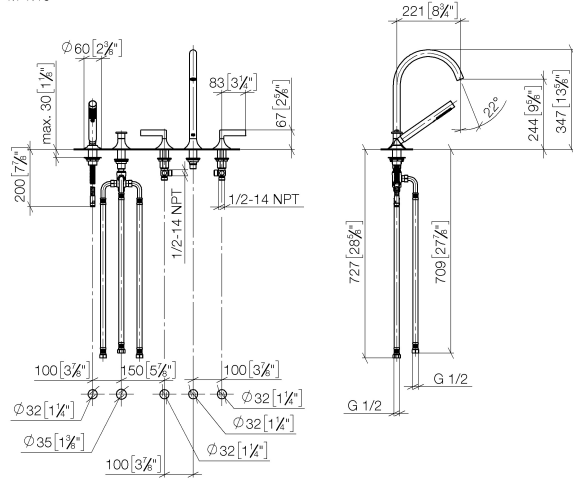

Flow rate chart

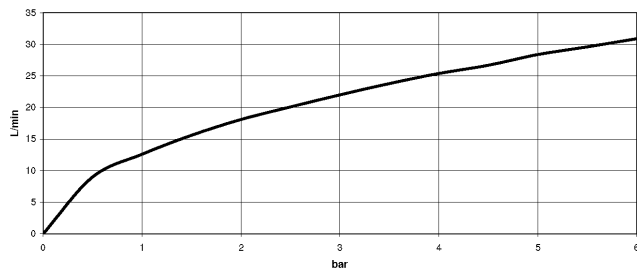

Codes & Standards

ASME A112.18.1	cUPC	DIN 4109	EN 1717
----------------	------	----------	---------

Executive Order no. 1007	ISO 3822	Ü-Zeichen
-----------------------------	----------	-----------



VAIA Five-hole bath mixer for deck mounting with diverter - Brushed Champagne (22kt Gold)

VAIA

27 522 819 Product version from 3/13/2017

Certificates and sustainability

IAPMO_4976

Belgaqua_22_278_2 WRAS_2310

LGA_29

VAIA Five-hole bath mixer for deck mounting with diverter - Brushed Champagne (22kt Gold)

VAIA

27 522 819 Product version from 3/13/2017

Parts for other
finishes can be found
here: [Chrome](#)

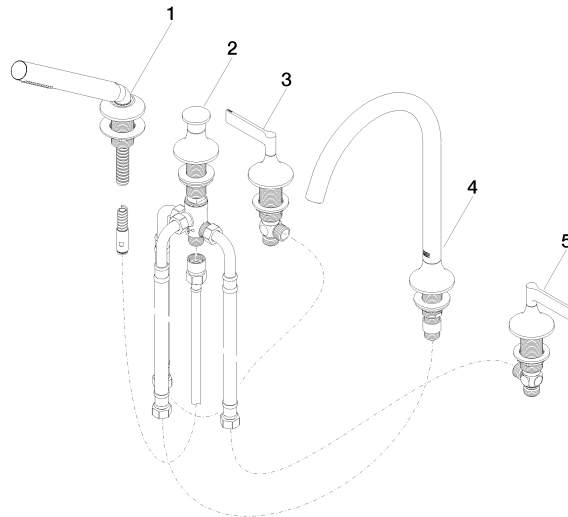

Spare parts list

No.	Item Number	Name	Quantity used	Delivery time
1	27 702 809-46	VAIA Hand shower set for bath rim or tile edge installation - Brushed Champagne (22kt Gold)	1.00	30
2	29 140 809-46	VAIA Two-way diverter for bath rim or tile edge installation - Brushed Champagne (22kt Gold)	1.00	30
3	20 000 818-46	handle (hot)	1.00	-
Spare part can no longer be ordered, please order the replacement item				
5	20 000 819-46	handle (hot)	1.00	-
Spare part can no longer be ordered, please order the replacement item				
4	13 612 809-46	spout	1.00	-
Spare part can no longer be ordered, please order the replacement item				