

# Hand shower set with individual rosettes with volume control - Brushed Platinum

IMO

27 809 985



Fits: IMO, MEM, CL.1, CYO

- COMPACT RAIN, max. flow rate 15 l/min (at 3 bar)
- with volume control
- with anti-scale system
- 3/8" shower outlet
- rosette for wall elbow 60 x 60mm
- rosette for shower holder 60 x 60mm
- metal shower hose 1250mm with integrated anti-twist protection
- 1/2" wall elbow
- WRAS 2207026

Intrinsic protection against back flow.

	Brushed Platinum	27 809 985-06
	Chrome	27 809 985-00
	Chrome	27 809 985-00 0010
	Brushed Platinum	27 809 985-06 0010
	Platinum	27 809 985-08
	Platinum	27 809 985-08 0010
	Dark Chrome	27 809 985-19 0010
	Brushed Durabass (23kt Gold)	27 809 985-28
	Brushed Durabass (23kt Gold)	27 809 985-28 0010
	Brushed Champagne (22kt Gold)	27 809 985-46
	Brushed Champagne (22kt Gold)	27 809 985-46 0010
	Champagne (22kt Gold)	27 809 985-47
	Champagne (22kt Gold)	27 809 985-47 0010
	Brushed Chrome	27 809 985-93
	Brushed Chrome	27 809 985-93 0010
	Brushed Dark Platinum	27 809 985-99
	Brushed Dark Platinum	27 809 985-99 0010

## Recommended miscellaneous

### Concealed wall elbow -

35 085 970 90



- max. recess depth 163 mm
- min. recess depth 90 mm

## Hand shower set with individual rosettes with volume control - Brushed Platinum

IMO

27 809 985  
mm [inches]

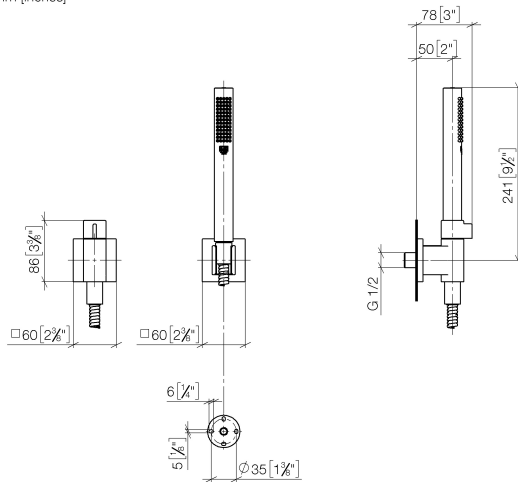

### Flow rate chart



### Codes & Standards

DIN 4109

EN 1717

ISO 3822

Scottish Water  
Byelaws

UK Water Supply  
Regulations

Ü-Zeichen



## Hand shower set with individual rosettes with volume control - Brushed Platinum

IMO

---

27 809 985

Certificates

---

Belgaqua\_21-024-2 LGA\_29

WRAS\_2207

## Hand shower set with individual rosettes with volume control - Brushed Platinum

IMO

27 809 985

Product version up to 6/3/2020

**Product version from 6/3/2020**

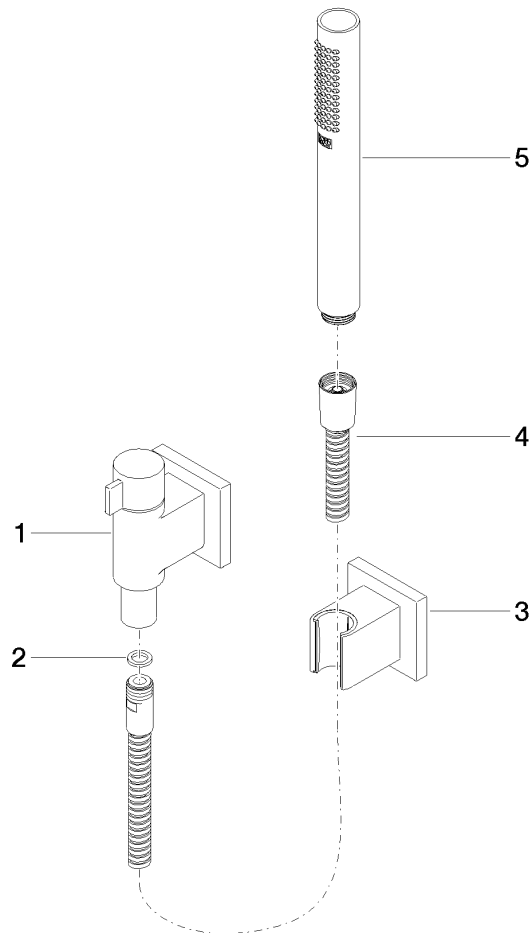



## Hand shower set with individual rosettes with volume control - Brushed Platinum

IMO

27 809 985

### Spare parts list

Product version up to 6/3/2020

#### Product version from 6/3/2020

No.	Item Number	Name	Quantity used	Delivery time
	28 451 985-06	connection	5	60