

MADISON Rain shower with ceiling fixing FlowReduce 200 mm - Brushed Platinum

MADISON

28 564 977







- rain shower Ø 200 mm
- rain flow
- max. flow 7 l/min
- Function from: 6.5 l/min
- with anti-scale system

**Technical data:**

- distance between ceiling and lower edge of the shower 185mm
- rosette Ø 55 mm
- 1/2" connection

**Notes:**

- This product can help a building meet the requirements of Green Building Rating Systems, e.g. LEED®, BREEAM®, DGNB

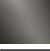
	Brushed Platinum	28 564 977-06
	Chrome	28 564 977-00
	Platinum	28 564 977-08
	Durabrand (23kt Gold)	28 564 977-09
	Brushed Durabrand (23kt Gold)	28 564 977-28
	Brushed Dark Platinum	28 564 977-99

**MADISON Rain shower with ceiling fixing FlowReduce 200 mm - Brushed  
Platinum**

MADISON

28 564 977  
mm [inches]

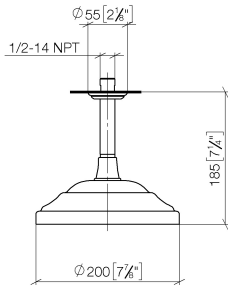

**Flow rate chart**

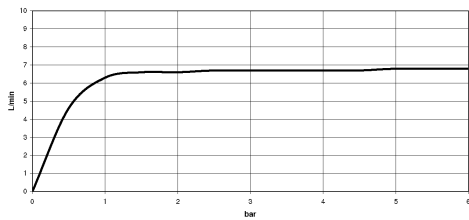

**Codes & Standards**

DIN 4109

ISO 3822

Scottish Water  
Byelaws

UK Water Supply  
Regulations

Ü-Zeichen



MADISON Rain shower with ceiling fixing FlowReduce 200 mm - Brushed  
Platinum

MADISON

28 564 977

Certificates and sustainability

LGA\_38

WRAS\_250102

28 564 977  
Parts for other  
finishes can be found  
here: [Chrome](#)

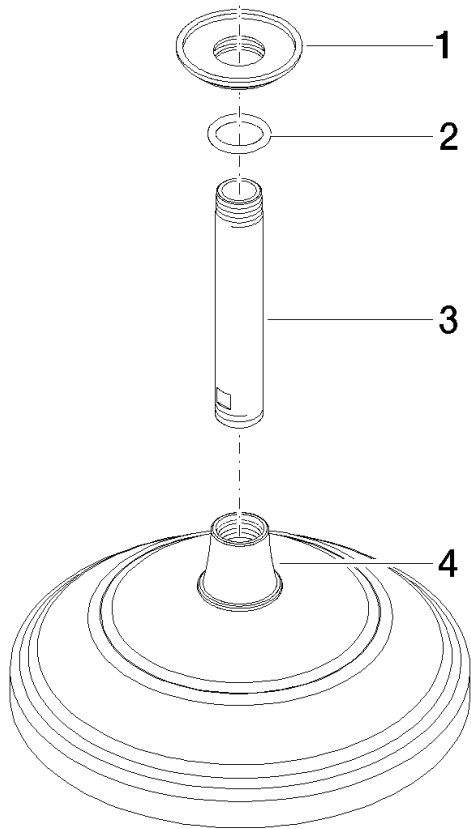

**Spare parts list**

No.	Item Number	Name	Quantity used	Delivery time
3	09 11 03 018-06	connection	1.00	10
1	09 27 35 003-06	rosette	1.00	10
4	90 12 05 038 20-06	shower	1.00	10
2	90 14 10 026 00 90	seal	1.00	2