

## Showerpipe with shower thermostat without hand shower - Brushed Durabrass (23kt Gold)

34 459 980 Product version from 6/1/2024



- shower with fixed riser projection 453mm
- overhead shower: rain flow
- rain shower 300 x 240mm
- rain shower with anti-scale system
- max. rainshower flow 20 l/min
- Function from: 12 l/min
- rotary diverter with volume control and shut-off function
- slide-on rosettes Ø 70 mm
- height of fittings up to rain shower (bottom edge) 1009mm
- height of fittings up to top edge of elbow 1150mm
- gauge 150 mm - 13 mm
- metal shower hose 1750mm with integrated anti-twist protection
- 1/2" connection
- slide bar
- Pipe diameter 23.5 mm
- quick clearing
- WRAS

This article does not include a hand shower!

Intrinsic protection against back flow.

|   |                               |               |
|---|-------------------------------|---------------|
|    | Brushed Durabrass (23kt Gold) | 34 459 980-28 |
|    | Chrome                        | 34 459 980-00 |
|    | Brushed Platinum              | 34 459 980-06 |
|    | Platinum                      | 34 459 980-08 |
|    | Dark Chrome                   | 34 459 980-19 |
|    | Brushed Light Gold            | 34 459 980-27 |
|    | Matte Black                   | 34 459 980-33 |
|    | Brushed Champagne (22kt Gold) | 34 459 980-46 |
|    | Champagne (22kt Gold)         | 34 459 980-47 |
|   | Brushed Chrome                | 34 459 980-93 |
|  | Brushed Dark Platinum         | 34 459 980-99 |

Showerpipe with shower thermostat without hand shower - Brushed Durabross  
 (23kt Gold)

34 459 980    Product version from 6/1/2024

Required miscellaneous

|   |  |               |
|---|--|---------------|
|  | <b>Hand shower - Brushed Durabross (23kt Gold)</b> | 28 018 979-28 |
|---|--|---------------|

Required miscellaneous

|   |  |               |
|---|--|---------------|
|  | <b>Hand shower - Brushed Durabross (23kt Gold)</b> | 28 017 979-28 |
|---|--|---------------|

Required miscellaneous

|   |   |                       |
|---|---|-----------------------|
|  | <b>Hand shower FlowReduce - Brushed Durabross (23kt Gold)</b> | 28 012 979-28<br>0010 |
|---|---|-----------------------|

Required miscellaneous

|   |   |                       |
|---|---|-----------------------|
|  | <b>Hand shower FlowReduce - Brushed Durabross (23kt Gold)</b> | 28 018 979-28<br>0010 |
|---|---|-----------------------|

Required miscellaneous

|   |  |                       |
|---|--|-----------------------|
|  | <b>SERIES-VARIOUS Hand shower FlowReduce - Brushed Durabross (23kt Gold)</b> | 28 029 979-28<br>0010 |
|---|--|-----------------------|

Required miscellaneous

|   |  |                       |
|---|--|-----------------------|
|  | <b>SERIES-VARIOUS Hand shower FlowReduce - Brushed Durabross (23kt Gold)</b> | 28 025 979-28<br>0010 |
|---|--|-----------------------|

Required miscellaneous

|   |  |               |
|---|--|---------------|
|  | <b>Hand shower - Brushed Durabross (23kt Gold)</b> | 28 016 979-28 |
|---|--|---------------|

Required miscellaneous

|   |  |               |
|---|--|---------------|
|  | <b>Hand shower - Brushed Durabross (23kt Gold)</b> | 28 012 979-28 |
|---|--|---------------|

Required miscellaneous

|   |   |                       |
|---|---|-----------------------|
|  | <b>Hand shower FlowReduce - Brushed Durabross (23kt Gold)</b> | 28 016 979-28<br>0010 |
|---|---|-----------------------|

Required miscellaneous

|   |  |                       |
|---|--|-----------------------|
|  | <b>SERIES-VARIOUS Hand shower FlowReduce - Brushed Durabross (23kt Gold)</b> | 28 027 979-28<br>0010 |
|---|--|-----------------------|

Required miscellaneous

|   |   |               |
|---|---|---------------|
|  | <b>SERIES-VARIOUS Hand shower - Brushed Durabross (23kt Gold)</b> | 28 029 979-28 |
|---|---|---------------|

**Showerpipe with shower thermostat without hand shower - Brushed Durabronz  
(23kt Gold)**

34 459 980 Product version from 6/1/2024  
mm [inches]  
1:10

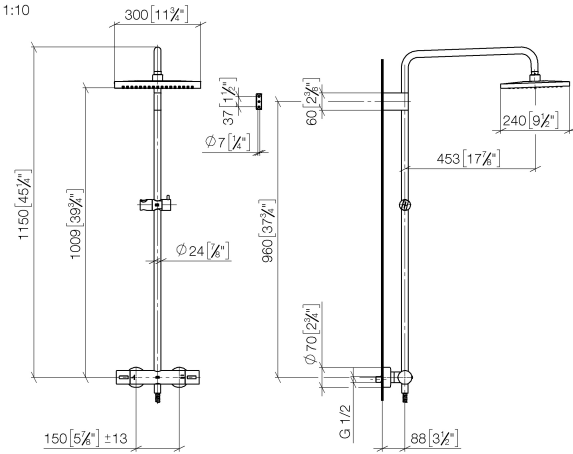

Flow rate chart

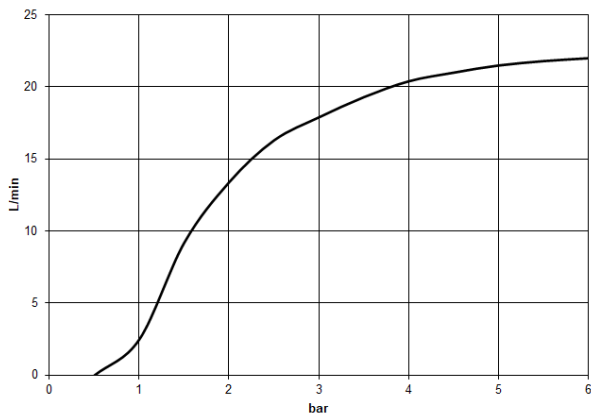

Codes & Standards

DIN 4109

EN 1717

ISO 3822

Scottish Water  
Byelaws

UK Water Supply  
Regulations

Ü-Zeichen



## Showerpipe with shower thermostat without hand shower - Brushed Durabrass (23kt Gold)

---

34 459 980 Product version from 6/1/2024

### Certificates

---

Belgaqua\_21-032-2 WRAS\_2204

LGA\_38



## Showerpipe with shower thermostat without hand shower - Brushed Durabronz (23kt Gold)

34 459 980 Product version from 6/1/2024

Parts for other  
finishes can be found  
here: [Chrome](#)

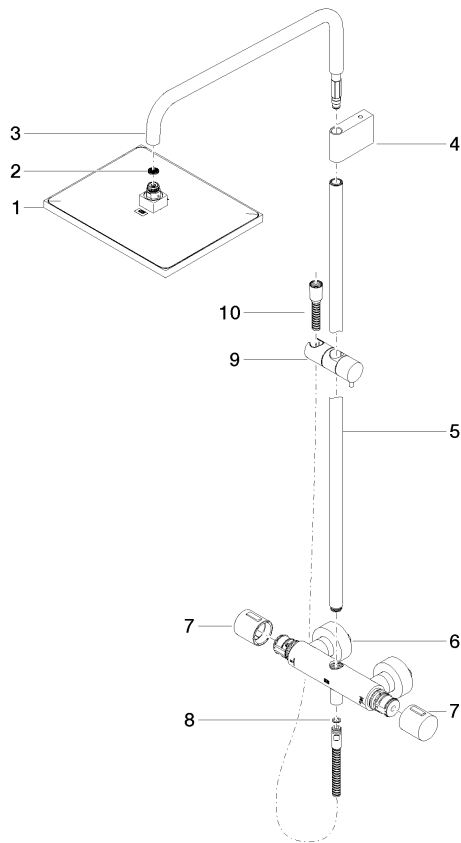

### Spare parts list

| No. | Item Number        | Name  | Quantity used | Delivery time |
|-----|--------------------|---|---------------|---------------|
| 1   | 04 12 05 063 00-28 | shower  | 1             | 20            |
| 2   | 09 23 01 039 90    | sieve   | 1             | 2             |
| 3   | 90 28 22 348 00-28 | pipe  | 1             | 20            |
| 4   | 90 17 11 150 00-28 | holder  | 1             | 20            |
| 5   | 90 28 22 349 00-28 | pipe  | 1             | 20            |
| 6   | 04 17 01 250 00-28 | connection  | 1             | 20            |
| 7   | 90 17 33 015 00-28 | handle  | 2             | 20            |
| 8   | 90 14 20 026 00 90 | seal  | 1             | 2             |
| 9   | 12 570 970-28      | Slide unit - Brushed Durabronz (23kt Gold)                              | 1             | 20            |
| 10  | 28 322 970-28      | Metal shower hose 1/2" x 3/8" x 1750 mm - Brushed Durabronz (23kt Gold) | 1             | 20            |