

## VAIA Shower pipe with shower thermostat without hand shower - Brushed Platinum

VAIA

34 460 809 Product version from 4/1/2025



- shower with fixed riser projection 452mm
- overhead shower: rain flow
- rain shower Ø 300 mm
- rain shower with anti-scale system
- max. rainshower flow 14 l/min
- Function from: 10 l/min
- rotary diverter with volume control and shut-off function
- slide-on rosettes Ø 70 mm
- height of fittings up to rain shower (bottom edge) 964mm
- height of fittings up to top edge of elbow 1267mm
- gauge 150 mm - 13 mm
- metal shower hose 1750mm with integrated anti-twist protection
- 1/2" connection
- slide bar
- Pipe diameter 23.5 mm

This article does not include a hand shower!

Intrinsic protection against back flow.

|  |                                |               |
|--|--------------------------------|---------------|
|   | Brushed Platinum               | 34 460 809-06 |
|   | Chrome                         | 34 460 809-00 |
|   | Platinum                       | 34 460 809-08 |
|   | Dark Chrome                    | 34 460 809-19 |
|   | Brushed Durabronze (23kt Gold) | 34 460 809-28 |
|   | Brushed Dark Brass             | 34 460 809-39 |
|   | Brushed Bronze                 | 34 460 809-42 |
|   | Brushed Champagne (22kt Gold)  | 34 460 809-46 |
|   | Champagne (22kt Gold)          | 34 460 809-47 |
|  | Brushed Dark Platinum          | 34 460 809-99 |

# VAIA Shower pipe with shower thermostat without hand shower - Brushed Platinum

VAIA

34 460 809 Product version from 4/1/2025

mm [inches]

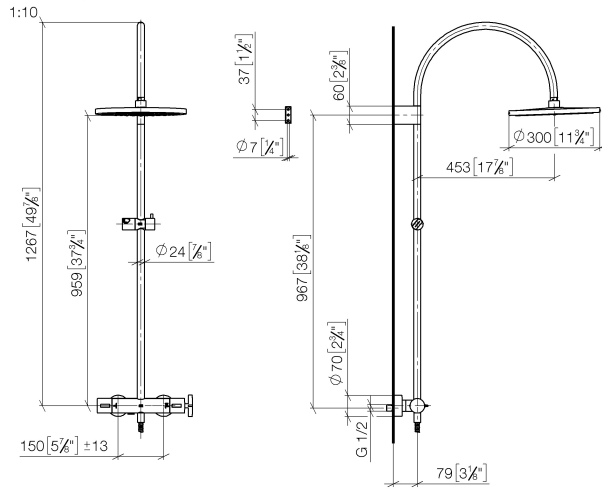

Flow rate chart



## Codes & Standards

DIN 4109

EN 1717

ISO 3822

Ü-Zeichen



## VAIA Shower pipe with shower thermostat without hand shower - Brushed Platinum

VAIA

---

34 460 809 Product version from 4/1/2025

Certificates and sustainability

---

Belgaqua\_24-006-2 LGA\_38

## VAIA Shower pipe with shower thermostat without hand shower - Brushed Platinum

VAIA

34 460 809 Product version from 4/1/2025

Parts for other  
finishes can be found  
here: [Chrome](#)



### Spare parts list

| No. | Item Number        | Name   | Quantity used | Delivery time |
|-----|--------------------|--|---------------|---------------|
| 1   | 04 12 05 091 00-06 | shower   | 1.00          | 10            |
| 6   | 12 570 970-06      | Slide unit - Brushed Platinum                              | 1.00          | 10            |
| 9   | 90 17 33 015 00-06 | handle   | 1.00          | 10            |
| 10  | 90 14 20 026 00 90 | seal   | 1.00          | 2             |
| 3   | 09 14 10 008 90    | seal   | 1.00          | 2             |
| 11  | 90 17 33 030 00-06 | handle   | 1.00          | 10            |
| 4   | 90 17 11 150 00-06 | holder   | 1.00          | 10            |
| 7   | 90 28 22 349 00-06 | pipe   | 1.00          | 10            |
| 2   | 04 28 22 346 00-06 | pipe   | 1.00          | 10            |
| 5   | 28 322 970-06      | Metal shower hose 1/2" x 3/8" x 1750 mm - Brushed Platinum | 1.00          | 2             |
| 8   | 04 17 01 250 00-06 | connection   | 1.00          | 10            |