

35 944 970 90



- stainless steel
- 2x 1/2" connection angle
- gauge 150 mm
- 2x anti-water packing
- 2x dust cover
- soundproofing
- WRAS

Concealed floor mounting -

SERIES-VARIOUS

35 944 970 90

mm [inches]

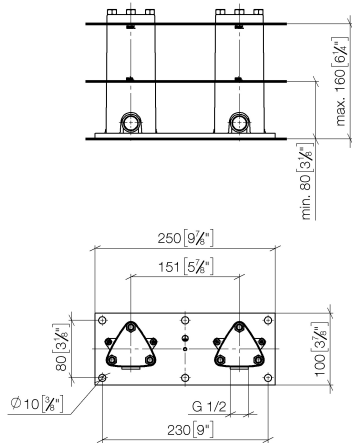

Codes & Standards

Scottish Water Byelaws

UK Water Supply Regulations

Certificates and sustainability

WRAS_1911

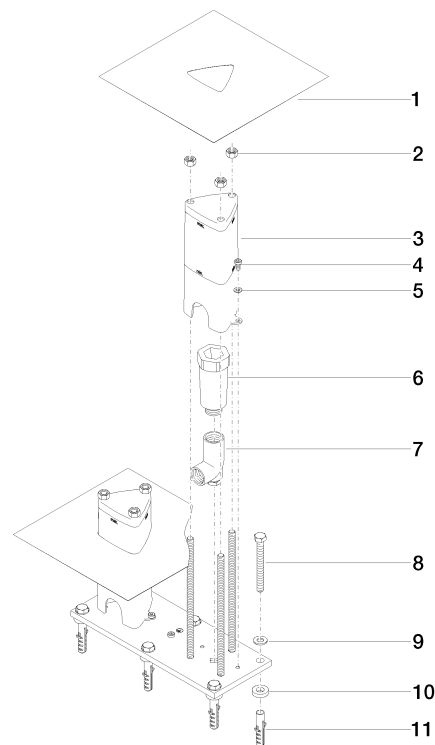

Spare parts list

No.	Item Number	Name	Quantity used	Delivery time
	10 09 14 05 052 90	seal	6.00	60
	4 09 30 30 085 90	screw	5.00	60
	8 09 30 31 012 90	screw	6.00	2
	6 09 31 20 011 90	plug	2.00	2
	3 09 21 02 127 90	cap	2.00	-
Spare part can no longer be ordered, please order the replacement item				
	7 09 24 02 090 90	nipple	2.00	2
	1 09 14 03 110 90	seal	2.00	2
	5 09 30 11 048 90	disc	5.00	2
	9 09 30 11 045 90	disc	6.00	2
	11 09 30 35 003 90	plug	6.00	2
	2 09 23 10 023 90	nut	3.00	2