

MEM Concealed two-way diverter - Brushed Champagne (22kt Gold)
MEM

36 200 782
Product version from 4/1/2022



- rotary diverter
- rosette 60 x 60 mm
- WRAS

	Brushed Champagne (22kt Gold)	36 200 782-46
	Chrome	36 200 782-00
	Brushed Platinum	36 200 782-06
	Platinum	36 200 782-08
	Dark Chrome	36 200 782-19
	Brushed Durabronze (23kt Gold)	36 200 782-28
	Champagne (22kt Gold)	36 200 782-47
	Brushed Dark Platinum	36 200 782-99

Required miscellaneous

	Concealed two-way diverter - •max. recess depth 160 mm •min. recess depth 115 mm	35 202 970 90
---	--	---------------

36 200 782 Product version from 4/1/2022

mm [inches]

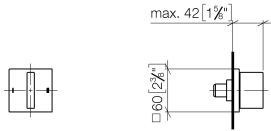

Flow rate chart

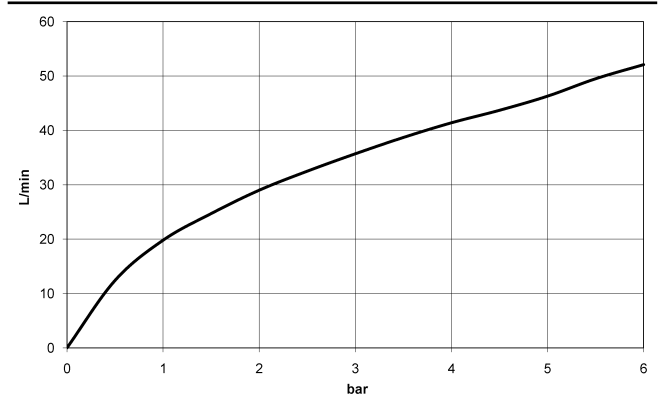

Codes & Standards

DIN 4109	ISO 3822	Scottish Water Byelaws	UK Water Supply Regulations
----------	----------	------------------------	-----------------------------

Ü-Zeichen



MEM Concealed two-way diverter - Brushed Champagne (22kt Gold)

MEM

36 200 782 Product version from 4/1/2022

Certificates and sustainability

LGA_38

WRAS_2307

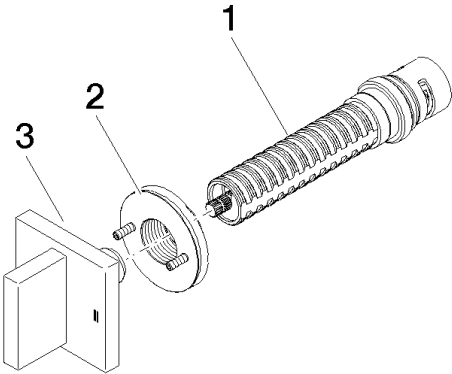

Spare parts list

No.	Item Number	Name	Quantity used	Delivery time
1	90 90 03 304 10 90	diverter	1.00	2
3	90 20 78 002 08-46	handle	1.00	30
2	90 21 02 181 00 90	disc	1.00	2