





CL.1 Wall valve anti-clockwise closing hot 1/2" - Chrome

CL.1

36 607 707    Product version up to 10/14/2020



- rosette 60 x 60 mm
- with hot marking
- head part with cut-to-length spindle and sleeve
- WRAS

	Chrome	36 607 707-00
	Brushed Platinum	36 607 707-06
	Dark Chrome	36 607 707-19
	Brushed Champagne (22kt Gold)	36 607 707-46
	Champagne (22kt Gold)	36 607 707-47
	Brushed Dark Platinum	36 607 707-99

Required miscellaneous

	<div> <div>Wall valve 1/2" -</div> <div> <div>•max. recess depth 150 mm</div> <div>•min. recess depth 105 mm</div> </div> </div>	35 607 970 90
---	--	---------------

CL.1 Wall valve anti-clockwise closing hot 1/2" - Chrome

CL.1

36 607 707    Product version up to 10/14/2020

mm [inches]



Codes & Standards			
ASME A112.18.1	cUPC	DIN 4109	EN 200
ISO 3822	Scottish Water Byelaws	UK Water Supply Regulations	Ü-Zeichen

Certificates and sustainability				
DVGW_DW-6501DN0	LGA_29	WRAS_2010	LGA_29	IAPMO_4976 (

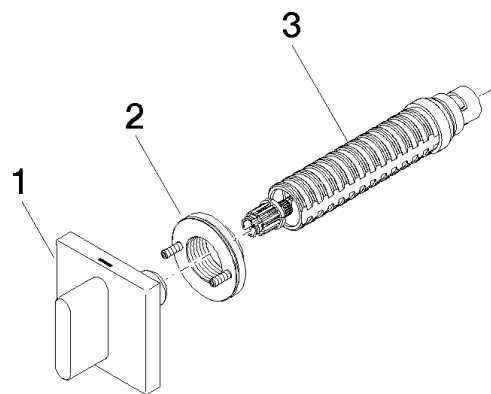

Spare parts list

No.	Item Number	Name	Quantity used	Delivery time
1	90 20 70 051 03-00	handle ( hot )	1.00	10
2	90 21 02 108 00 90	disc	1.00	2
3	90 90 03 142 00 90	top	1.00	2