

## Wall valve anti-clockwise closing hot 1/2" - Chrome

---

36 607 717 Product version from 10/14/2020



- rosette 60 x 60 mm
- with hot marking
- head part with cut-to-length spindle and sleeve
- WRAS

### Required miscellaneous

---



#### Wall valve 1/2" -

35 607 970 90

- max. recess depth mm
- min. recess depth mm



Wall valve anti-clockwise closing hot 1/2" - Chrome

36 607 717    Product version from 10/14/2020

mm [inches]

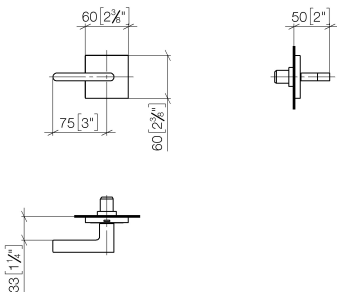

Codes & Standards

|                |                        |                             |           |
|----------------|------------------------|-----------------------------|-----------|
| ASME A112.18.1 | cUPC                   | DIN 4109                    | EN 200    |
| ISO 3822       | Scottish Water Byelaws | UK Water Supply Regulations | Ü-Zeichen |

Certificates

|                 |        |           |        |              |
|-----------------|--------|-----------|--------|--------------|
| DVGW_DW-6501DN0 | LGA_29 | WRAS_2010 | LGA_29 | IAPMO_4976 ( |
|-----------------|--------|-----------|--------|--------------|

# Wall valve anti-clockwise closing hot 1/2" - Chrome

36 607 717    Product version from 10/14/2020

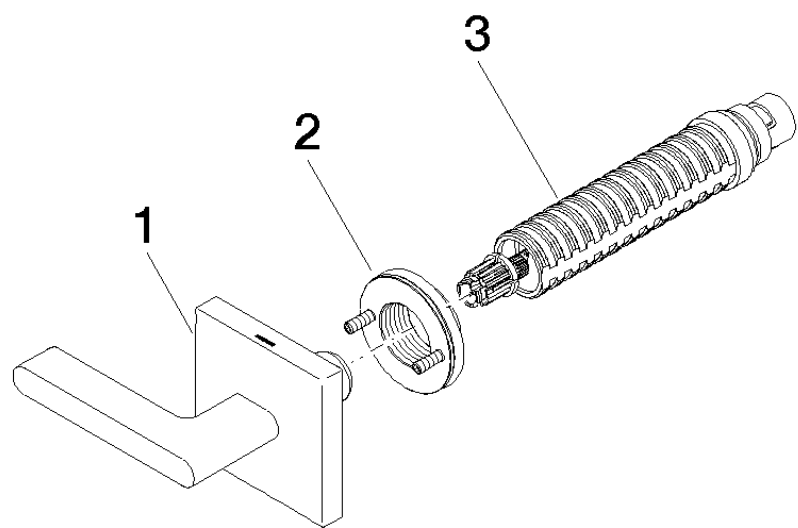

## Spare parts list

| No. | Item Number        | Name           | Quantity used | Delivery time |
|-----|--------------------|----------------|---------------|---------------|
| 1   | 90 20 70 057 05-00 | handle ( hot ) | 1             | 10            |
| 2   | 90 21 02 108 00 90 | disc           | 1             | 2             |
| 3   | 90 90 03 142 00 90 | top            | 1             | 2             |