

CYO Two-hole basin mixer without pop-up waste - Platinum / Brushed Platinum

CYO

ST 010 108 5811



- 133mm projection
- fixed spout
- rectangular, air-enriched flow
- height of mixer 180 mm
- height up to aerator 128 mm
- hole diameter spout 35 mm
- hole diameter valve 32 mm
- handle Ø 60mm
- 2x screw-in M 8 x 1 pressure hose, leak-tested
- 1x screw-in M 10 x 1 pressure hose, leak-tested
- max. flow 4.5 l/min
- progressive cartridge
- lead-free
- with hot / cold marking
- This product can help a building meet the requirements of Green Building Rating Systems, e.g. LEED®, BREEAM®, DGNB

	Platinum / Brushed Platinum	ST 010 108 5811-36
	Chrome	ST 010 108 5811-00
	Brushed Platinum	ST 010 108 5811-06
	Dark Chrome	ST 010 108 5811-19
	Brushed Durabron (23kt Gold)	ST 010 108 5811-28
	Durabron / Brushed Durabron (23kt Gold)	ST 010 108 5811-38
	Brushed Dark Platinum	ST 010 108 5811-99

Individual components of this set

You need the following components for this set

1x 11 188 811-06



1x 29 217 811-36









CYO Two-hole basin mixer without pop-up waste - Platinum / Brushed Platinum

CYO

ST 010 108 5811

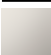

- with hot / cold marking
- for two-hole basin mixer

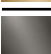
	Brushed Platinum	11 188 811-0
	Chrome	11 188 811-0
	Platinum	11 188 811-0
	Durabrand (23kt Gold)	11 188 811-0
	Dark Chrome	11 188 811-1
	Brushed Durabrand (23kt Gold)	11 188 811-2
	Brushed Dark Platinum	11 188 811-9



CYO Two-hole basin mixer without pop-up waste - Platinum / Brushed Platinum

CYO

ST 010 108 5811

6  
—  
0  
—  
8  
—  
9  
—  
9  
—  
8  
—  
9  
—

ST 010 108 5811

mm [inches]

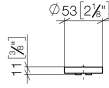



Parts for other  
finishes can be found  
here: [Chrome](#)

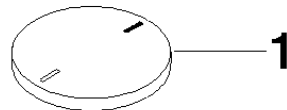

**Spare parts list**



- 133mm projection
- fixed spout
- rectangular, air-enriched flow
- height of mixer 180 mm
- height up to aerator 128 mm
- hole diameter spout 35 mm
- hole diameter valve 32 mm
- handle Ø 60mm
- 2x screw-in M 8 x 1 pressure hose, leak-tested
- 1x screw-in M 10 x 1 pressure hose, leak-tested
- max. flow 4.5 l/min
- progressive cartridge
- lead-free
- This product can help a building meet the requirements of Green Building Rating Systems, e.g. LEED®, BREEAM®, DGNB
- WRAS 2201012

NOTE: The handle inserts must be ordered separately from the fittings!

	Platinum / Brushed Platinum	29 217 811-3
	Chrome	29 217 811-0
	Brushed Platinum	29 217 811-0
	Dark Chrome	29 217 811-1
	Brushed Durabronze (23kt Gold)	29 217 811-2
	Durabronze / Brushed Durabronze (23kt Gold)	29 217 811-3
	Brushed Dark Platinum	29 217 811-9



CYO Two-hole basin mixer without pop-up waste - Platinum / Brushed Platinum

CYO

ST 010 108 5811

6  
—  
10  
—  
16  
—  
9  
—  
8  
—  
8  
—  
19  
—



ST 010 108 5811

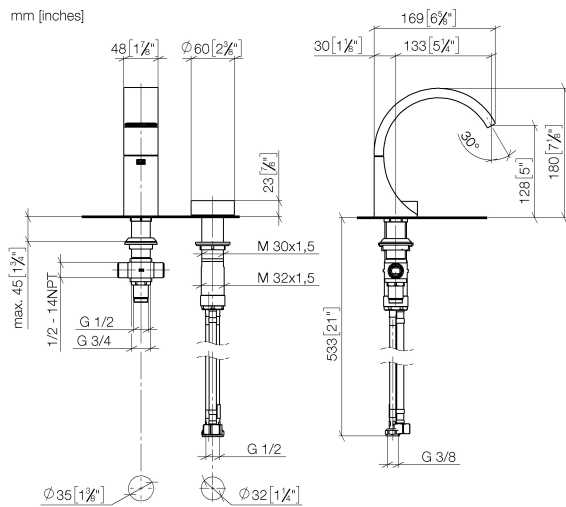

**Flow rate chart**

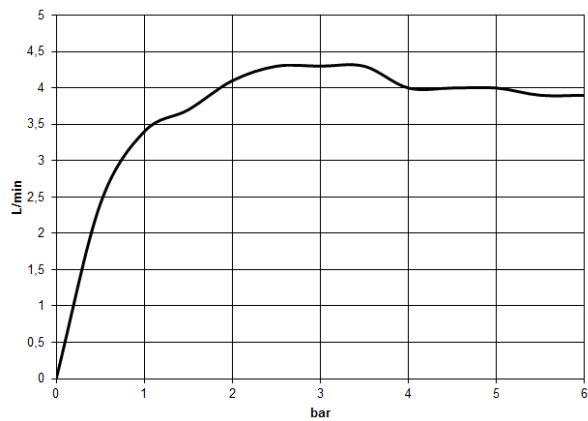

**Certificates**

LGA\_38

WRAS\_2201



CYO Two-hole basin mixer without pop-up waste - Platinum / Brushed Platinum

CYO

ST 010 108 5811

Codes & Standards

DIN 4109	ISO 3822	Scottish Water Byelaws	UK Water Supply Regulations
----------	----------	---------------------------	--------------------------------

Ü-Zeichen



Parts for other  
finishes can be found  
here: [Chrome](#)

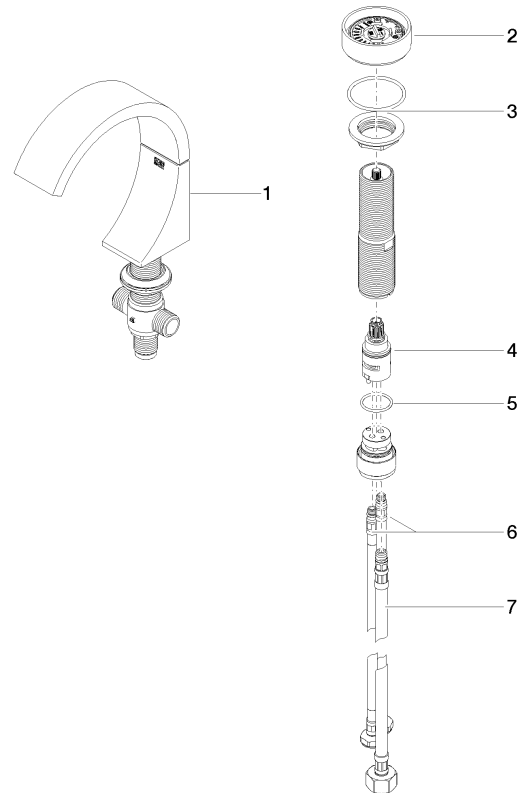



CYO Two-hole basin mixer without pop-up waste - Platinum / Brushed Platinum

CYO

ST 010 108 5811

Spare parts list

No.	Item Number	Name	Quantity used	Delivery time
	13 715 811-36	CYO Deck-mounted basin spout without pop-up waste - Platinum / Brushed Platinum	8	20