

CYO Two-hole basin mixer without pop-up waste - Dark Chrome

CYO

ST 010 108 7811



- 167mm projection
- fixed spout
- rectangular, air-enriched flow
- height of mixer 198 mm
- height up to aerator 133 mm
- hole diameter spout 35 mm
- hole diameter valve 32 mm
- handle Ø 60mm
- 2x screw-in M 8 x 1 pressure hose, leak-tested
- 1x screw-in M 10 x 1 pressure hose, leak-tested
- max. flow 4.5 l/min
- progressive cartridge
- lead-free
- with hot / cold marking
- This product can help a building meet the requirements of Green Building Rating Systems, e.g. LEED®, BREEAM®, DGNB

	Dark Chrome	ST 010 108 7811-19
	Chrome	ST 010 108 7811-00
	Brushed Platinum	ST 010 108 7811-06
	Brushed Durabronze (23kt Gold)	ST 010 108 7811-28
	Platinum / Brushed Platinum	ST 010 108 7811-36
	Durabronze / Brushed Durabronze (23kt Gold)	ST 010 108 7811-38
	Brushed Dark Platinum	ST 010 108 7811-99

Individual components of this set

You need the following components for this set

1x 29 218 811-19



1x 11 188 811-19



CYO Two-hole basin mixer without pop-up waste - Dark Chrome







CYO

ST 010 108 7811

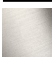

- 167mm projection
- fixed spout
- rectangular, air-enriched flow
- height of mixer 198 mm
- height up to aerator 133 mm
- hole diameter spout 35 mm
- hole diameter valve 32 mm
- handle Ø 60mm
- 2x screw-in M 8 x 1 pressure hose, leak-tested
- 1x screw-in M 10 x 1 pressure hose, leak-tested
- max. flow 4.5 l/min
- progressive cartridge
- lead-free
- This product can help a building meet the requirements of Green Building Rating Systems, e.g. LEED®, BREEAM®, DGNB
- WRAS 2201012

NOTE: The handle inserts must be ordered separately from the fittings!

	Dark Chrome	29 218 811-1
	Chrome	29 218 811-0
	Brushed Platinum	29 218 811-0
	Brushed Durabronze (23kt Gold)	29 218 811-2
	Platinum / Brushed Platinum	29 218 811-3
	Durabronze / Brushed Durabronze (23kt Gold)	29 218 811-3
	Brushed Dark Platinum	29 218 811-9



CYO Two-hole basin mixer without pop-up waste - Dark Chrome

CYO

ST 010 108 7811

9
—
0
—
6
—
8
—
6
—
8
—
9
—

ST 010 108 7811

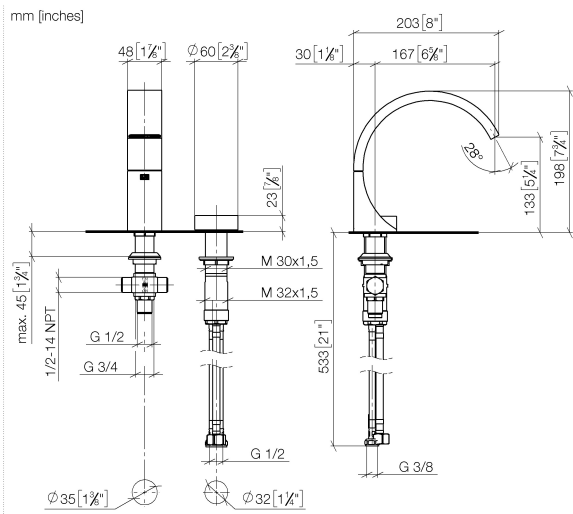

Flow rate chart

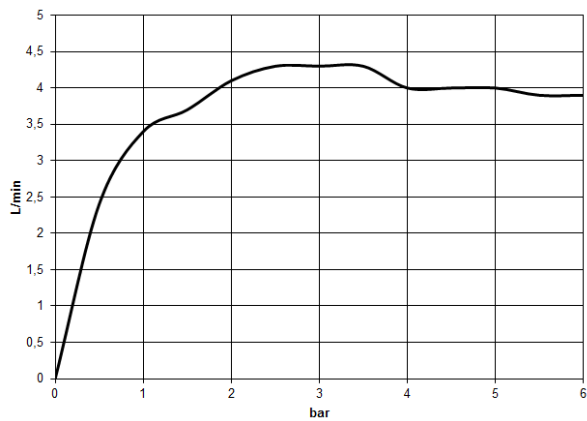



CYO Two-hole basin mixer without pop-up waste - Dark Chrome

CYO

ST 010 108 7811

Parts for other
finishes can be found
here: [Chrome](#)

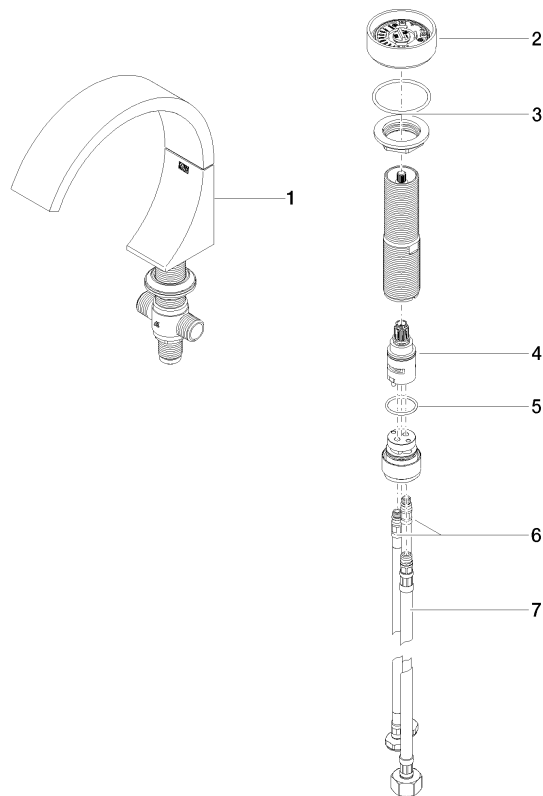



CYO Two-hole basin mixer without pop-up waste - Dark Chrome

CYO

ST 010 108 7811

Spare parts list

No.	Item Number	Name	Quantity used	Delivery time
	13 717 811-19	CYO Deck-mounted basin spout without pop-up waste - Dark Chrome	8	20







CYO Two-hole basin mixer without pop-up waste - Dark Chrome

CYO

ST 010 108 7811

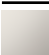

- with hot / cold marking
- for two-hole basin mixer

	Dark Chrome	11 188 811-1
	Chrome	11 188 811-0
	Brushed Platinum	11 188 811-0
	Platinum	11 188 811-0
	Durabass (23kt Gold)	11 188 811-0
	Brushed Durabass (23kt Gold)	11 188 811-2
	Brushed Dark Platinum	11 188 811-9



CYO Two-hole basin mixer without pop-up waste - Dark Chrome

CYO

ST 010 108 7811

9
—
0
—
6
—
8
—
9
—
8
—
9
—

ST 010 108 7811

mm [inches]

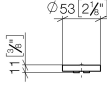



CYO Two-hole basin mixer without pop-up waste - Dark Chrome

CYO

ST 010 108 7811

Parts for other
finishes can be found
here: [Chrome](#)

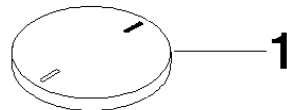

Spare parts list