

# VAIA Two-hole bridge mixer with rinsing spray set - Chrome

VAIA

ST 110 202 3809



- 241mm projection
- pivotable spout 360°
- air-enriched flow and spray flow
- fabric braided hose 1500 mm
- automatic spout/shower diverter
- sprayface with anti-scaling system
- max. flow 7 l/min at 3 bar flow pressure
- lead-free
- This product can help a building meet the requirements of Green Building Rating Systems, e.g. LEED®, BREEAM®, DGNB

	Chrome	ST 110 202 3809-00
	Brushed Platinum	ST 110 202 3809-06
	Platinum	ST 110 202 3809-08
	Durabrass (23kt Gold)	ST 110 202 3809-09
	Dark Chrome	ST 110 202 3809-19
	Brushed Durabrass (23kt Gold)	ST 110 202 3809-28
	Matte Black	ST 110 202 3809-33
	Brushed Champagne (22kt Gold)	ST 110 202 3809-46
	Champagne (22kt Gold)	ST 110 202 3809-47
	Brushed Chrome	ST 110 202 3809-93
	Brushed Dark Platinum	ST 110 202 3809-99

## Individual components of this set

You need the following components for this set



1x 19 825 809-00



1x 27 718 809-00

# VAIA Two-hole bridge mixer with rinsing spray set - Chrome

VAIA

ST 110 202 3809



- 241mm projection
- pivotable spout 360°
- air-enriched flow
- max. flow 7 l/min at 3 bar flow pressure
- lead-free
- This product can help a building meet the requirements of Green Building Rating Systems, e.g. LEED®, BREEAM®, DGNB

	Chrome	19 825 809-0
	Brushed Platinum	19 825 809-0
	Platinum	19 825 809-0
	Durabrand (23kt Gold)	19 825 809-0
	Dark Chrome	19 825 809-1
	Brushed Durabrand (23kt Gold)	19 825 809-2
	Matte Black	19 825 809-3
	Brushed Champagne (22kt Gold)	19 825 809-4
	Champagne (22kt Gold)	19 825 809-4
	Brushed Chrome	19 825 809-9
	Brushed Dark Platinum	19 825 809-9



VAIA Two-hole bridge mixer with rinsing spray set - Chrome

VAIA

ST 110 202 3809

0  
—  
6  
—  
8  
—  
9  
—  
9  
—  
8  
—  
3  
—  
6  
—  
7  
—  
3  
—  
9  
—

Recommended miscellaneous

VAIA Dispenser with rosette - Chrome 82 434 809-00



mm [inches]

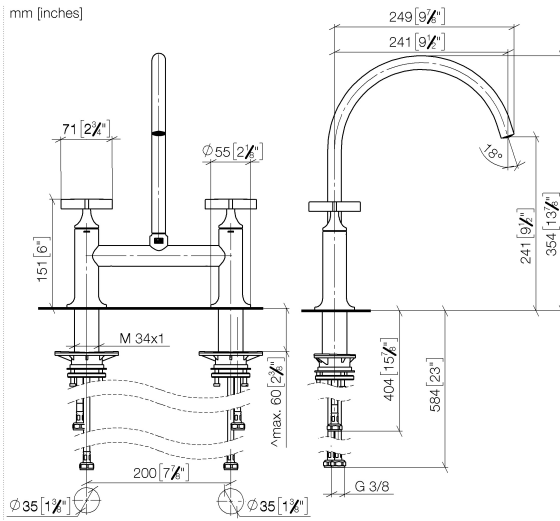

The graph shows the relationship between Laminar velocity (Lamin) and pressure (bar) for a 1000 µm capillary. The velocity increases with pressure, following a curve that starts at the origin (0,0) and levels off as pressure increases. The data points are approximately as follows:

Pressure (bar)	Laminar velocity (Lamin)
0	0
1	3.5
2	5.2
3	6.2
4	6.8
5	7.2
6	7.4
7	7.5

Codes & Standards

DIN 4109

ISO 3822

Ü-Zeichen



**Product version from 7/1/2023**

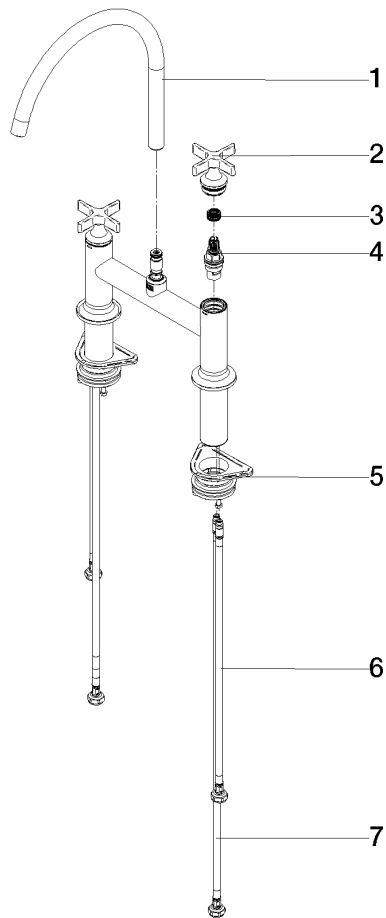



VAIA Two-hole bridge mixer with rinsing spray set - Chrome

VAIA

ST 110 202 3809

Spare parts list

Product version from 7/1/2023

No.	Item Number	Name	Quantity used	Delivery time
	90 28 22 396 00-00	spout	13	10



## VAIA Two-hole bridge mixer with rinsing spray set - Chrome

VAIA

ST 110 202 3809



- with round rosette
- spray flow
- automatic spout/shower diverter
- height of mixer 171 mm
- hole diameter rinsing spray 32mm
- fabric braided hose 1500 mm
- sprayface with anti-scaling system
- lead-free
- This product can help a building meet the requirements of Green Building Rating Systems, e.g. LEED®, BREEAM®, DGNB

Can only be combined with 33810809, 33826809, 19815809, 19825809.

Intrinsic protection against back flow.

Residual water may emerge from the spray after closing.

Operating unit can be positioned freely.

	Chrome	27 718 809-0
	Brushed Platinum	27 718 809-0
	Platinum	27 718 809-0
	Durabrand (23kt Gold)	27 718 809-0
	Dark Chrome	27 718 809-1
	Brushed Durabrand (23kt Gold)	27 718 809-2
	Matte Black	27 718 809-3
	Brushed Champagne (22kt Gold)	27 718 809-4
	Champagne (22kt Gold)	27 718 809-4
	Brushed Chrome	27 718 809-9
	Brushed Dark Platinum	27 718 809-9

ST 110 202 3809

0  
—  
6  
—  
8  
—  
9  
—  
9  
—  
8  
—  
3  
—  
6  
—  
7  
—  
3  
—  
9  
—

ST 110 202 3809

mm [inches]



### Flow rate chart

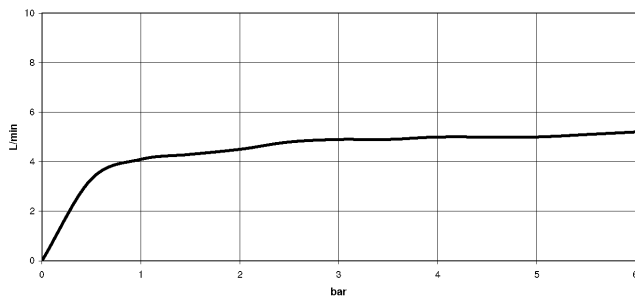

### Certificates

LGA\_38

Codes & Standards

DIN 4109

ISO 3822

Ü-Zeichen



**Product version from 7/1/2023**

Parts for other  
finishes can be found  
here: Brushed  
Platinum





VAIA Two-hole bridge mixer with rinsing spray set - Chrome

VAIA

ST 110 202 3809

**Spare parts list**

**Product version from 7/1/2023**

No.	Item Number	Name	Quantity used	Delivery time
	90 12 11 096 12-00	shower	8	60