

LOT HOT & COLD WATER DISPENSER - Brushed Dark Platinum

LOT

17 861 680 Product version from 4/1/2014 to 5/27/2021



- 145mm projection
- rigid, thermally insulated spout
- laminar flow
- height of mixer 233 mm
- height up to laminar flow regulator 213 mm
- hole diameter 35 mm
- provides filtered, hot water up to 93°C
- provides filtered, cold water
- max. flow 2 l/min at 3 bar flow pressure
- ready-to-use control unit for wall mounting (137mm x 159mm x 60mm)
- electronic magnetic valve
- 100-230 V, 50-60 Hz, 18 W power supply unit, incl. country-specific adapter set
- lead-free

• Spout ring cannot be removed.

• This product can help a building meet the requirements of Green Building Rating Systems, e.g. LEED®, BREEAM®, DGNB

A minimum flow pressure of 3 bar is necessary for the HOT & COLD WATER DISPENSER to work perfectly in conjunction with a hot water tank and filter.

The installation must be above a kitchen sink.

The filter cartridge must be changed every six months. The installation instructions contain further information for guidance.

Detailed planning information and technical data can be found at www.dornbracht.com/professional

A minimum flow pressure of 3 bar is necessary for the HOT & COLD WATER DISPENSER to work perfectly in conjunction with a hot water tank and filter.

The installation must be above a kitchen sink.

The filter cartridge must be changed every six months. The installation instructions contain further information for guidance.

Detailed planning information and technical data can be found at www.dornbracht.com/professional

	Brushed Dark Platinum	17 861 680-99
	Chrome	17 861 680-00
	Brushed Platinum	17 861 680-06
	Platinum	17 861 680-08
	Dark Chrome	17 861 680-19
	Brushed Durabronze (23kt Gold)	17 861 680-28
	Brushed Champagne (22kt Gold)	17 861 680-46
	Champagne (22kt Gold)	17 861 680-47

Required miscellaneous



Hot water tank incl. filter -

12 892 970 90

17 861 680 Product version from 4/1/2014 to 5/27/2021

mm [inches]

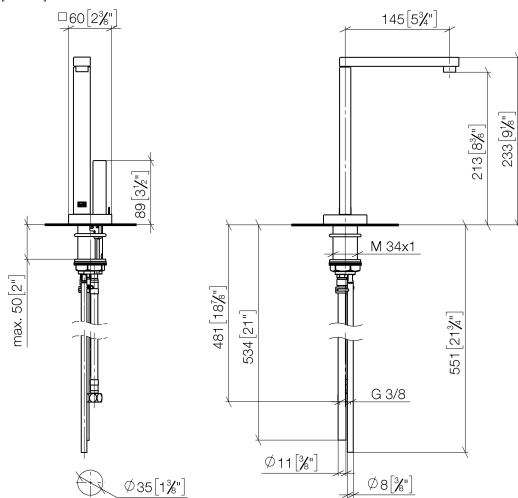

Flow rate chart



Codes & Standards

ASME A112.18.1	cUPC	DIN 4109	ISO 3822
NSF372	NSF61	Ü-Zeichen	



LOT HOT & COLD WATER DISPENSER - Brushed Dark Platinum

LOT

17 861 680 Product version from 4/1/2014 to 5/27/2021

Certificates and sustainability

IAPMO_N-4	IAPMO_4976	LGA_28	IAPMO_6
-----------	------------	--------	---------



Spare parts list

No.	Item Number	Name	Quantity used	Delivery time
	3 90 10 01 048 00 90	electronic accessories	1.00	2
	9 09 16 01 045 90	ring	1.00	2
	4 04 10 01 050 00 90	power supply	1.00	60
	1 90 17 85 100 03-99	fitting	1.00	20
	5 12 866 970 90	Adapter Flow restrictor HCWD 3/8" -	1.00	2
	8 09 24 04 293 90	nipple	1.00	2
	7 90 24 04 291 00 90	insert	1.00	2
	2 90 30 04 067 00 90	hose	1.00	2
	6 90 11 11 064 01 90	electronic accessories	1.00	2