

Deck valve clockwise closing cold - Brushed Platinum

CL.1

20 000 740



- hole diameter 32 mm
- handle Ø 60mm
- without rosette
- with cold marking
- WRAS 2103001

Fits: CL.1, CYO

	Brushed Platinum	20 000 740-06
	Chrome	20 000 740-00
	Platinum	20 000 740-08
	Dark Chrome	20 000 740-19
	Brushed Durabronze (23kt Gold)	20 000 740-28
	Matte Black	20 000 740-33
	Brushed Champagne (22kt Gold)	20 000 740-46
	Champagne (22kt Gold)	20 000 740-47
	Brushed Dark Platinum	20 000 740-99

20 000 740

mm [inches]

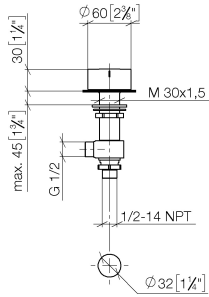

Flow rate chart

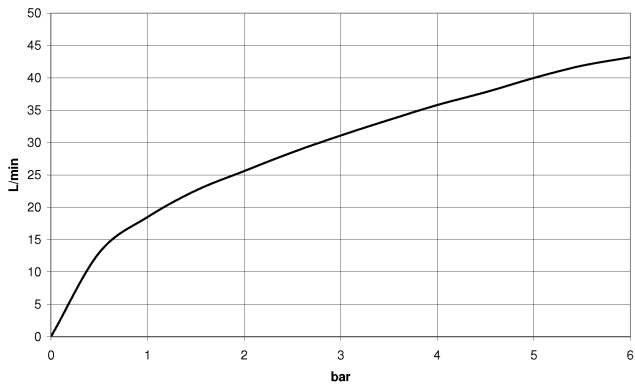

Codes & Standards

DIN 4109

ISO 3822

Scottish Water
Byelaws

UK Water Supply
Regulations

Ü-Zeichen



Deck valve clockwise closing cold - Brushed Platinum

CL.1

20 000 740

Certificates

WRAS_2103

LGA_28

20 000 740

Product version from 4/1/2023

Parts for other finishes can be found here: Chrome

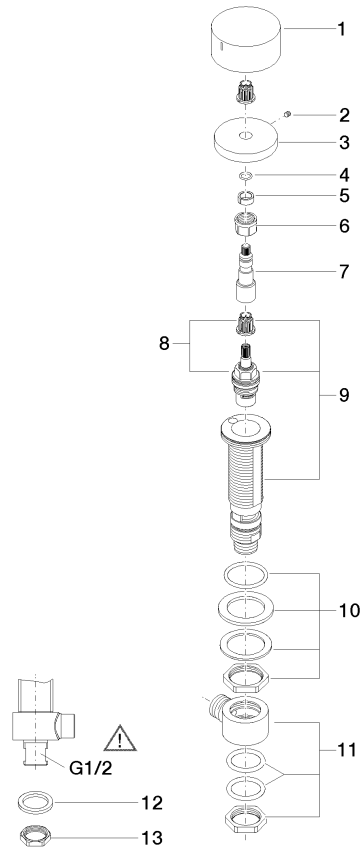



Deck valve clockwise closing cold - Brushed Platinum

CL.1

20 000 740

Spare parts list

Product version from 4/1/2023

No.	Item Number	Name	Quantity used	Delivery time
	09 20 74 005-06	handle (cold)	13	60