

MEM Deck valve anti-clockwise closing hot - Platinum

MEM

20 000 783



- hole diameter 32 mm
- rosette 60 x 60 mm
- with hot marking
- WRAS 2103001

	Platinum	20 000 783-08
	Chrome	20 000 783-00
	Brushed Platinum	20 000 783-06
	Dark Chrome	20 000 783-19
	Brushed Durabronze (23kt Gold)	20 000 783-28
	Brushed Champagne (22kt Gold)	20 000 783-46
	Champagne (22kt Gold)	20 000 783-47
	Brushed Dark Platinum	20 000 783-99

20 000 783

mm [inches]

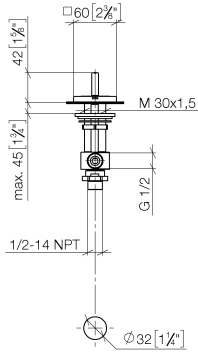

Flow rate chart

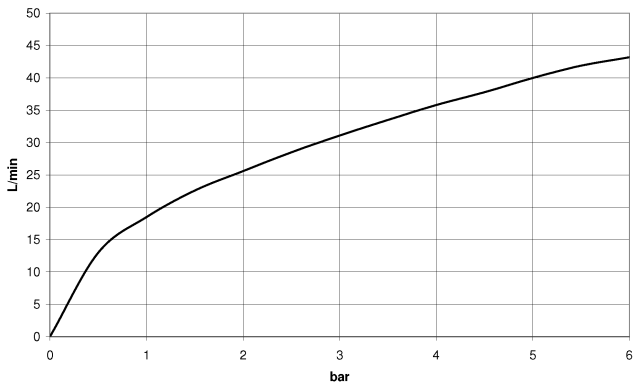

Codes & Standards

Scottish Water
Byelaws

UK Water Supply
Regulations



MEM Deck valve anti-clockwise closing hot - Platinum

MEM

20 000 783

Certificates

WRAS_2103

20 000 783

Product version from 3/10/2014

Parts for other finishes can be found here: Chrome

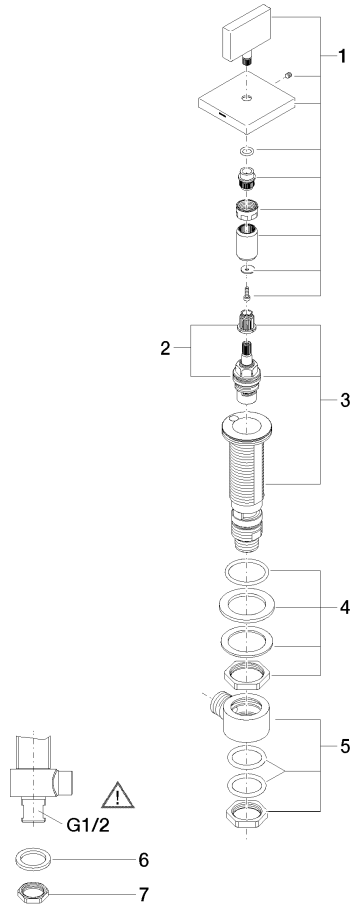



MEM Deck valve anti-clockwise closing hot - Platinum

MEM

20 000 783

Spare parts list

Product version from 3/10/2014

No.	Item Number	Name	Quantity used	Delivery time
	90 20 78 002 05-08	handle (hot)	7	40