

## MEM Three-hole basin mixer with pop-up waste - Brushed Dark Brass

MEM

20 713 782 Product version from 3/10/2014



- 165mm projection
- fixed spout
- rectangular, air-enriched flow
- height of mixer 277 mm
- height up to aerator 170 mm
- hole diameter spout 35 mm
- hole diameter valve 32 mm
- rosette 60 x 60 mm
- 2x screw-in M 10 x 1 pressure hose, leak-tested
- max. flow 8.3 l/min
- lead-free
- This product can help a building meet the requirements of Green Building Rating Systems, e.g. LEED®, BREEAM®, DGNB
- WRAS

Only suitable for basins with an overflow.

|   |                                |               |
|---|--------------------------------|---------------|
|  | Brushed Dark Brass             | 20 713 782-39 |
|  | Chrome                         | 20 713 782-00 |
|  | Brushed Platinum               | 20 713 782-06 |
|  | Platinum                       | 20 713 782-08 |
|  | Dark Chrome                    | 20 713 782-19 |
|  | Brushed Durabronze (23kt Gold) | 20 713 782-28 |
|  | Brushed Champagne (22kt Gold)  | 20 713 782-46 |
|  | Champagne (22kt Gold)          | 20 713 782-47 |
|  | Brushed Dark Platinum          | 20 713 782-99 |

20 713 782 Product version from 3/10/2014



### Flow rate chart



### Codes & Standards

|                           |                                |                             |            |
|---------------------------|--------------------------------|-----------------------------|------------|
| DIN 4109                  | EN 200                         | Executive Order<br>no. 1007 | ISO 3822   |
| Scottish Water<br>Byelaws | UK Water Supply<br>Regulations | Ü-Zeichen                   | VA-Zeichen |



MEM Three-hole basin mixer with pop-up waste - Brushed Dark Brass

MEM

20 713 782    Product version from 3/10/2014

Certificates and sustainability

|           |        |        |          |
|-----------|--------|--------|----------|
| WRAS_2306 | LGA_18 | ETA_18 | GDV_0400 |
|-----------|--------|--------|----------|

# MEM Three-hole basin mixer with pop-up waste - Brushed Dark Brass

MEM

20 713 782 Product version from 3/10/2014

Parts for other  
finishes can be found  
here: [Chrome](#)

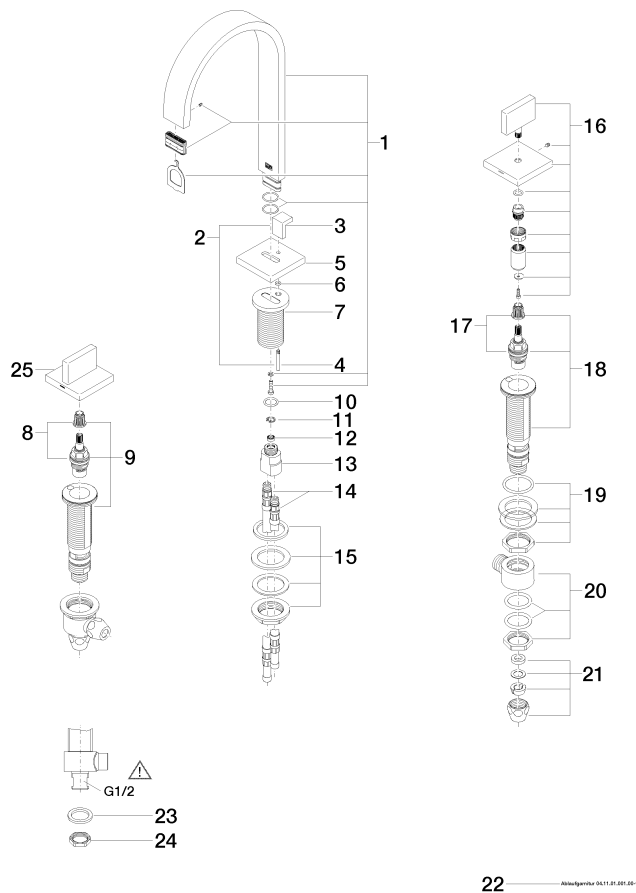

# MEM Three-hole basin mixer with pop-up waste - Brushed Dark Brass

MEM

20 713 782 Product version from 3/10/2014

## Spare parts list

| No.  | Item Number        | Name               | Quantity used | Delivery time |
|--|--------------------|--------------------|---------------|---------------|
| 17   | 90 90 03 153 00 90 | top                | 1.00          | 2             |
| 15   | 04 23 10 009 01 90 | fixing set         | 1.00          | 2             |
| 16   | 90 20 78 002 04-39 | handle ( cold )    | 1.00          | 30            |
| 18   | 04 17 11 058 53 90 | side panel         | 1.00          | 2             |
| 23   | 09 30 11 059 90    | disc               | 2.00          | 2             |
| 6  | 09 14 10 166 90    | seal               | 1.00          | 2             |
| 1  | 90 28 22 158 00-39 | spout              | 1.00          | 30            |
| 5  | 09 27 78 032-39    | rosette            | 1.00          | -             |
| Spare part can no longer be ordered, please order the replacement item |                    |                    |               |               |
| 24   | 09 23 10 012 90    | nut                | 2.00          | 2             |
| 19   | 04 23 10 032 78 90 | fixing set         | 2.00          | 2             |
| 10   | 09 14 10 130 90    | seal               | 1.00          | 2             |
| 3  | 09 20 78 030-39    | handle             | 1.00          | -             |
| Spare part can no longer be ordered, please order the replacement item |                    |                    |               |               |
| 11   | 09 16 01 016 90    | ring               | 1.00          | 2             |
| 22   | 90 11 01 001 00-39 | pop-up waste       | 1.00          | -             |
| Spare part can no longer be ordered, please order the replacement item |                    |                    |               |               |
| 8  | 90 90 03 152 00 90 | top                | 1.00          | 2             |
| 21   | 90 23 30 040 00-39 | threaded connector | 4.00          | 30            |
| 12   | 09 23 01 052 90    | flow reducer       | 1.00          | 2             |
| 25   | 90 20 78 002 05-39 | handle ( hot )     | 1.00          | 30            |
| 20   | 04 17 11 023 10 90 | distributor        | 2.00          | 2             |
| 7  | 09 11 10 054 10 90 | connection         | 1.00          | 2             |
| 4  | 09 31 09 080-39    | pull-rod           | 1.00          | 60            |
| 2  | 04 20 78 030 80-39 | pull-rod           | 1.00          | -             |
| Spare part can no longer be ordered, please order the replacement item |                    |                    |               |               |
| 13   | 09 11 10 055 10 90 | connection         | 1.00          | 2             |
| 9  | 04 17 11 058 52 90 | side panel         | 1.00          | 2             |
| 14   | 04 30 04 019 00 90 | hose               | 2.00          | 2             |