

**TARA Three-hole mixer - Brushed Durabrand (23kt Gold)**

TARA

20 816 892 Product version from 4/1/2024



- 235mm projection
- pivotable spout 360°
- air-enriched flow
- height of mixer 370 mm
- height up to aerator 212 mm
- hole diameter spout 35 mm
- hole diameter valve 32 mm
- max. flow 7 l/min at 3 bar flow pressure
- lead-free
- This product can help a building meet the requirements of Green Building Rating Systems, e.g. LEED®, BREEAM®, DGNB

|                                                                                     |                               |               |
|-------------------------------------------------------------------------------------|-------------------------------|---------------|
|    | Brushed Durabrand (23kt Gold) | 20 816 892-28 |
|    | Chrome                        | 20 816 892-00 |
|    | Brushed Platinum              | 20 816 892-06 |
|    | Platinum                      | 20 816 892-08 |
|    | Durabrand (23kt Gold)         | 20 816 892-09 |
|    | Dark Chrome                   | 20 816 892-19 |
|    | Matte Black                   | 20 816 892-33 |
|    | Brushed Bronze                | 20 816 892-42 |
|    | Brushed Champagne (22kt Gold) | 20 816 892-46 |
|   | Champagne (22kt Gold)         | 20 816 892-47 |
|  | Brushed Chrome                | 20 816 892-93 |
|  | Brushed Dark Platinum         | 20 816 892-99 |

**Recommended miscellaneous**

**Dispenser with rosette - Brushed Durabrand (23kt Gold)** 82 444 970-28



**Recommended miscellaneous**

**Strainer waste with control handle - Brushed Durabrand (23kt Gold)** 10 710 970-28



20 816 892 Product version from 4/1/2024



**Flow rate chart**



## Codes & Standards

DIN 4109

ISO 3822

Ü-Zeichen



## TARA Three-hole mixer - Brushed Durabron (23kt Gold)

---

TARA

20 816 892 Product version from 4/1/2024

Certificates and sustainability

---

LGA\_38

20 816 892 Product version from 4/1/2024

Parts for other  
finishes can be found  
here: [Chrome](#)

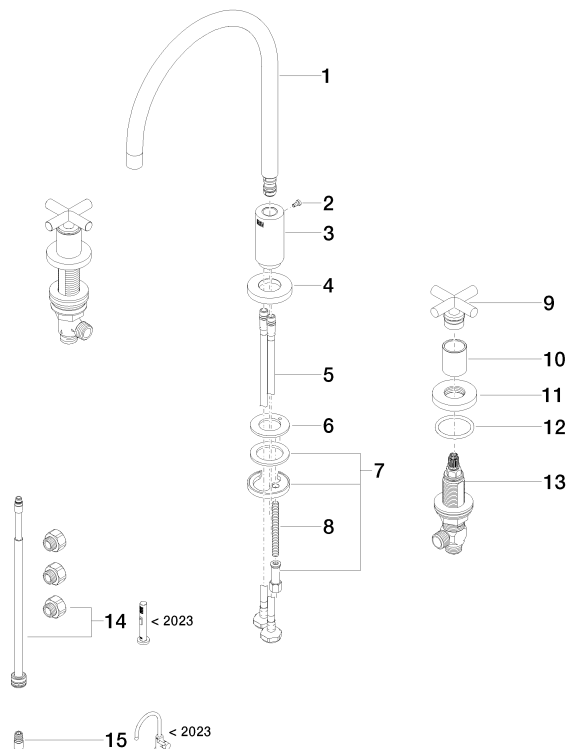

## Spare parts list

| No. | Item Number        | Name           | Quantity used | Delivery time |
|-----|--------------------|----------------|---------------|---------------|
| 9   | 90 20 89 010 10-28 | handle         | 2.00          | 20            |
| 7   | 04 30 11 038 00 90 | fixing set     | 1.00          | 2             |
| 13  | 90 17 11 040 51 90 | side panel     | 2.00          | 2             |
| 15  | 90 24 03 537 01 90 | adaptor        | 1.00          | 2             |
| 3   | 09 11 10 088 10-28 | connection     | 1.00          | 20            |
| 10  | 09 21 02 140-28    | sleeve         | 2.00          | 20            |
| 2   | 09 30 30 057 90    | screw          | 1.00          | 2             |
| 8   | 09 31 11 011 90    | pin            | 1.00          | 2             |
| 5   | 04 30 04 019 00 90 | hose           | 2.00          | 2             |
| 14  | 90 17 09 046 13 90 | conversion kit | 1.00          | 2             |
| 12  | 90 14 10 043 00 90 | seal           | 2.00          | 2             |
| 4   | 09 28 10 140-28    | ring           | 1.00          | 20            |
| 6   | 09 14 05 047 90    | seal           | 1.00          | 2             |
| 11  | 09 27 89 105-28    | rosette        | 2.00          | 20            |
| 1   | 90 28 22 226 01-28 | spout          | 1.00          | 20            |