



- spout: circular, air-enriched flow
- max. flow 21.5 l/min at 3 bar flow pressure
- Hand shower: COMPACT RAIN, max. flow rate 6.8 l/min (at 3 bar)
- complete hand shower set with anti-scale system
- 220mm projection
- automatic bath/shower diverter
- height of mixer 347 mm
- height up to aerator 244 mm
- hole diameter valve 32 mm
- hole diameter spout 32 mm
- hole diameter for complete hand shower set 32 mm
- rosette for complete hand shower set Ø 60mm
- rosette for spout Ø 60mm
- rosette for deck valve Ø 60mm
- metal shower hose 1750mm with integrated anti-twist protection
- WRAS

Intrinsic protection against back flow.

|   |                                |               |
|---|--------------------------------|---------------|
|    | Brushed Dark Brass             | 27 522 809-39 |
|    | Chrome                         | 27 522 809-00 |
|    | Brushed Platinum               | 27 522 809-06 |
|    | Platinum                       | 27 522 809-08 |
|    | Dark Chrome                    | 27 522 809-19 |
|    | Brushed Durabronze (23kt Gold) | 27 522 809-28 |
|    | Brushed Bronze                 | 27 522 809-42 |
|    | Brushed Champagne (22kt Gold)  | 27 522 809-46 |
|    | Champagne (22kt Gold)          | 27 522 809-47 |
|  | Brushed Dark Platinum          | 27 522 809-99 |

27 522 809 Product version from 3/13/2017

mm [inches]  
M 1:10

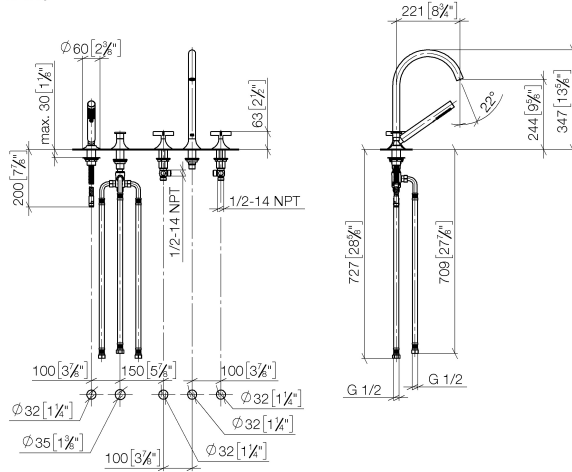

### Flow rate chart

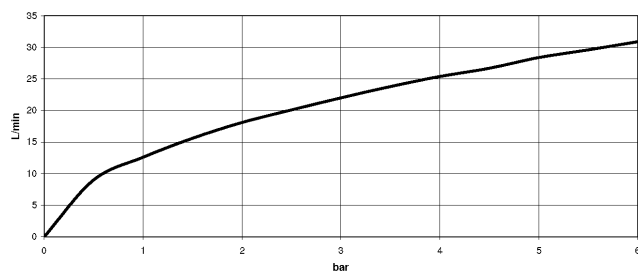

### Codes & Standards

DIN 4109

EN 1717

Executive Order  
no. 1007

ISO 3822

### Ü-Zeichen



## VAIA Five-hole bath mixer for deck mounting with diverter - Brushed Dark Brass

---

VAIA

27 522 809 Product version from 3/13/2017

### Certificates and sustainability

---

Belgaqua\_22\_278\_2 WRAS\_2310

LGA\_29

Parts for other  
finishes can be found  
here: [Chrome](#)

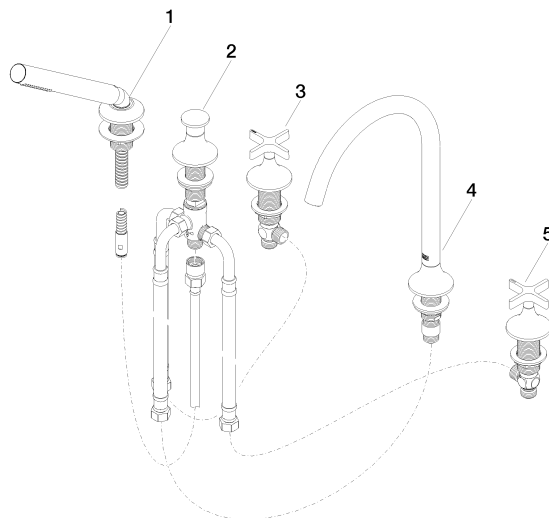

## Spare parts list

| No.  | Item Number   | Name   | Quantity used | Delivery time |
|--|---------------|--|---------------|---------------|
| 5  | 20 000 809-39 | handle ( cold )  | 1.00          | -             |
| Spare part can no longer be ordered, please order the replacement item |               |  |               |               |
| 4  | 13 612 809-39 | spout  | 1.00          | -             |
| Spare part can no longer be ordered, please order the replacement item |               |  |               |               |
| 1  | 27 702 809-39 | VAIA Hand shower set for bath rim or tile edge<br>installation - Brushed Dark Brass  | 1.00          | 30            |
| 2  | 29 140 809-39 | VAIA Two-way diverter for bath rim or tile edge<br>installation - Brushed Dark Brass | 1.00          | 30            |
| 3  | 20 000 808-39 | handle ( hot )   | 1.00          | -             |
| Spare part can no longer be ordered, please order the replacement item |               |  |               |               |