

## Hand shower set with individual rosettes - Brushed Dark Platinum

SERIES SPECIFIC

27 808 980 Product version up to 6/3/2020



- COMPACT RAIN, max. flow rate 15 l/min (at 3 bar)
- with anti-scale system
- 3/8" shower outlet
- rosette for wall elbow 60 x 60mm
- rosette for shower holder 60 x 60mm
- metal shower hose 1250mm with integrated anti-twist protection
- 1/2" wall elbow
- WRAS

Intrinsic protection against back flow.

	Brushed Dark Platinum	27 808 980-99
	Chrome	27 808 980-00
	Chrome	27 808 980-00 0010
	Brushed Platinum	27 808 980-06
	Brushed Platinum	27 808 980-06 0010
	Platinum	27 808 980-08
	Platinum	27 808 980-08 0010
	Dark Chrome	27 808 980-19
	Dark Chrome	27 808 980-19 0010
	Brushed Light Gold	27 808 980-27
	Brushed Light Gold	27 808 980-27 0010
	Brushed Durabrass (23kt Gold)	27 808 980-28 0010
	Brushed Durabrass (23kt Gold)	27 808 980-28
	Matte Black	27 808 980-33
	Matte Black	27 808 980-33 0010
	Brushed Champagne (22kt Gold)	27 808 980-46 0010
	Champagne (22kt Gold)	27 808 980-47 0010
	Brushed Chrome	27 808 980-93
	Brushed Chrome	27 808 980-93 0010
	Brushed Dark Platinum	27 808 980-99 0010

### Recommended miscellaneous

- Concealed wall elbow -** 35 085 970 90
- max. recess depth 163 mm
  - min. recess depth 90 mm



27 808 980 Product version up to 6/3/2020

mm [inches]

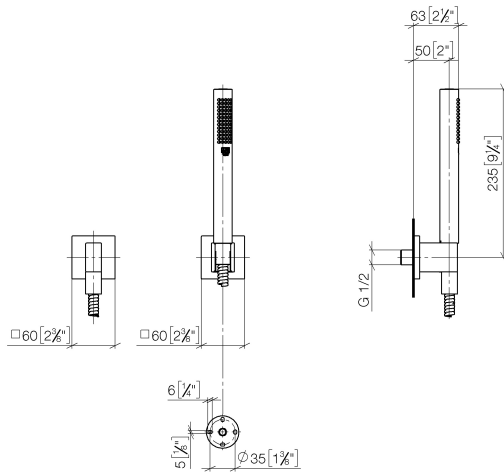

### Flow rate chart



### Codes & Standards

DIN 4109

EN 1717

ISO 3822

Scottish Water  
Byelaws

UK Water Supply  
Regulations

Ü-Zeichen



## Hand shower set with individual rosettes - Brushed Dark Platinum

SERIES SPECIFIC

27 808 980 Product version up to 6/3/2020

### Certificates and sustainability

LGA\_29

Belgaqua\_22\_280\_2 WRAS\_2209

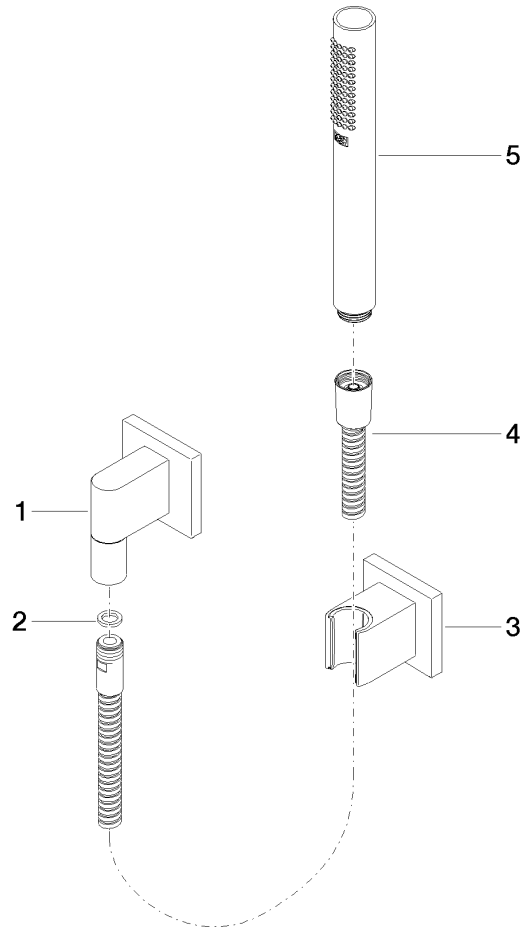

Spare parts list

No.	Item Number	Name	Quantity used	Delivery time
3	28 050 980-99	Wall bracket - Brushed Dark Platinum	1.00	20
4	90 30 02 072 00-99	Metal shower hose 1/2" x 3/8" x 1250 mm - Brushed Dark Platinum	1.00	20
1	28 450 980-99	Wall elbow - Brushed Dark Platinum	1.00	20
2	90 14 20 026 00 90	seal	1.00	2
5	90 12 11 140 40-99	shower	1.00	20