

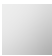

34 460 626



- shower with fixed riser projection 541mm
- overhead shower: rain flow
- rain shower Ø 300 mm
- rain shower with anti-scale system
- max. rainshower flow 14 l/min
- rotary diverter with volume control and shut-off function
- slide-on rosettes Ø 70 mm
- height of fittings up to rain shower (bottom edge) 1009mm
- height of fittings up to top edge of elbow 1150mm
- gauge 150 mm - 13 mm
- metal shower hose 1750mm with integrated anti-twist protection
- 1/2" connection
- slide bar
- Pipe diameter 23.5 mm
- quick clearing
- WRAS

This article does not include a hand shower!

	Chrome	34 460 626-00
	Matte Black	34 460 626-33
	Brushed Chrome	34 460 626-93

34 460 626
mm [inches]
1:10

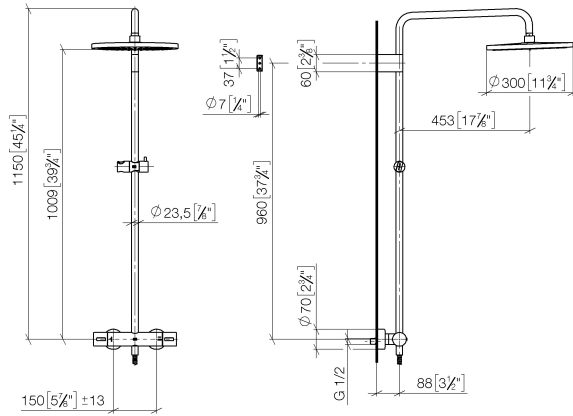

Flow rate chart

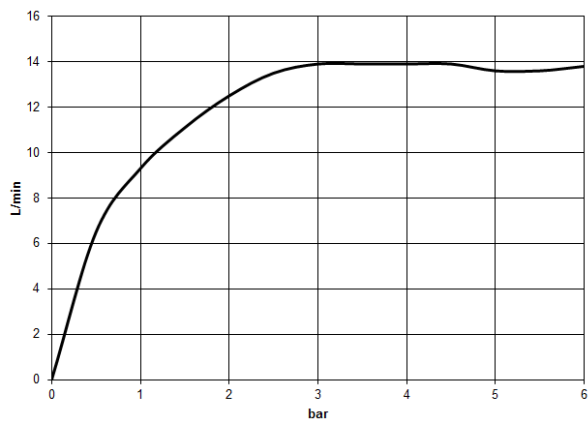

Codes & Standards

DIN 4109

EN 1717

ISO 3822

Scottish Water
Byelaws

UK Water Supply
Regulations

Ü-Zeichen



EDITION PRO Showerpipe with shower thermostat without hand shower - Chrome

EDITION PRO

34 460 626

Certificates and sustainability

Belgaqua_21-384-2 WRAS_2204

LGA_38

EDITION PRO Showerpipe with shower thermostat without hand shower - Chrome

EDITION PRO

34 460 626
Parts for other
finishes can be found
here: [Matte Black](#)

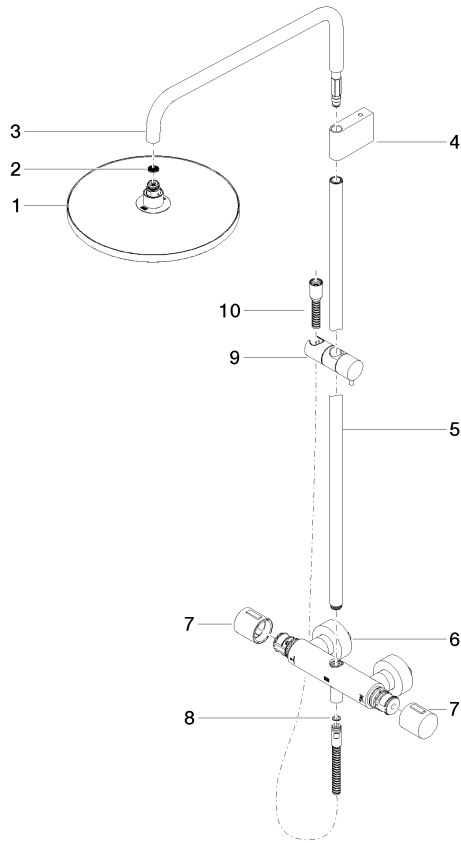

Spare parts list

No.	Item Number	Name	Quantity used	Delivery time
7	90 17 33 015 00-00	handle	1.00	10
1	04 12 05 091 00-00	shower	1.00	10
6	04 17 01 350 00-00	connection	1.00	10
10	28 322 970-00	Metal shower hose 1/2" x 3/8" x 1750 mm - Chrome	1.00	2
2	09 23 01 039 90	sieve	1.00	2
9	12 570 970-00	Slide unit - Chrome	1.00	10
3	90 28 22 348 00-00	pipe	1.00	10
4	90 17 11 150 00-00	holder	1.00	10
5	90 28 22 349 00-00	pipe	1.00	10
8	90 14 20 026 00 90	seal	1.00	2