

META Concealed two-way diverter - Brushed Dark Brass

META

36 200 661

Product version from 4/1/2022



- rotary diverter
- without rosette
- handle Ø 60mm
- WRAS

| | | |
|---|-------------------------------|---------------|
|  | Brushed Dark Brass | 36 200 661-39 |
|  | Chrome | 36 200 661-00 |
|  | Brushed Platinum | 36 200 661-06 |
|  | Dark Chrome | 36 200 661-19 |
|  | Light Gold | 36 200 661-26 |
|  | Brushed Light Gold | 36 200 661-27 |
|  | Matte Black | 36 200 661-33 |
|  | Brushed Bronze | 36 200 661-42 |
|  | Brushed Champagne (22kt Gold) | 36 200 661-46 |
|  | Champagne (22kt Gold) | 36 200 661-47 |
|  | Brushed Chrome | 36 200 661-93 |
|  | Brushed Dark Platinum | 36 200 661-99 |

36 200 661 Product version from 4/1/2022

mm [inches]



Flow rate chart



Codes & Standards

| | | | |
|----------|----------|---------------------------|--------------------------------|
| DIN 4109 | ISO 3822 | Scottish Water Byelaws | UK Water Supply Regulations |
|----------|----------|---------------------------|--------------------------------|

Ü-Zeichen



META Concealed two-way diverter - Brushed Dark Brass

META

36 200 661 Product version from 4/1/2022

Certificates and sustainability

LGA_38

WRAS_2307

36 200 661 Product version from 4/1/2022

Parts for other
finishes can be found
here: [Chrome](#)

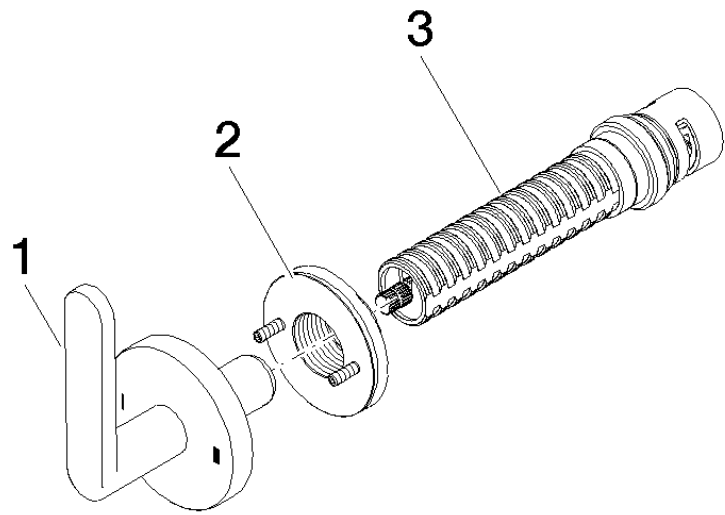

Spare parts list

| No. | Item Number | Name | Quantity used | Delivery time |
|-----|--------------------|----------|---------------|---------------|
| 2 | 90 21 02 181 00 90 | disc | 1.00 | 2 |
| 3 | 90 90 03 304 10 90 | diverter | 1.00 | 2 |
| 1 | 90 20 66 014 00-39 | handle | 1.00 | 30 |