

MEM Concealed two-way diverter - Champagne (22kt Gold)

MEM

36 200 782 Product version from 4/1/2022



- rotary diverter
- rosette 60 x 60 mm
- WRAS

| | | |
|---|-------------------------------|---------------|
|  | Champagne (22kt Gold) | 36 200 782-47 |
|  | Chrome | 36 200 782-00 |
|  | Brushed Platinum | 36 200 782-06 |
|  | Platinum | 36 200 782-08 |
|  | Dark Chrome | 36 200 782-19 |
|  | Brushed Durabrass (23kt Gold) | 36 200 782-28 |
|  | Brushed Champagne (22kt Gold) | 36 200 782-46 |
|  | Brushed Dark Platinum | 36 200 782-99 |

Required miscellaneous



- Concealed two-way diverter -

•max. recess depth 160 mm

•min. recess depth 115 mm

35 202 970 90

mm [inches]



Flow rate chart



Codes & Standards

| | | | |
|----------|----------|------------------------|-----------------------------|
| DIN 4109 | ISO 3822 | Scottish Water Byelaws | UK Water Supply Regulations |
|----------|----------|------------------------|-----------------------------|

Ü-Zeichen



MEM Concealed two-way diverter - Champagne (22kt Gold)

MEM

36 200 782 Product version from 4/1/2022

Certificates and sustainability

LGA_38

WRAS_2307

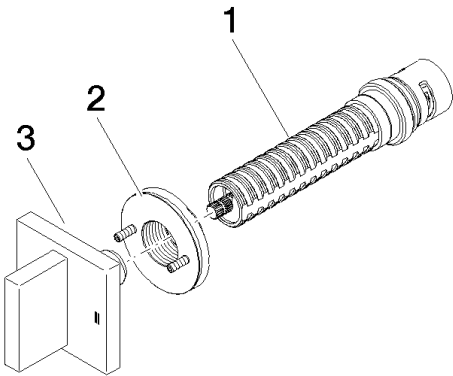

Spare parts list

| No. | Item Number | Name | Quantity used | Delivery time |
|-----|--------------------|----------|---------------|---------------|
| 3 | 90 20 78 002 08-47 | handle | 1.00 | 30 |
| 2 | 90 21 02 181 00 90 | disc | 1.00 | 2 |
| 1 | 90 90 03 304 10 90 | diverter | 1.00 | 2 |