

Washstand fitting with electronic opening and closing function without pop-up waste - Matte Black

SERIES SPECIFIC

44 521 660	Product version from 10/1/2023		
	<ul style="list-style-type: none"> <li>• 165mm projection</li> <li>• Infrared sensor technology</li> <li>• height of mixer 310 mm</li> <li>• height up to aerator 199 mm</li> <li>• hole diameter 35 mm</li> <li>• fixed spout</li> <li>• max. flow 5.7 l/min</li> <li>• circular, air-enriched flow</li> <li>• suitable for thermal disinfection</li> <li>• Automatic shut-off after pre-set time is reached</li> <li>• Indirect temperature control (undercounter)</li> <li>• Control box included</li> <li>• Adjustable sensor detection range</li> <li>• Battery or plug-in power supply operated (batteries not included)</li> <li>• 4x AA (1.5V) batteries required</li> <li>• lead-free</li> <li>• 1x screw-in M 8 x 1 pressure hose, leak-tested</li> <li>• This product can help a building meet the requirements of Green Building Rating Systems, e.g. LEED®, BREEAM®, DGNB</li> <li>• WRAS</li> </ul>		
	Batteries not included		
		<div> <div></div> <div>Matte Black</div> </div>	44 521 660-33
		<div> <div></div> <div>Chrome</div> </div>	44 521 660-00
		<div> <div></div> <div>Brushed Platinum</div> </div>	44 521 660-06
		<div> <div></div> <div>Platinum</div> </div>	44 521 660-08
		<div> <div></div> <div>Dark Chrome</div> </div>	44 521 660-19
		<div> <div></div> <div>Light Gold</div> </div>	44 521 660-26
		<div> <div></div> <div>Brushed Light Gold</div> </div>	44 521 660-27
		<div> <div></div> <div>Brushed Durabronze (23kt Gold)</div> </div>	44 521 660-28
		<div> <div></div> <div>Brushed Bronze</div> </div>	44 521 660-42
		<div> <div></div> <div>Brushed Champagne (22kt Gold)</div> </div>	44 521 660-46
		<div> <div></div> <div>Champagne (22kt Gold)</div> </div>	44 521 660-47
		<div> <div></div> <div>Brushed Chrome</div> </div>	44 521 660-93
		<div> <div></div> <div>Brushed Dark Platinum</div> </div>	44 521 660-99

# Washstand fitting with electronic opening and closing function without pop-up waste - Matte Black

SERIES SPECIFIC

44 521 660 Product version from 10/1/2023

mm [inches]  
1:5

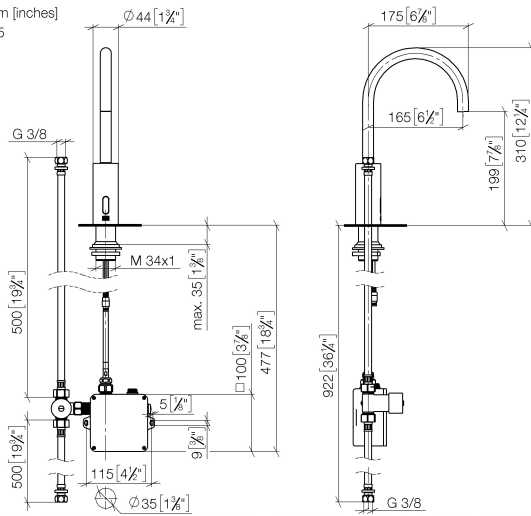

## Flow rate chart



## Codes & Standards

DIN 4109

EN 1717

Executive Order  
no. 1007

ISO 3822

Scottish Water  
Byelaws

UK Water Supply  
Regulations

Ü-Zeichen



Washstand fitting with electronic opening and closing function without pop-up waste - Matte Black

SERIES SPECIFIC

44 521 660    Product version from 10/1/2023

Certificates and sustainability

Belgaqua\_23-210-2    LGA\_38

WRAS\_2211

GDV\_0400

## Washstand fitting with electronic opening and closing function without pop-up waste - Matte Black

SERIES SPECIFIC

44 521 660 Product version from 10/1/2023

Parts for other  
finishes can be found  
here: [Chrome](#)

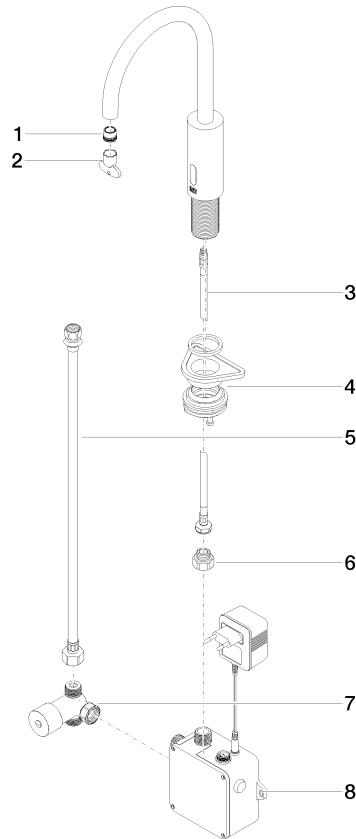

### Spare parts list

No.	Item Number	Name	Quantity used	Delivery time
7	90 30 50 081 00 90	valve	1.00	2
6	09 24 03 185-00	nipple	1.00	10
5	12 506 970 90	High pressure hoses -	1.00	2
3	04 30 04 100 00 90	hose	1.00	2
4	04 23 10 044 08 90	fixing set	1.00	2
1	09 29 03 126 90	aerator	1.00	2
2	90 30 09 028 00 90	key	1.00	2
8	90 10 01 247 00 90	valve box	1.00	2