











ST 110 201 1892

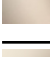

- 235mm projection
- pivotable spout 360°
- air-enriched flow and spray flow
- height of mixer 370 mm
- height up to aerator 212 mm
- hole diameter spout 35 mm
- hole diameter valve 32 mm
- hole diameter rinsing spray 32mm
- fabric braided hose 1500 mm
- automatic spout/shower diverter
- sprayface with anti-scaling system
- max. flow 7 l/min at 3 bar flow pressure
- lead-free
- This product can help a building meet the requirements of Green Building Rating Systems, e.g. LEED®, BREEAM®, DGNB

|  |                               |                    |
|--|-------------------------------|--------------------|
|  | Dark Chrome                   | ST 110 201 1892-19 |
|  | Chrome                        | ST 110 201 1892-00 |
|  | Brushed Platinum              | ST 110 201 1892-06 |
|  | Platinum                      | ST 110 201 1892-08 |
|  | Durabass (23kt Gold)          | ST 110 201 1892-09 |
|  | Brushed Durabass (23kt Gold)  | ST 110 201 1892-28 |
|  | Matte Black                   | ST 110 201 1892-33 |
|  | Brushed Champagne (22kt Gold) | ST 110 201 1892-46 |
|  | Champagne (22kt Gold)         | ST 110 201 1892-47 |
|  | Brushed Chrome                | ST 110 201 1892-93 |
|  | Brushed Dark Platinum         | ST 110 201 1892-99 |

**Individual components of this set**

You need the following components for this set



1x 20 815 892-19



1x 27 721 970-19



# TARA Three-hole mixer with rinsing spray set - Dark Chrome

---

TARA

ST 110 201 1892

ST 110 201 1892



- 235mm projection
- pivotable spout 360°
- air-enriched flow
- height of mixer 370 mm
- height up to aerator 212 mm
- hole diameter spout 35 mm
- hole diameter valve 32 mm
- max. flow 7 l/min at 3 bar flow pressure
- lead-free
- This product can help a building meet the requirements of Green Building Rating Systems, e.g. LEED®, BREEAM®, DGNB
- WRAS 2107052

|  |                                |               |
|--|--------------------------------|---------------|
|  | Dark Chrome                    | 20 815 892-19 |
|  | Chrome                         | 20 815 892-00 |
|  | Brushed Platinum               | 20 815 892-06 |
|  | Platinum                       | 20 815 892-08 |
|  | Durabronze (23kt Gold)         | 20 815 892-09 |
|  | Brushed Durabronze (23kt Gold) | 20 815 892-28 |
|  | Matte Black                    | 20 815 892-33 |
|  | Brushed Champagne (22kt Gold)  | 20 815 892-46 |
|  | Champagne (22kt Gold)          | 20 815 892-47 |
|  | Brushed Chrome                 | 20 815 892-93 |
|  | Brushed Dark Platinum          | 20 815 892-99 |

Recommended miscellaneous

**Dispenser with rosette - Dark Chrome** 82 444 970-19



Recommended miscellaneous

**Strainer waste with control handle - Dark Chrome** 10 710 970-19



Recommended miscellaneous

**Dispenser with rosette - Dark Chrome** 82 444 970-19



ST 110 201 1892

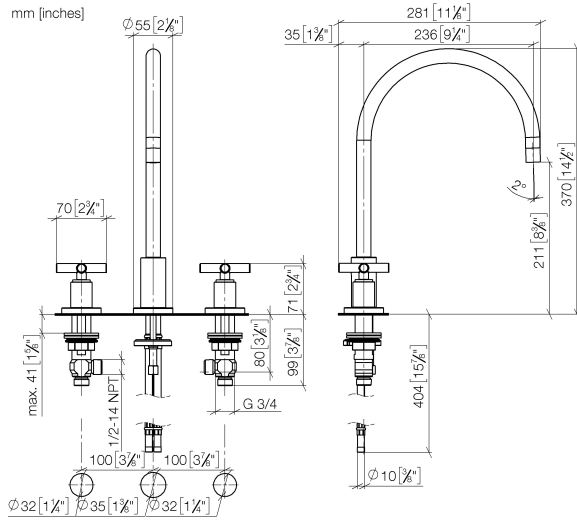

**Flow rate chart**

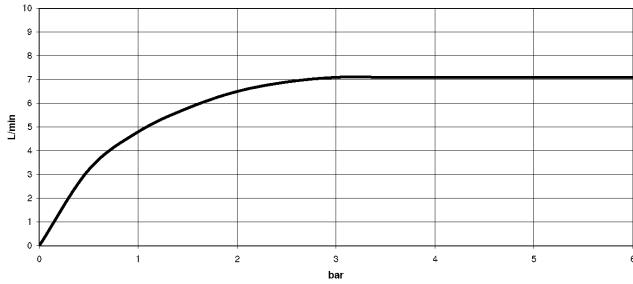

**Certificates**

GDV\_0400289.

ST 110 201 1892

Parts for other finishes can be found here: [Chrome](#)

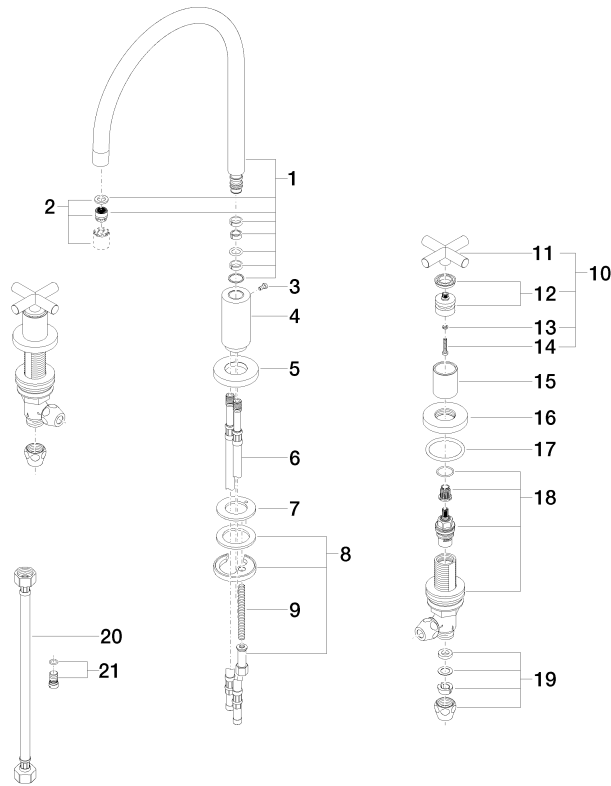

Fits: ELIO, TARA, TARA ULTRA

- with round rosette
- spray flow
- automatic spout/shower diverter
- height of mixer 191 mm
- hole diameter rinsing spray 32mm
- fabric braided hose 1500 mm
- sprayface with anti-scaling system
- lead-free

Can only be combined with 33826790, 32800790, 33826888, 32815888, 20815892, 33826875.

Intrinsic protection against back flow.

|  |                               |               |
|--|-------------------------------|---------------|
|  | Dark Chrome                   | 27 721 970-19 |
|  | Chrome                        | 27 721 970-00 |
|  | Brushed Platinum              | 27 721 970-06 |
|  | Platinum                      | 27 721 970-08 |
|  | Durabress (23kt Gold)         | 27 721 970-09 |
|  | Brushed Durabress (23kt Gold) | 27 721 970-28 |
|  | Matte Black                   | 27 721 970-33 |
|  | Brushed Champagne (22kt Gold) | 27 721 970-46 |
|  | Champagne (22kt Gold)         | 27 721 970-47 |
|  | Brushed Chrome                | 27 721 970-93 |
|  | Brushed Dark Platinum         | 27 721 970-99 |



## TARA Three-hole mixer with rinsing spray set - Dark Chrome

---

TARA

ST 110 201 1892



## TARA Three-hole mixer with rinsing spray set - Dark Chrome

---

TARA

ST 110 201 1892



# TARA Three-hole mixer with rinsing spray set - Dark Chrome

---

TARA

ST 110 201 1892



ST 110 201 1892

mm [inches]

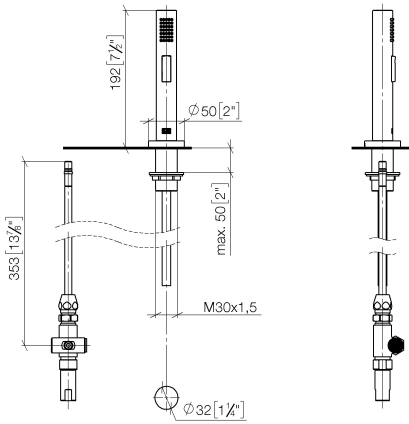

**Flow rate chart**

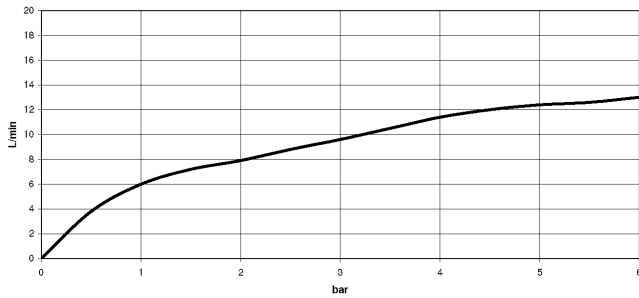

**Certificates**

LGA\_18901.

IAPMO\_N-4976 (2). LGA\_29572.

IAPMO\_6397.

ST 110 201 1892

Parts for other  
finishes can be found  
here: [Chrome](#)

