







## CL.1 Wall-mounted basin spout without pop-up waste - Brushed Platinum

13 800 705 Product version from 3/9/2015



- 200mm projection
- fixed spout
- rectangular spray pattern with 40 individual jets
- hole diameter 37 mm
- lead-free
- 1/2" connection
- plug-link mounting
- max. flow 4.5 l/min
- This product can help a building meet the requirements of Green Building Rating Systems, e.g. LEED®, BREEAM®, DGNB
- WRAS

	Brushed Platinum	13 800 705-06
	Chrome	13 800 705-00
	Dark Chrome	13 800 705-19
	Brushed Champagne (22kt Gold)	13 800 705-46
	Champagne (22kt Gold)	13 800 705-47
	Brushed Dark Platinum	13 800 705-99

### Recommended miscellaneous



- Concealed wall elbow -**
- max. recess depth mm
  - min. recess depth mm

35 085 970 90

## CL.1 Wall-mounted basin spout without pop-up waste - Brushed Platinum

13 800 705 Product version from 3/9/2015

mm [inches]

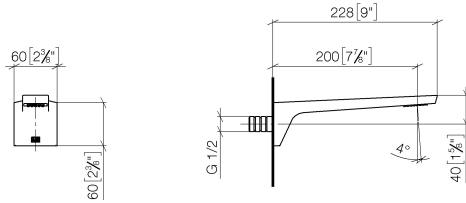

Flow rate chart



### Codes & Standards

ASME A112.18.1	cUPC	DIN 4109	EPA WaterSense
ISO 3822	NSF372	NSF61	Scottish Water Byelaws
UK Water Supply Regulations	Ü-Zeichen	WaterSense	



CL.1 Wall-mounted basin spout without pop-up waste - Brushed Platinum

---

13 800 705    Product version from 3/9/2015

Certificates

---

LGA_28	IAPMO_N-4	IAPMO_4976	IAPMO_8834	WRAS_1512
IAPMO_6				

# CL.1 Wall-mounted basin spout without pop-up waste - Brushed Platinum

13 800 705    Product version from 3/9/2015

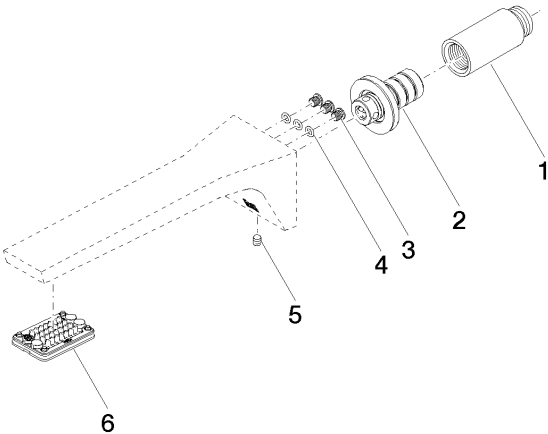

## Spare parts list

No.	Item Number	Name	Quantity used	Delivery time
1	09 24 03 081 10 90	extension	1	2
2	90 24 03 108 01 90	nipple set	1	2
3	09 30 30 113 20 90	screw	3	2
4	09 14 10 001 90	seal	3	2
5	90 31 11 004 00 90	pin	1	2
6	90 11 02 297 00 90	aerator	1	2