







**CL.1 Wall-mounted basin spout without pop-up waste - Brushed Champagne (22kt Gold)**

CL.1

13 800 705    Product version from 3/9/2015



- 200mm projection
- fixed spout
- rectangular spray pattern with 40 individual jets
- hole diameter 37 mm
- lead-free
- 1/2" connection
- plug-link mounting
- max. flow 4.5 l/min
- This product can help a building meet the requirements of Green Building Rating Systems, e.g. LEED®, BREEAM®, DGNB
- WRAS

	Brushed Champagne (22kt Gold)	13 800 705-46
	Chrome	13 800 705-00
	Brushed Platinum	13 800 705-06
	Dark Chrome	13 800 705-19
	Champagne (22kt Gold)	13 800 705-47
	Brushed Dark Platinum	13 800 705-99



CL.1 Wall-mounted basin spout without pop-up waste - Brushed Champagne  
(22kt Gold)

CL.1

13 800 705    Product version from 3/9/2015  
mm [inches]

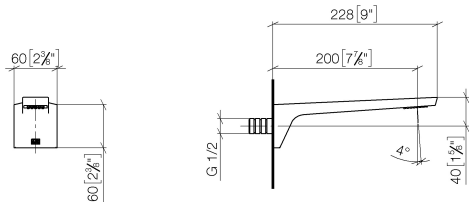

Flow rate chart

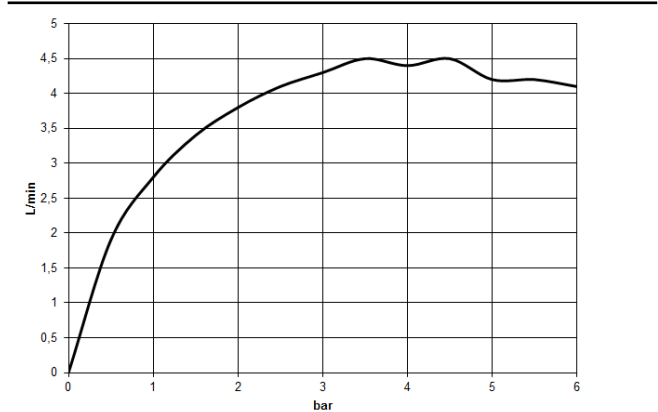

Codes & Standards

ASME A112.18.1	cUPC	EPA WaterSense	NSF372
NSF61	WaterSense		



CL.1 Wall-mounted basin spout without pop-up waste - Brushed Champagne  
(22kt Gold)

CL.1

13 800 705    Product version from 3/9/2015

Certificates and sustainability

IAPMO_N-4	IAPMO_4976	IAPMO_8834	IAPMO_6
-----------	------------	------------	---------

## CL.1 Wall-mounted basin spout without pop-up waste - Brushed Champagne (22kt Gold)

CL.1

13 800 705 Product version from 3/9/2015

Parts for other  
finishes can be found  
here: [Chrome](#)

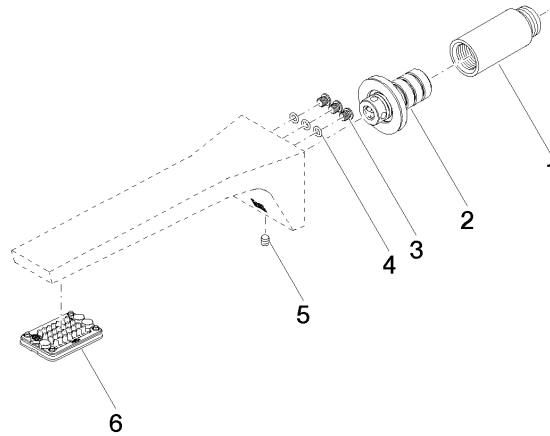

### Spare parts list

No.	Item Number	Name	Quantity used	Delivery time
2	90 24 03 108 01 90	nipple set	1.00	2
4	09 14 10 001 90	seal	3.00	2
1	09 24 03 081 10 90	extension	1.00	2
6	90 11 02 297 00 90	aerator	1.00	2
5	90 31 11 004 00 90	pin	1.00	2
3	09 30 30 113 20 90	screw	3.00	2