

## META Wall-mounted valve cold water without pop-up waste - Chrome

META

30 010 662



- 126mm projection
- fixed spout
- circular, air-enriched flow
- hole diameter 35 mm
- rosette Ø 60 mm
- max. flow 5.7 l/min
- lead-free
- This product can help a building meet the requirements of Green Building Rating Systems, e.g. LEED®, BREEAM®, DGNB

|  |                               |               |
|--|-------------------------------|---------------|
|    | Chrome                        | 30 010 662-00 |
|    | Brushed Platinum              | 30 010 662-06 |
|    | Dark Chrome                   | 30 010 662-19 |
|    | Light Gold                    | 30 010 662-26 |
|    | Brushed Light Gold            | 30 010 662-27 |
|    | Matte Black                   | 30 010 662-33 |
|    | Brushed Bronze                | 30 010 662-42 |
|    | Brushed Champagne (22kt Gold) | 30 010 662-46 |
|    | Champagne (22kt Gold)         | 30 010 662-47 |
|   | Brushed Chrome                | 30 010 662-93 |
|  | Brushed Dark Platinum         | 30 010 662-99 |

### Recommended miscellaneous

#### Concealed wall elbow -

35 085 970 90



- max. recess depth 163 mm
- min. recess depth 90 mm

30 010 662

mm [inches]



**Flow rate chart**



**Codes & Standards**

DIN 4109

ISO 3822

Ü-Zeichen



## META Wall-mounted valve cold water without pop-up waste - Chrome

---

META

30 010 662

### Certificates

---

LGA\_38

**Product version from 5/1/2022**

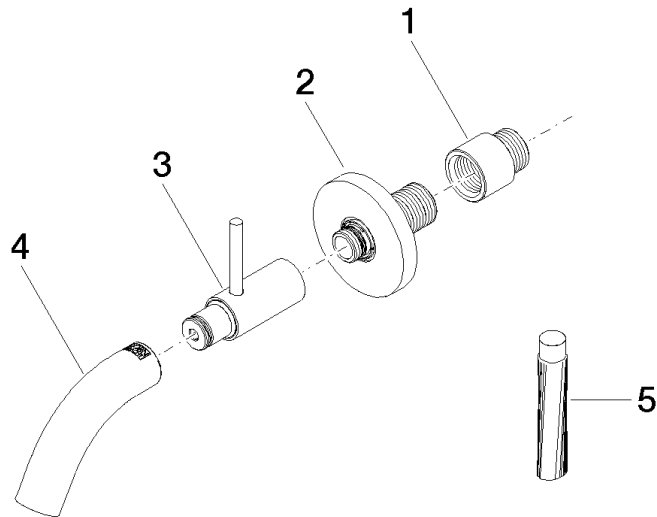



## META Wall-mounted valve cold water without pop-up waste - Chrome

META

30 010 662

### Spare parts list

#### Product version from 5/1/2022

| No. | Item Number        | Name   | Quantity used | Delivery time |
|-----|--------------------|--------|---------------|---------------|
|     | 09 24 03 072 10 90 | nipple | 5             | 2             |