

TARA ULTRA Single-lever mixer - Platinum

TARA ULTRA

33 816 875 Product version from 5/31/2010 to 7/25/2018



- 241mm projection
- pivotable spout 360°
- air-enriched flow
- height of mixer 393 mm
- height up to aerator 240 mm
- hole diameter 35 mm
- max. flow 8 l/min at 3 bar flow pressure
- lead-free
- This product can help a building meet the requirements of Green Building Rating Systems, e.g. LEED®, BREEAM®, DGNB
- WRAS

| | | |
|-------------------------------------------------------------------------------------|--------------------------------|---------------|
|  | Platinum | 33 816 875-08 |
|  | Chrome | 33 816 875-00 |
|  | Brushed Platinum | 33 816 875-06 |
|  | Durabronze (23kt Gold) | 33 816 875-09 |
|  | Dark Chrome | 33 816 875-19 |
|  | Brushed Durabronze (23kt Gold) | 33 816 875-28 |
|  | Matte Black | 33 816 875-33 |
|  | Brushed Bronze | 33 816 875-42 |
|  | Brushed Champagne (22kt Gold) | 33 816 875-46 |
|  | Champagne (22kt Gold) | 33 816 875-47 |
|  | Brushed Chrome | 33 816 875-93 |
|  | Brushed Dark Platinum | 33 816 875-99 |

Recommended miscellaneous

**Dispenser without rosette -
Platinum**

82 424 970-08



Recommended miscellaneous

**Strainer waste with control handle -
Platinum**

10 712 970-08



33 816 875 Product version from 5/31/2010 to 7/25/2018



Flow rate chart



Codes & Standards

| | | | |
|---------------------------|--------------------------------|-----------------------------|------------|
| DIN 4109 | EN 817 | Executive Order no. 1007 | ISO 3822 |
| Scottish Water Byelaws | UK Water Supply Regulations | Ü-Zeichen | VA-Zeichen |



TARA ULTRA Single-lever mixer - Platinum

TARA ULTRA

33 816 875 Product version from 5/31/2010 to 7/25/2018

Certificates and sustainability

| | | | |
|----------|--------|-----------|--------|
| GDV_0400 | LGA_18 | WRAS_2101 | ETA_18 |
|----------|--------|-----------|--------|

33 816 875 Product version from 5/31/2010 to 7/25/2018

Parts for other
finishes can be found
here: [Chrome](#)

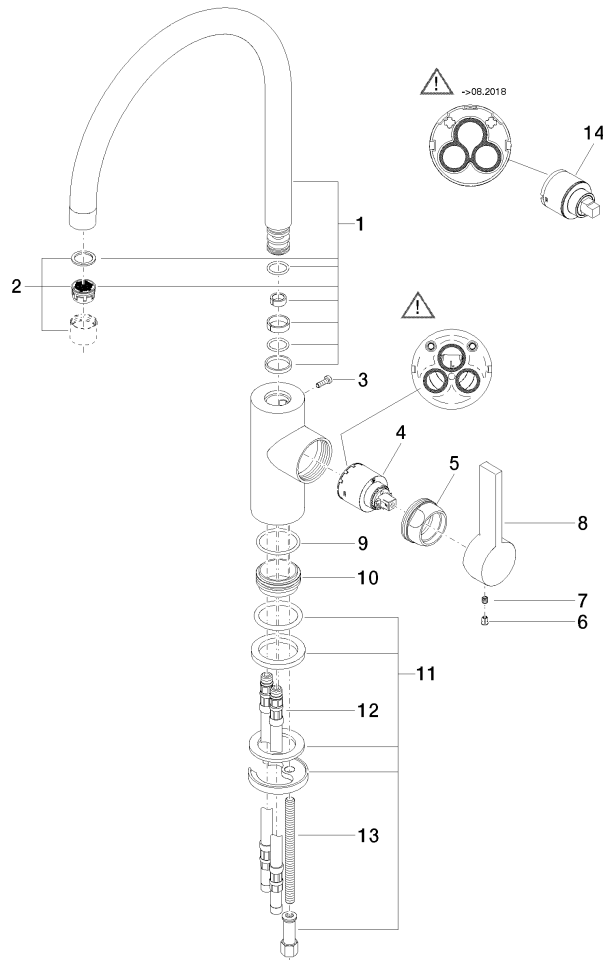

Spare parts list

| No. | Item Number | Name | Quantity used | Delivery time |
|-----|-----------------------|------------|---------------|---------------|
| | 2 90 23 01 004 07-08 | aerator | 1.00 | 40 |
| | 10 09 28 10 109-07 | ring | 1.00 | 30 |
| | 6 09 31 20 017 90 | plug | 1.00 | 2 |
| | 1 90 28 22 202 02-08 | spout | 1.00 | 40 |
| | 11 04 30 11 085 88 90 | fixing set | 1.00 | 2 |
| | 4 90 15 05 061 00 90 | cartridge | 1.00 | 60 |
| | 9 09 14 10 119 90 | seal | 1.00 | 2 |
| | 13 09 31 11 012 90 | pin | 1.00 | 2 |
| | 3 09 30 30 080 90 | screw | 1.00 | 2 |
| | 5 09 24 04 107-08 | nut | 1.00 | 40 |
| | 12 04 30 04 016 00 90 | hose | 2.00 | 60 |
| | 8 09 20 79 040-08 | handle | 1.00 | 40 |
| | 7 90 31 11 030 00 90 | pin | 1.00 | 2 |
| | 14 90 15 05 045 00 90 | cartridge | 1.00 | 2 |