

CL.1 Wall valve clockwise closing 1/2" - Brushed Dark Platinum







CL.1

36 607 705

Product version up to 10/14/2020



- rosette 60 x 60 mm
- without marking
- head part with cut-to-length spindle and sleeve
- WRAS

| | | |
|---|--------------------------------|---------------|
|  | Brushed Dark Platinum | 36 607 705-99 |
|  | Chrome | 36 607 705-00 |
|  | Brushed Platinum | 36 607 705-06 |
|  | Dark Chrome | 36 607 705-19 |
|  | Brushed Durabronze (23kt Gold) | 36 607 705-28 |
|  | Brushed Champagne (22kt Gold) | 36 607 705-46 |
|  | Champagne (22kt Gold) | 36 607 705-47 |

Required miscellaneous

| | | |
|---|--|---------------|
|  | <div> <div>Wall valve 1/2" -</div> <div> <div>•max. recess depth 150 mm</div> <div>•min. recess depth 105 mm</div> </div> </div> | 35 607 970 90 |
|---|--|---------------|

CL.1 Wall valve clockwise closing 1/2" - Brushed Dark Platinum

CL.1

36 607 705 Product version up to 10/14/2020

mm [inches]



| Codes & Standards | | | |
|-------------------|----------|------------------------|-----------------------------|
| ASME A112.18.1 | cUPC | DIN 4109 | EN 1111 |
| EN 200 | ISO 3822 | Scottish Water Byelaws | UK Water Supply Regulations |
| Ü-Zeichen | | | |

| Certificates and sustainability | | | | |
|---------------------------------|--------------|--------|-----------|-----------------|
| DVGW_DW-6501DN0 | WRAS_2011 | LGA_29 | WRAS_2010 | DVGW_DW-6512DN0 |
| LGA_29 | IAPMO_4976 (| | | |

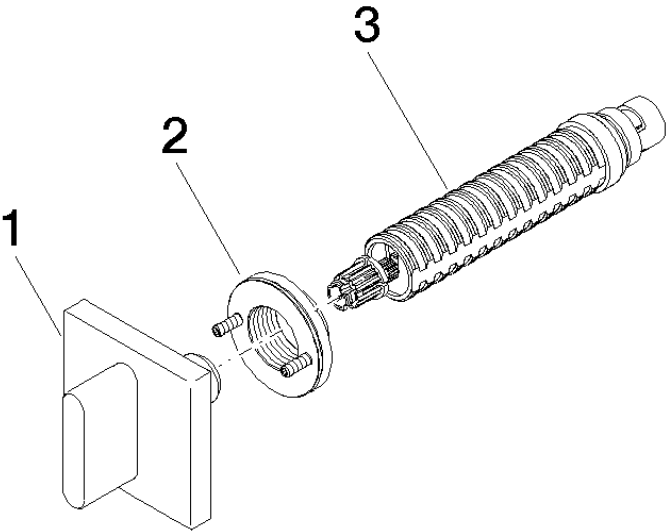

Spare parts list

| No. | Item Number | Name | Quantity used | Delivery time |
|-----|--------------------|--------|---------------|---------------|
| 2 | 90 21 02 108 00 90 | disc | 1.00 | 2 |
| 1 | 90 20 70 051 01-99 | handle | 1.00 | 20 |
| 3 | 90 90 03 143 00 90 | top | 1.00 | 2 |