

## TARA Bath grip - Brushed Champagne (22kt Gold)

TARA

83 030 892



- gauge 300 mm
- width 355mm
- height 55 mm
- rosette Ø 55 mm
- 80mm projection

|                                                                                      |                                |               |
|--------------------------------------------------------------------------------------|--------------------------------|---------------|
|    | Brushed Champagne (22kt Gold)  | 83 030 892-46 |
|    | Chrome                         | 83 030 892-00 |
|    | Brushed Platinum               | 83 030 892-06 |
|    | Platinum                       | 83 030 892-08 |
|    | Dark Chrome                    | 83 030 892-19 |
|    | Brushed Durabronze (23kt Gold) | 83 030 892-28 |
|    | Matte Black                    | 83 030 892-33 |
|    | Brushed Bronze                 | 83 030 892-42 |
|    | Champagne (22kt Gold)          | 83 030 892-47 |
|   | Brushed Chrome                 | 83 030 892-93 |
|  | Brushed Dark Platinum          | 83 030 892-99 |

83 030 892

mm [inches]



**Product version from 4/1/2024**

Parts for other  
finishes can be found  
here: [Chrome](#)

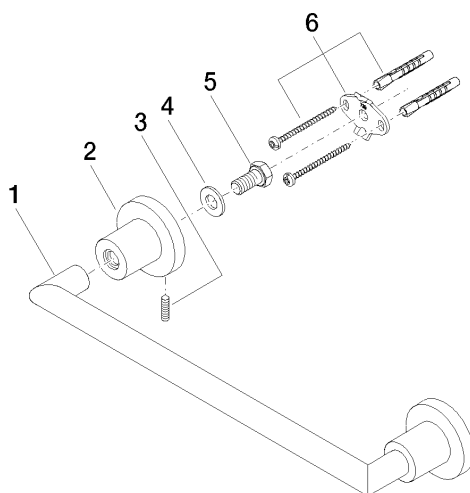



## TARA Bath grip - Brushed Champagne (22kt Gold)

TARA

83 030 892

### Spare parts list

#### Product version from 4/1/2024

| No. | Item Number        | Name   | Quantity used | Delivery time |
|-----|--------------------|--------|---------------|---------------|
|     | 05 28 22 587 00-46 | holder | 11            | 30            |