





VAIA xTOOL Thermostat module with 3 valves - Champagne (22kt Gold)

VAIA

ST 060 115 2809



- cover plate Ø 123 mm
- rosette Ø 60 mm
- temperature control handle with safety limit stop at 38°C
- thermostat cartridge
- 3x head part with cut-to-length spindle and sleeve

| | | |
|--|-------------------------------|--------------------|
|  | Champagne (22kt Gold) | ST 060 115 2809-47 |
|  | Chrome | ST 060 115 2809-00 |
|  | Brushed Platinum | ST 060 115 2809-06 |
|  | Platinum | ST 060 115 2809-08 |
|  | Dark Chrome | ST 060 115 2809-19 |
|  | Brushed Durabrass (23kt Gold) | ST 060 115 2809-28 |
|  | Brushed Bronze | ST 060 115 2809-42 |
|  | Brushed Champagne (22kt Gold) | ST 060 115 2809-46 |
|  | Brushed Dark Platinum | ST 060 115 2809-99 |

Individual components of this set

You need the following components for this set



3x 36 607 809-47







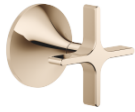



1x 36 503 809-47

ST 060 115 2809

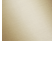

- rosette Ø 60 mm
- head part with cut-to-length spindle and sleeve
- WRAS 2011026, 2010066

| | | |
|--|--------------------------------|--------------|
|  | Champagne (22kt Gold) | 36 607 809-4 |
|  | Chrome | 36 607 809-0 |
|  | Brushed Platinum | 36 607 809-0 |
|  | Platinum | 36 607 809-0 |
|  | Dark Chrome | 36 607 809-1 |
|  | Brushed Durabronze (23kt Gold) | 36 607 809-2 |
|  | Brushed Bronze | 36 607 809-4 |
|  | Brushed Champagne (22kt Gold) | 36 607 809-4 |
|  | Brushed Dark Platinum | 36 607 809-9 |

ST 060 115 2809

.7
—
:0
—
:6
—
:8
—
9
—
:8
—
2
—
6
—
:9
—

Required miscellaneous

- 
- Wall valve 1/2" -

•max. recess depth 145 mm

•min. recess depth 75 mm
- 35 607 970 90

ST 060 115 2809

mm [inches]

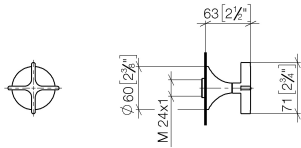

Certificates

| | | | | |
|-----------------|-----------|--------|-----------------|-----------|
| DVGW_DW-6501DN0 | WRAS_2010 | LGA_29 | DVGW_DW-6512DN0 | WRAS_2011 |
|-----------------|-----------|--------|-----------------|-----------|

Codes & Standards

DIN 4109

EN 1111

EN 200

ISO 3822

Scottish Water
Byelaws

UK Water Supply
Regulations

Ü-Zeichen

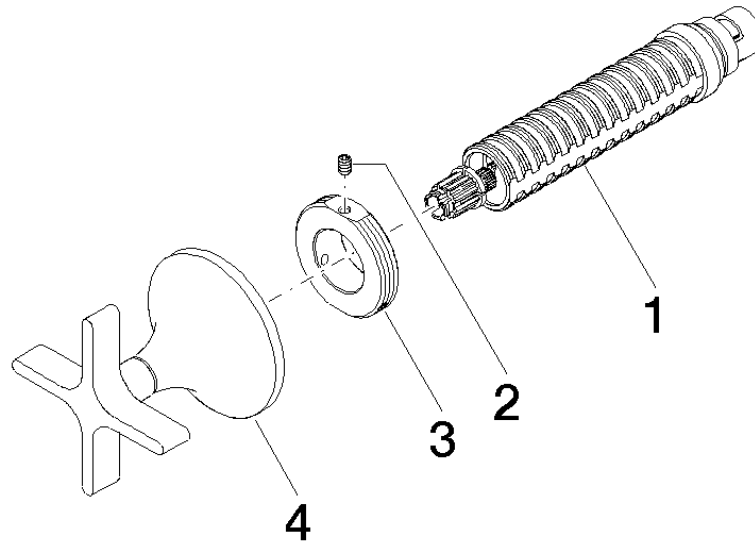



ST 060 115 2809

Spare parts list









| No. | Item Number | Name | Quantity used | Delivery time |
|-----|--------------------|------|---------------|---------------|
| | 90 90 03 143 00 90 | top | 4 | 2 |

VAIA xTOOL Thermostat module with 3 valves - Champagne (22kt Gold)
VAIA

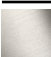
ST 060 115 2809



- cover plate Ø 123 mm
- temperature control handle with safety limit stop at 38°C
- thermostat cartridge
- WRAS 2011026

| | | |
|--|--------------------------------|--------------|
|  | Champagne (22kt Gold) | 36 503 809-4 |
|  | Chrome | 36 503 809-0 |
|  | Brushed Platinum | 36 503 809-0 |
|  | Platinum | 36 503 809-0 |
|  | Dark Chrome | 36 503 809-1 |
|  | Brushed Durabronze (23kt Gold) | 36 503 809-2 |
|  | Brushed Bronze | 36 503 809-4 |
|  | Brushed Champagne (22kt Gold) | 36 503 809-4 |
|  | Brushed Dark Platinum | 36 503 809-9 |

ST 060 115 2809

.7
—
:0
—
:6
—
:8
—
9
—
:8
—
.2
—
6
—
:9
—

Required miscellaneous



**xTOOL Concealed thermostat
module without volume control -**
●max. recess depth 110 mm
●min. recess depth 85 mm

35 503 970 90

ST 060 115 2809

mm [inches]

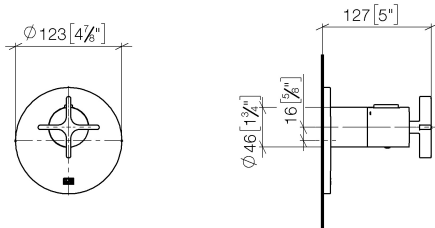

Flow rate chart

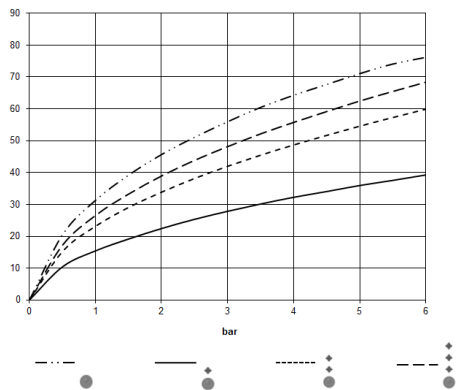

Certificates

LGA_29

LGA_29

LGA_29

WRAS_2011

Codes & Standards

DIN 4109

ISO 3822

Scottish Water
Byelaws

UK Water Supply
Regulations

Ü-Zeichen

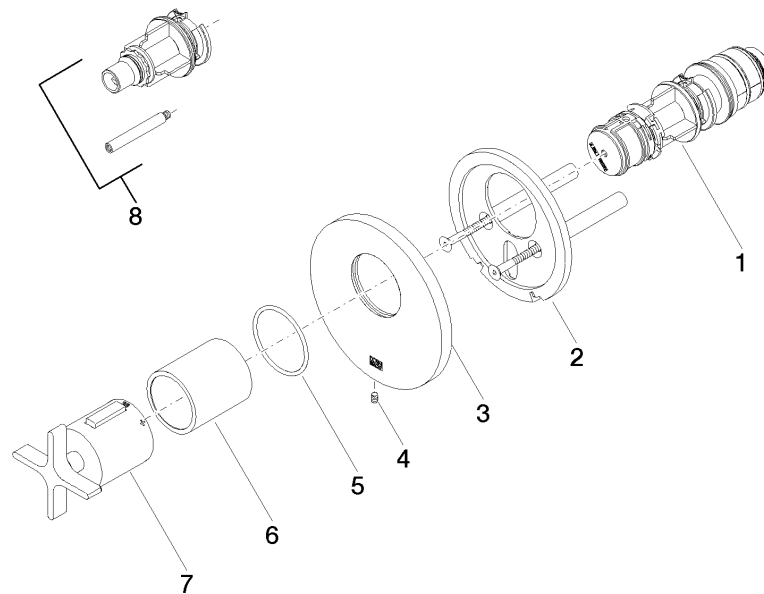



ST 060 115 2809

Spare parts list

| No. | Item Number | Name | Quantity used | Delivery time |
|-----|--------------------|-----------|---------------|---------------|
| | 90 15 02 063 00 90 | cartridge | 8 | 2 |