

## LISSÉ Hand shower set with individual rosettes FlowReduce - Chrome

LISSÉ

27 803 845 Product version from 4/1/2024



- Three or five settings: COMPACT RAIN, COMPACT SOFT FLOW, COMPACT AQUAPRESSURE FLOW, max. flow rate 6.8 l/min (at 3 bar)
- metal shower hose 1250mm with integrated anti-twist protection
- 3/8" shower outlet
- with anti-scale system











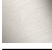
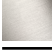

### Technical data:

- rosette for wall elbow 60 x 78mm
- rosette for shower holder 60 x 78mm
- 1/2" wall elbow

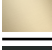
### Notes:

- WRAS

Intrinsic protection against back flow.

	Chrome	27 803 845-00 0010
	Chrome	27 803 845-00
	Brushed Platinum	27 803 845-06
	Brushed Platinum	27 803 845-06 0010
	Dark Chrome	27 803 845-19 0010
	Dark Chrome	27 803 845-19
	Brushed Light Gold	27 803 845-27
	Brushed Light Gold	27 803 845-27 0010
	Matte Black	27 803 845-33 0010
	Matte Black	27 803 845-33
	Brushed Chrome	27 803 845-93
	Brushed Chrome	27 803 845-93 0010
	Brushed Dark Platinum	27 803 845-99
	Brushed Dark Platinum	27 803 845-99 0010

### Recommended miscellaneous

#### Concealed wall elbow -

35 085 970 90



- max. recess depth 163 mm
- min. recess depth 90 mm

27 803 845 Product version from 4/1/2024

mm [inches]

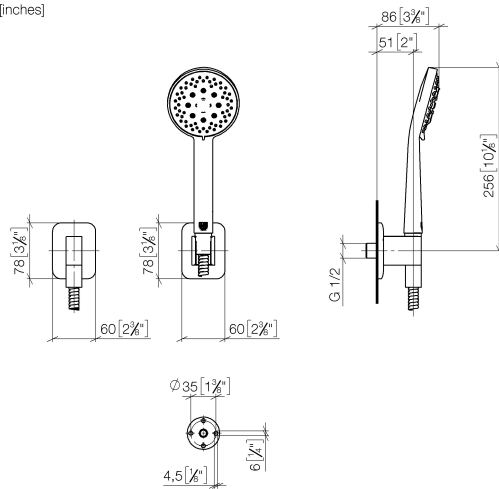

## Codes & Standards

ASME A112.18.1	cUPC	DIN 4109	ISO 3822
----------------	------	----------	----------

## Ü-Zeichen

## Certificates and sustainability

LGA_29	IAPMO_4976
--------	------------

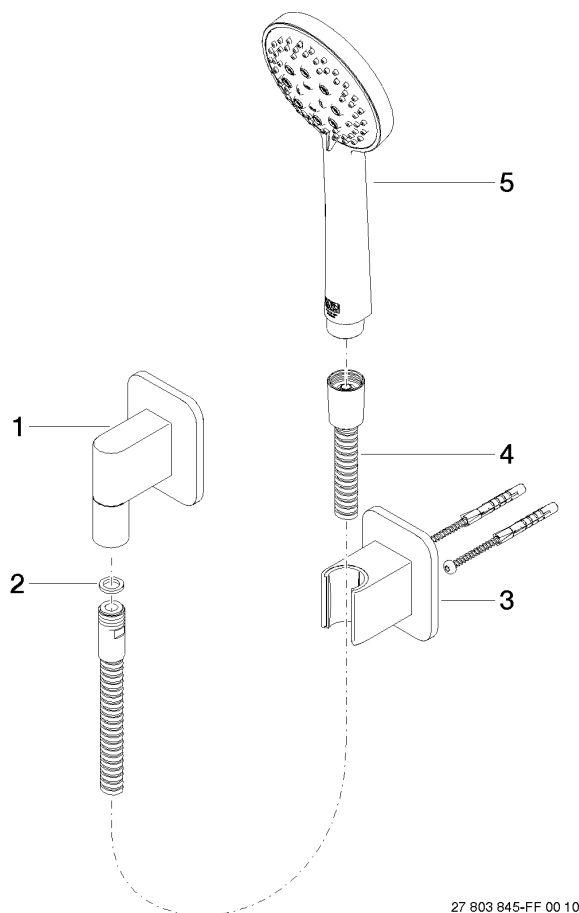

27 803 845-FF 00 10

## Spare parts list

No.	Item Number	Name	Quantity used	Delivery time
4	90 30 02 072 00-00	Metal shower hose 1/2" x 3/8" x 1250 mm - Chrome	1.00	10
5	28 014 979-00 0010	Hand shower - Chrome	1.00	-
Spare part can no longer be ordered, please order the replacement item				
28018979-000010 Hand shower FlowReduce - Chrome				
3	28 050 845-00	LISSÉ Wall bracket - Chrome	1.00	10
1	28 450 845-00	LISSÉ Wall elbow - Chrome	1.00	10
2	90 14 20 026 00 90	seal	1.00	2