

## LISSÉ Single-lever basin mixer with pop-up waste - Dark Chrome







LISSÉ

33 500 845 Product version from 5/3/2021

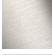

- 130mm projection
- 1 1/4" pop-up waste
- fixed spout
- circular, air-enriched flow
- height of mixer 127 mm
- height up to aerator 75 mm
- hole diameter 35 mm
- 2x screw-in M 8 x 1 pressure hose, leak-tested
- max. flow 5.7 l/min
- lead-free
- This product can help a building meet the requirements of Green Building Rating Systems, e.g. LEED®, BREEAM®, DGNB
- WRAS

Only suitable for basins with an overflow.

|   |                       |               |
|---|-----------------------|---------------|
|  | Dark Chrome           | 33 500 845-19 |
|  | Chrome                | 33 500 845-00 |
|  | Brushed Platinum      | 33 500 845-06 |
|  | Brushed Light Gold    | 33 500 845-27 |
|  | Matte Black           | 33 500 845-33 |
|  | Brushed Chrome        | 33 500 845-93 |
|  | Brushed Dark Platinum | 33 500 845-99 |

33 500 845 Product version from 5/3/2021

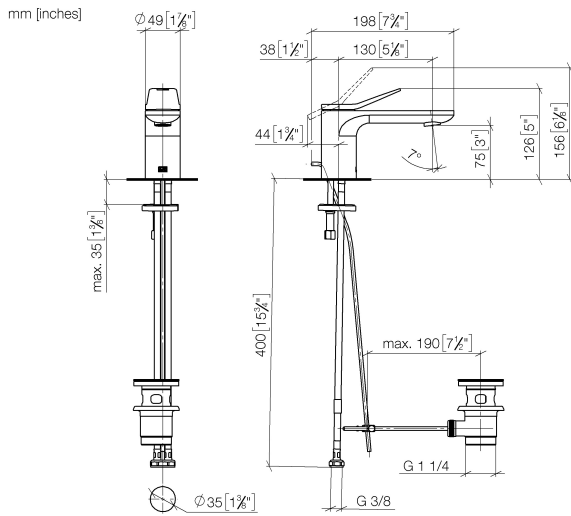

**Flow rate chart**

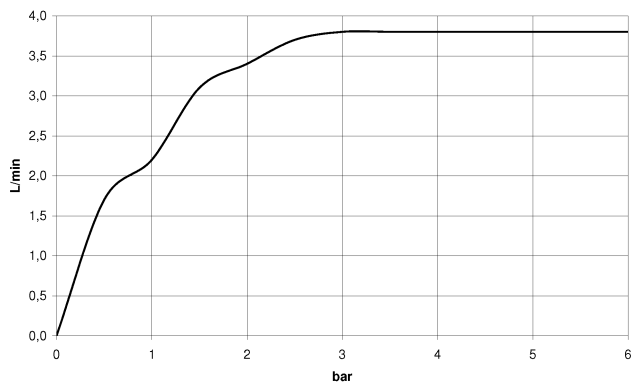

**Codes & Standards**

DIN 4109

Executive Order  
no. 1007

ISO 3822

Scottish Water  
Byelaws

UK Water Supply  
Regulations

Ü-Zeichen



## LISSE Single-lever basin mixer with pop-up waste - Dark Chrome

LISSE

33 500 845 Product version from 5/3/2021

### Certificates and sustainability

LGA\_29

GDV\_0400

WRAS\_250402

33 500 845 Product version from 5/3/2021

Parts for other  
finishes can be found  
here: [Chrome](#)

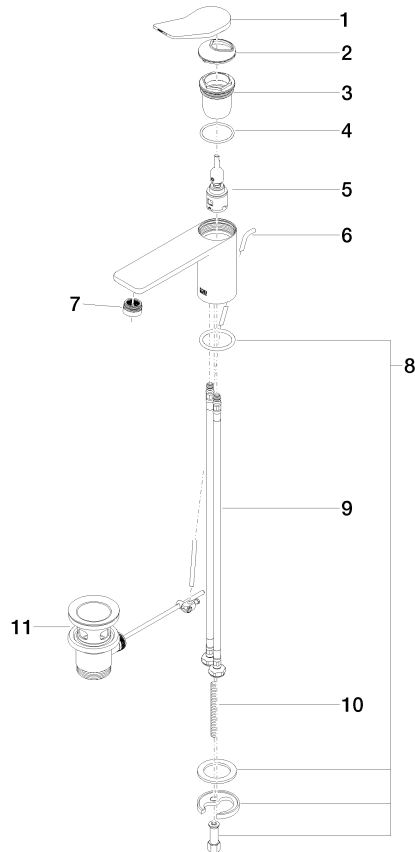

## Spare parts list

| No. | Item Number        | Name         | Quantity used | Delivery time |
|-----|--------------------|--------------|---------------|---------------|
| 9   | 04 30 04 100 00 90 | hose         | 2.00          | 2             |
| 4   | 09 14 10 038 90    | seal         | 1.00          | 2             |
| 11  | 90 11 01 001 00-19 | pop-up waste | 1.00          | 20            |
| 6   | 09 31 09 120-19    | pull-rod     | 1.00          | 60            |
| 10  | 09 31 11 011 90    | pin          | 1.00          | 2             |
| 8   | 04 30 11 038 75 90 | fixing set   | 1.00          | 2             |
| 1   | 90 20 84 020 00-19 | handle       | 1.00          | 20            |
| 5   | 90 15 05 042 01 90 | cartridge    | 1.00          | 2             |
| 3   | 09 23 10 123 90    | nut          | 1.00          | 2             |
| 7   | 90 23 01 161 01-19 | aerator      | 1.00          | 20            |
| 2   | 09 28 30 034 90    | cover        | 1.00          | 2             |