





## IMO Single-lever basin mixer with high spout without pop-up waste - Brushed Light Gold

IMO

33 526 671 Product version from 4/1/2024

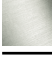
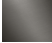

- 165mm projection
- fixed spout
- rectangular, air-enriched flow
- height of mixer 278 mm
- height up to aerator 235 mm
- hole diameter 35 mm
- 2x screw-in M 8 x 1 pressure hose, leak-tested
- max. flow 4.6 l/min
- lead-free
- This product can help a building meet the requirements of Green Building Rating Systems, e.g. LEED®, BREEAM®, DGNB

	Brushed Light Gold	33 526 671-27
	Chrome	33 526 671-00
	Brushed Platinum	33 526 671-06
	Dark Chrome	33 526 671-19
	Matte Black	33 526 671-33
	Brushed Chrome	33 526 671-93
	Brushed Dark Platinum	33 526 671-99

33 526 671 Product version from 4/1/2024

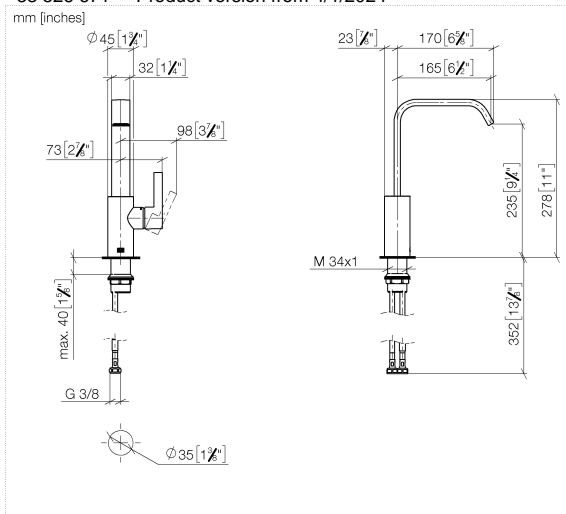

### Flow rate chart



## Codes & Standards

DIN 4109

ISO 3822

## Scottish Water Byelaws

UK Water Supply Regulations

## Ü-Zeichen



## IMO Single-lever basin mixer with high spout without pop-up waste - Brushed Light Gold

---

IMO

33 526 671 Product version from 4/1/2024

Certificates and sustainability

---

LGA\_28

WRAS\_250502

## IMO Single-lever basin mixer with high spout without pop-up waste - Brushed Light Gold

IMO

33 526 671 Product version from 4/1/2024

Parts for other  
finishes can be found  
here: [Chrome](#)

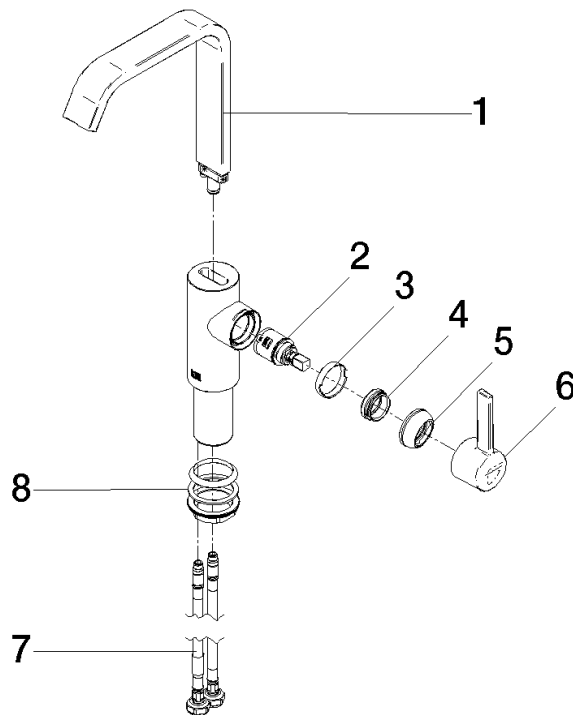

### Spare parts list

No.	Item Number	Name	Quantity used	Delivery time
	2 90 15 05 042 00 90	cartridge	1.00	2
	5 90 28 30 061 00-27	cover	1.00	20
	4 09 24 04 266 90	nut	1.00	2
	1 90 28 22 404 00-27	spout	1.00	20
	7 04 30 04 100 00 90	hose	2.00	2
	8 04 23 10 044 07 90	fixing set	1.00	2
	3 90 23 10 128 00 90	nut	1.00	2
	6 90 20 67 027 00-27	handle	1.00	20