







CL.1 Wall valve clockwise closing 1/2" - Dark Chrome

CL.1

36 607 705 Product version from 10/14/2020

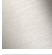

- rosette 60 x 60 mm
- without marking
- head part with cut-to-length spindle and sleeve
- WRAS

	Dark Chrome	36 607 705-19
	Chrome	36 607 705-00
	Brushed Platinum	36 607 705-06
	Brushed Durabronze (23kt Gold)	36 607 705-28
	Brushed Champagne (22kt Gold)	36 607 705-46
	Champagne (22kt Gold)	36 607 705-47
	Brushed Dark Platinum	36 607 705-99



CL.1 Wall valve clockwise closing 1/2" - Dark Chrome

CL.1

36 607 705 Product version from 10/14/2020

mm [inches]



Codes & Standards

ASME A112.18.1	cUPC	DIN 4109	EN 1111
ISO 3822	Scottish Water Byelaws	UK Water Supply Regulations	Ü-Zeichen

Certificates and sustainability

WRAS_2011	LGA_29	WRAS_2010	DVGW_DW-6512DN0	IAPMO_4976 (
-----------	--------	-----------	-----------------	--------------

36 607 705 Product version from 10/14/2020

Parts for other
finishes can be found
here: [Chrome](#)

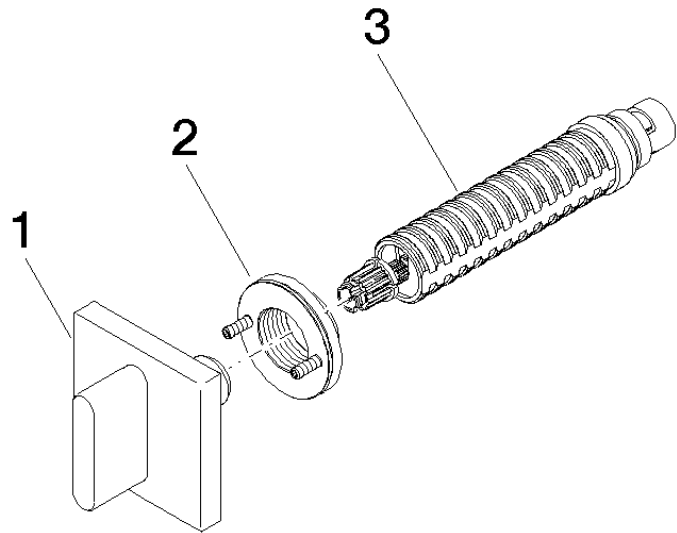

Spare parts list

No.	Item Number	Name	Quantity used	Delivery time
2	90 21 02 108 00 90	disc	1.00	2
1	90 20 70 051 01-19	handle	1.00	20
3	90 90 03 143 00 90	top	1.00	2