

DORNBACHT YARRE Washstand fitting with electronic opening and closing function without pop-up waste - Soft Black

DORNBACHT
YARRE

44 521 832	Product version from 10/1/2022		
	<ul style="list-style-type: none"> • Infrared sensor technology • 125mm projection • height of mixer 101 mm • height up to aerator 80 mm • hole diameter 35 mm • fixed spout • max. flow 5.7 l/min • circular, air-enriched flow • suitable for thermal disinfection • Automatic shut-off after pre-set time is reached • Indirect temperature control (undercounter) • Control box included • Adjustable sensor detection range • Battery or plug-in power supply operated (batteries not included) • 4x AA (1.5V) batteries required • 1x screw-in M 8 x 1 pressure hose, leak-tested • WRAS 	<div> <div></div> <div>Soft Black</div> </div> <div> <div></div> <div>Chrome</div> </div>	<div>44 521 832-69</div> <div>44 521 832-00</div>
			
	Batteries not included		

DORNBRAUCHT YARRE Washstand fitting with electronic opening and closing function without pop-up waste - Soft Black

DORNBRAUCHT
YARRE

44 521 832 Product version from 10/1/2022

mm [inches]

1:5

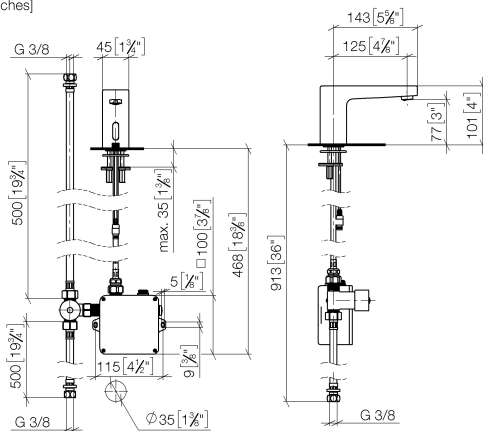

Flow rate chart

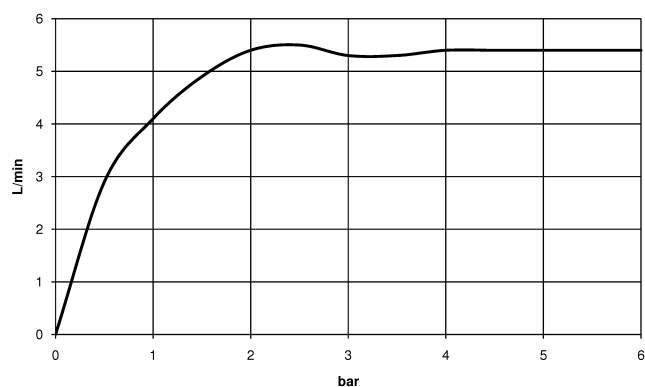

Codes & Standards

DIN 4109

EN 1717

ISO 3822

Scottish Water
Byelaws

UK Water Supply
Regulations

Ü-Zeichen



DORNBACHT YARRE Washstand fitting with electronic opening and closing function without pop-up waste - Soft Black

DORNBACHT
YARRE

44 521 832 Product version from 10/1/2022

Certificates and sustainability

LGA_38

Belgaqua_23-210-2 WRAS_2211

DORNBACHT YARRE Washstand fitting with electronic opening and closing function without pop-up waste - Soft Black

DORNBACHT
YARRE

44 521 832 Product version from 10/1/2022

Parts for other
finishes can be found
here: [Chrome](#)

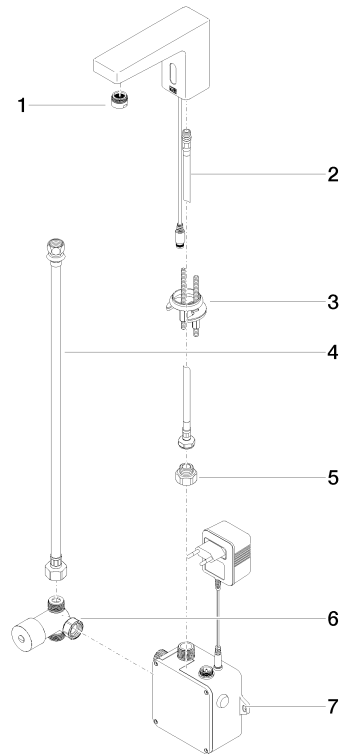

Spare parts list

No.	Item Number	Name	Quantity used	Delivery time
5	09 24 03 185-00	nipple	1.00	10
6	90 30 50 081 00 90	valve	1.00	2
2	04 30 04 105 00 90	hose	1.00	2
4	12 506 970 90	High pressure hoses -	1.00	2
3	90 30 11 504 00 90	fixing set	1.00	2
1	90 23 01 177 00-69	aerator	1.00	2
7	90 10 01 247 00 90	valve box	1.00	2