

TARA Single-hole mixer - Brushed Durabronz (23kt Gold)

TARA

22 815 892 Product version from 6/30/2009 to 5/27/2021



- 235mm projection
- pivotable spout 360°
- air-enriched flow
- height of mixer 378 mm
- height up to aerator 220 mm
- hole diameter 35 mm
- max. flow 7 l/min at 3 bar flow pressure
- lead-free
- This product can help a building meet the requirements of Green Building Rating Systems, e.g. LEED®, BREEAM®, DGNB
- WRAS

| | | |
|---|-------------------------------|---------------|
|  | Brushed Durabronz (23kt Gold) | 22 815 892-28 |
|  | Chrome | 22 815 892-00 |
|  | Brushed Platinum | 22 815 892-06 |
|  | Platinum | 22 815 892-08 |
|  | Durabronz (23kt Gold) | 22 815 892-09 |
|  | Dark Chrome | 22 815 892-19 |
|  | Matte Black | 22 815 892-33 |
|  | Brushed Bronze | 22 815 892-42 |
|  | Brushed Champagne (22kt Gold) | 22 815 892-46 |
|  | Champagne (22kt Gold) | 22 815 892-47 |
|  | Brushed Chrome | 22 815 892-93 |
|  | Brushed Dark Platinum | 22 815 892-99 |

Recommended miscellaneous

Strainer waste with control handle 10 710 970-28
- Brushed Durabronz (23kt Gold)



TARA Single-hole mixer - Brushed Durabron (23kt Gold)

TARA

22 815 892 Product version from 6/30/2009 to 5/27/2021

mm [inches]

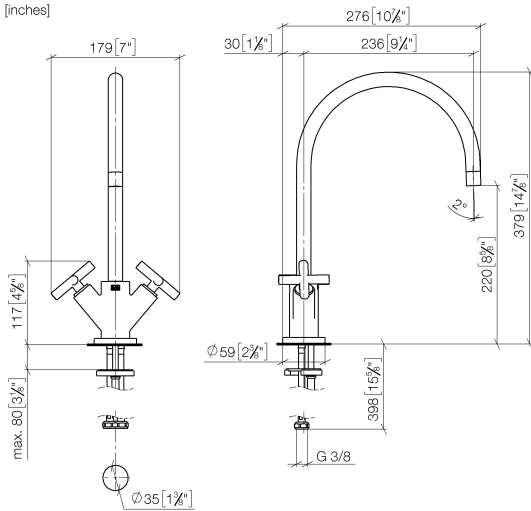

Flow rate chart



Codes & Standards

| | | | |
|---------------------------|--------------------------------|-----------------------------|------------|
| DIN 4109 | EN 200 | Executive Order no. 1007 | ISO 3822 |
| Scottish Water Byelaws | UK Water Supply Regulations | Ü-Zeichen | VA-Zeichen |



TARA Single-hole mixer - Brushed Durabrass (23kt Gold)

TARA

22 815 892 Product version from 6/30/2009 to 5/27/2021

Certificates and sustainability

ETA_18 LGA_19 GDV_0400 WRAS_240702

TARA Single-hole mixer - Brushed Durabron (23kt Gold)

TARA

22 815 892 Product version from 6/30/2009 to 5/27/2021

Parts for other
finishes can be found
here: [Chrome](#)



Spare parts list

| No. | Item Number | Name | Quantity used | Delivery time |
|-----|-----------------------|------------|---------------|---------------|
| | 12 04 30 11 038 00 90 | fixing set | 1.00 | 2 |
| | 10 09 28 10 132-28 | ring | 1.00 | 20 |
| | 4 90 12 12 007 00-28 | base | 2.00 | 20 |
| | 8 09 30 30 054 90 | screw | 1.00 | 2 |
| | 7 90 90 03 151 00 90 | top | 2.00 | 2 |
| | 11 09 14 10 134 90 | seal | 1.00 | 2 |
| | 13 09 31 11 012 90 | pin | 1.00 | 2 |
| | 3 09 20 89 010-28 | handle | 2.00 | 60 |
| | 9 04 30 04 104 00 90 | hose | 2.00 | 2 |
| | 1 90 28 22 226 01-28 | spout | 1.00 | 20 |
| | 6 90 30 30 075 00 90 | screw | 2.00 | 2 |
| | 2 90 20 89 010 10-28 | handle | 2.00 | 20 |
| | 5 90 30 11 029 00 90 | disc | 2.00 | 2 |