



## Rain shower:

- rain shower Ø 200 mm
- overhead shower: rain flow
- max. rainshower flow 14 l/min
- Function from: 8 l/min

## hand shower:

## Control element:

- rotary diverter for fixed-riser shower/hand shower
- metal shower hose 1250mm with integrated anti-twist protection

## Technical data:

- shower with fixed riser projection 420mm
- height of fittings up to rain shower (bottom edge) 1009mm
- height of fittings up to top edge of elbow 1180mm
- rosette for wall mounting Ø 70mm
- rosette for shower mixer Ø 60mm
- rosette for shower holder Ø 66mm
- Pipe diameter 20 mm
- gauge 150 mm - 13 mm
- 1/2" connection

## Notes:







- This product can help a building meet the requirements of Green Building Rating Systems, e.g. LEED®, BREEAM®, DGNB

**This article does not include a hand shower!**

**Intrinsic protection against back flow.**

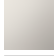
This article does not include a hand shower!

Intrinsic protection against back flow.

|   |                               |               |
|---|-------------------------------|---------------|
|  | Chrome                        | 26 632 360-00 |
|  | Brushed Platinum              | 26 632 360-06 |
|  | Platinum                      | 26 632 360-08 |
|  | Durabrand (23kt Gold)         | 26 632 360-09 |
|  | Brushed Durabrand (23kt Gold) | 26 632 360-28 |
|  | Brushed Dark Brass            | 26 632 360-39 |
|  | Brushed Dark Platinum         | 26 632 360-99 |

## Required miscellaneous



**MADISON Hand shower - Chrome** 28 002 978-00  
 • spray head Ø 95mm  
 • Hand shower see page {PAGE}  
 • Three settings: COMPACT RAIN, COMPACT SOFT FLOW, COMPACT AQUAPRESSURE FLOW, max. flow rate l/min (at 3 bar)

## Required miscellaneous



**MADISON Hand shower FlowReduce - Chrome** 28 002 978-00 0010  
 • spray head Ø 95mm  
 • Hand shower see page {PAGE}  
 • Three settings: COMPACT RAIN, COMPACT SOFT FLOW, COMPACT AQUAPRESSURE FLOW, max. flow rate l/min (at 3 bar)

## Required miscellaneous



**MADISON Metal hand shower with porcelain insert (white)** 28 002 970-00 0010  
**FlowReduce - Chrome**

26 632 360 Product version from 7/1/2025

mm [inches]

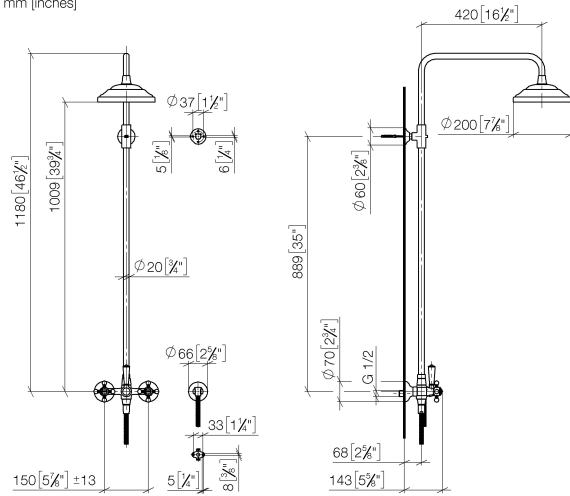

**Flow rate chart**

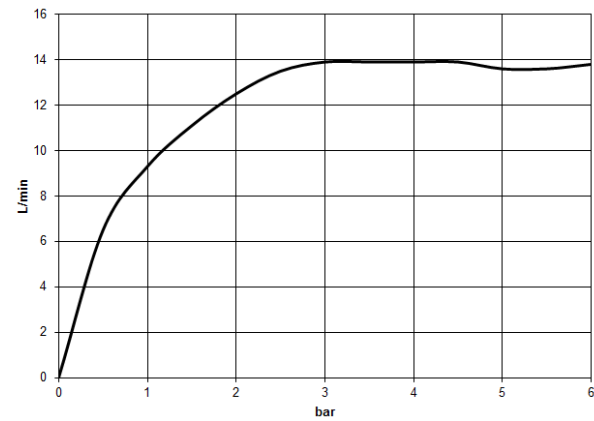

**Codes & Standards**

DIN 4109

EN 1717

ISO 3822

Scottish Water  
Byelaws

UK Water Supply  
Regulations

Ü-Zeichen



## MADISON Showerpipe with shower mixer without hand shower - Chrome

---

MADISON

26 632 360 Product version from 7/1/2025

### Certificates and sustainability

---

Belgaqua\_21-023-2 LGA\_29

WRAS\_2204

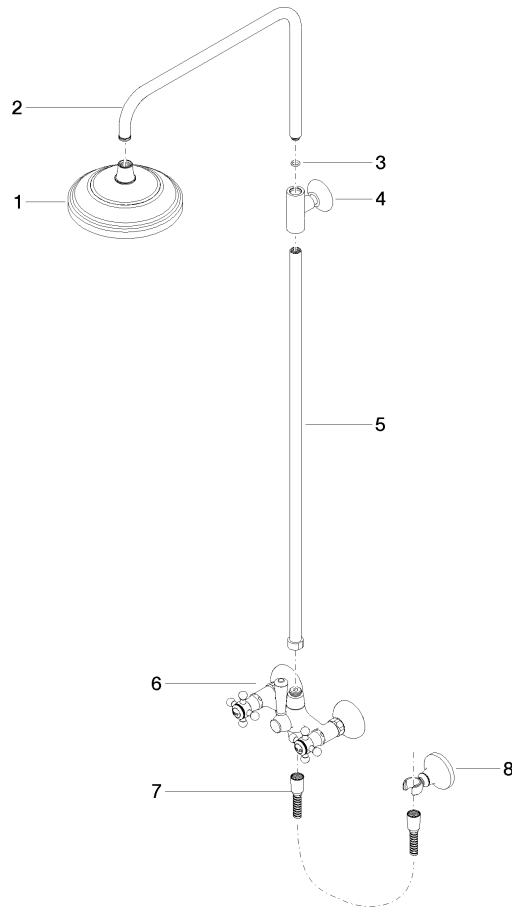

## Spare parts list

| No. | Item Number        | Name   | Quantity used | Delivery time |
|-----|--------------------|--|---------------|---------------|
| 6   | 04 17 10 001 00-00 | fitting  | 1.00          | 60            |
| 8   | 28 050 410-00      | holder   | 1.00          | 60            |
| 4   | 90 17 11 033 00-00 | holder   | 1.00          | 10            |
| 5   | 90 28 22 096 00-00 | pipe   | 1.00          | 10            |
| 7   | 28 104 970-00      | Metal shower hose 1/2" x 1/2" x 1250 mm - Chrome | 1.00          | 2             |
| 2   | 04 28 22 101 20-00 | spout  | 1.00          | 10            |
| 3   | 90 14 10 011 00 90 | seal   | 1.00          | 2             |
| 1   | 04 12 05 038 01-00 | shower   | 1.00          | 10            |