

# MADISON Showerpipe with shower mixer without hand shower - Brushed Dark Brass

MADISON

26 632 360 Product version from 7/1/2025



## Rain shower:

- rain shower Ø 200 mm
- overhead shower: rain flow
- max. rainshower flow 14 l/min
- Function from: 8 l/min

## hand shower:

## Control element:

- rotary diverter for fixed-riser shower/hand shower
- metal shower hose 1250mm with integrated anti-twist protection

## Technical data:







- shower with fixed riser projection 420mm
- height of fittings up to rain shower (bottom edge) 1009mm
- height of fittings up to top edge of elbow 1180mm
- rosette for wall mounting Ø 70mm
- rosette for shower mixer Ø 60mm
- rosette for shower holder Ø 66mm
- Pipe diameter 20 mm
- gauge 150 mm - 13 mm
- 1/2" connection

## Notes:

- This product can help a building meet the requirements of Green Building Rating Systems, e.g. LEED®, BREEAM®, DGNB

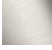
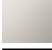
This article does not include a hand shower!

Intrinsic protection against back flow.

	Brushed Dark Brass	26 632 360-39
	Chrome	26 632 360-00
	Brushed Platinum	26 632 360-06
	Platinum	26 632 360-08
	Durabrass (23kt Gold)	26 632 360-09
	Brushed Durabrass (23kt Gold)	26 632 360-28
	Brushed Dark Platinum	26 632 360-99

# MADISON Showerpipe with shower mixer without hand shower - Brushed Dark Brass

MADISON

26 632 360 Product version from 7/1/2025  
mm [inches]

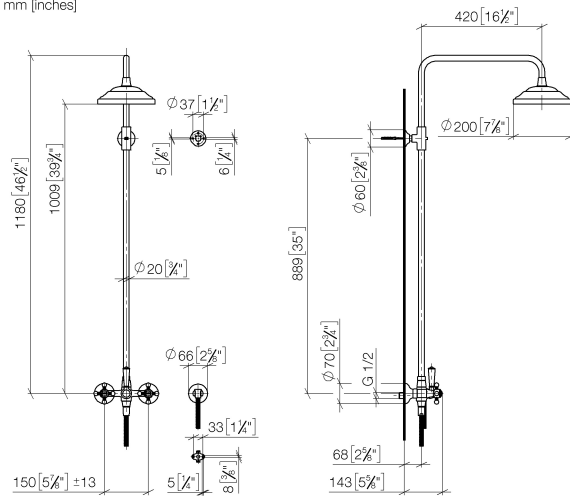

Flow rate chart

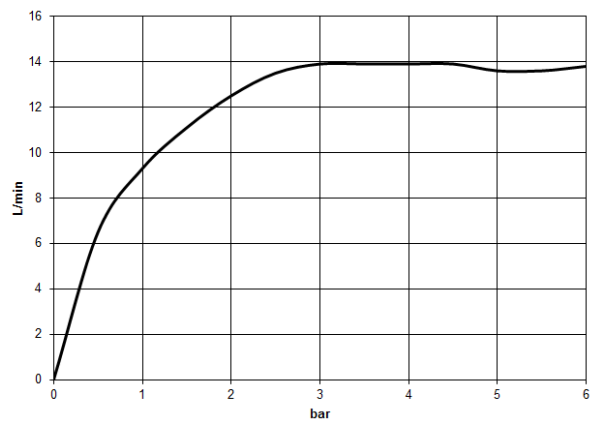

## Codes & Standards

DIN 4109

ISO 3822

Ü-Zeichen



## MADISON Showerpipe with shower mixer without hand shower - Brushed Dark Brass

MADISON

---

26 632 360 Product version from 7/1/2025

Certificates and sustainability

---

LGA\_29

# MADISON Showerpipe with shower mixer without hand shower - Brushed Dark Brass

MADISON

26 632 360 Product version from 7/1/2025

Parts for other finishes can be found here: [Chrome](#)

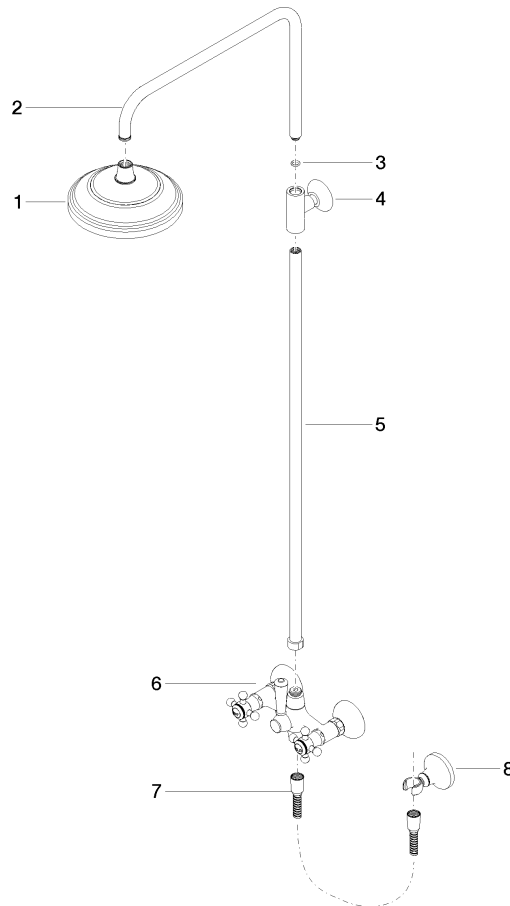

## Spare parts list

No.	Item Number	Name	Quantity used	Delivery time
6	04 17 10 001 00-39	fitting	1.00	-
Spare part can no longer be ordered, please order the replacement item				
3	90 14 10 011 00 90	seal	1.00	2
1	04 12 05 038 01-39	shower	1.00	-
Spare part can no longer be ordered, please order the replacement item				
7	28 104 970-39	Metal shower hose 1/2" x 1/2" x 1250 mm - Brushed Dark Brass	1.00	30
4	90 17 11 033 00-39	holder	1.00	30
8	28 050 410-39	holder	1.00	-
Spare part can no longer be ordered, please order the replacement item				
5	90 28 22 096 00-39	pipe	1.00	30
2	04 28 22 101 20-39	spout	1.00	60