

# Shower head - Light Gold

28 504 979    Product version from 10/1/2023



- 180-210mm projection
- ball-joint pivotable through 30°
- PURIFY RAIN, max. flow rate 7 l/min (at 3 bar)
- Function from: 6 l/min
- with anti-scale system
- spray head Ø 100mm
- rosette Ø 55 mm
- 1/2" connection

|   |                               |               |
|---|-------------------------------|---------------|
|    | Light Gold                    | 28 504 979-26 |
|    | Chrome                        | 28 504 979-00 |
|    | Brushed Platinum              | 28 504 979-06 |
|    | Platinum                      | 28 504 979-08 |
|    | Dark Chrome                   | 28 504 979-19 |
|    | Brushed Light Gold            | 28 504 979-27 |
|    | Brushed Durabrass (23kt Gold) | 28 504 979-28 |
|    | Matte Black                   | 28 504 979-33 |
|    | Brushed Bronze                | 28 504 979-42 |
|   | Brushed Champagne (22kt Gold) | 28 504 979-46 |
|  | Champagne (22kt Gold)         | 28 504 979-47 |
|  | Brushed Chrome                | 28 504 979-93 |
|  | Brushed Dark Platinum         | 28 504 979-99 |

# Shower head - Light Gold

28 504 979 Product version from 10/1/2023

mm [inches]

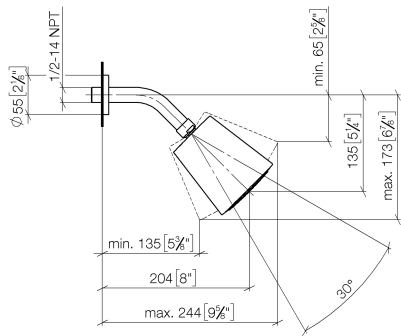

## Flow rate chart



## Codes & Standards

DIN 4109

EN 1112

ISO 3822

Ü-Zeichen



## Shower head - Light Gold

---

28 504 979 Product version from 10/1/2023

### Certificates

---

DVGW\_DW- LGA\_19  
6517DN0

# Shower head - Light Gold

28 504 979    Product version from 10/1/2023

Parts for other  
finishes can be found  
here: [Chrome](#)

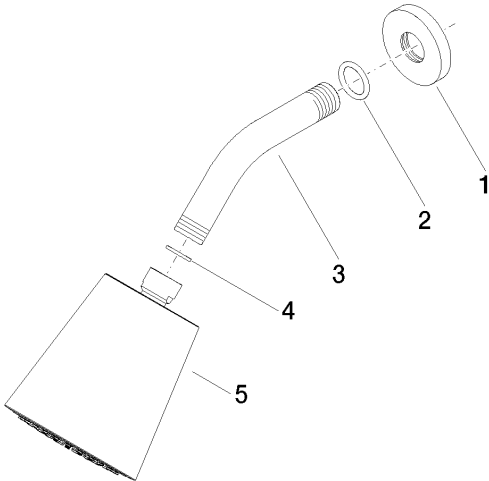

## Spare parts list

| No. | Item Number        | Name       | Quantity used | Delivery time |
|-----|--------------------|------------|---------------|---------------|
| 1   | 09 27 22 503-26    | rosette    | 1             | 60            |
| 2   | 90 14 10 026 00 90 | seal       | 1             | 2             |
| 3   | 09 11 03 011-26    | connection | 1             | 60            |
| 4   | 90 14 20 002 00 90 | seal       | 1             | 2             |
| 5   | 90 12 05 054 00-26 | shower     | 1             | 30            |