

Shower head - Dark Chrome

SERIES SPECIFIC

28 505 979



- 155mm projection
- ball-joint pivotable through 18° (in any direction)
- Three or five settings: COMPACT RAIN, COMPACT SOFT FLOW, COMPACT AQUAPRESSURE FLOW, max. flow rate 7.6 l/min (at 3 bar)
- with anti-scale system
- spray head Ø 100mm
- rosette Ø 60 mm
- 1/2" connection
- Function from: 5.5 l/min
- WRAS

| | | |
|---|-------------------------------|---------------|
|  | Dark Chrome | 28 505 979-19 |
|  | Chrome | 28 505 979-00 |
|  | Brushed Platinum | 28 505 979-06 |
|  | Platinum | 28 505 979-08 |
|  | Light Gold | 28 505 979-26 |
|  | Brushed Light Gold | 28 505 979-27 |
|  | Brushed Durabrass (23kt Gold) | 28 505 979-28 |
|  | Matte Black | 28 505 979-33 |
|  | Brushed Bronze | 28 505 979-42 |
|  | Brushed Champagne (22kt Gold) | 28 505 979-46 |
|  | Champagne (22kt Gold) | 28 505 979-47 |
|  | Brushed Chrome | 28 505 979-93 |
|  | Brushed Dark Platinum | 28 505 979-99 |

Recommended miscellaneous

- Concealed wall elbow -** 35 085 970 90
- max. recess depth 163 mm
 - min. recess depth 90 mm



28 505 979

mm [inches]

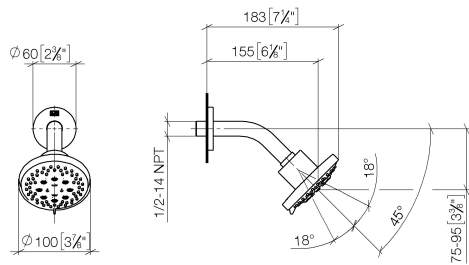

Flow rate chart

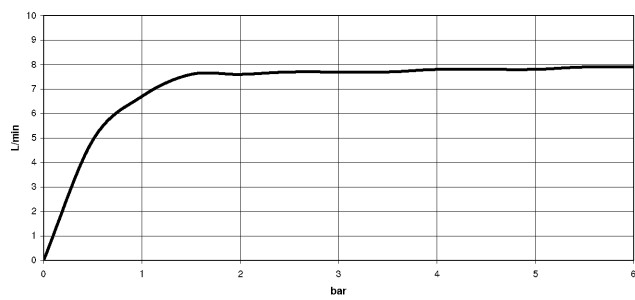

Codes & Standards

DIN 4109

ISO 3822

Scottish Water
Byelaws

UK Water Supply
Regulations

Ü-Zeichen



Shower head - Dark Chrome

SERIES SPECIFIC

28 505 979

Certificates and sustainability

LGA_28

WRAS_2201

28 505 979

