

Showerpipe with shower thermostat without hand shower FlowReduce - Brushed Bronze

SERIES SPECIFIC

34 459 979 Product version from 4/1/2024



- shower with fixed riser projection 453mm
- overhead shower: rain flow
- rain shower Ø 220 mm
- rain shower with anti-scale system
- max. rainshower flow 7 l/min
- rotary diverter with volume control and shut-off function
- slide-on rosettes Ø 70 mm
- height of fittings up to rain shower (bottom edge) 1009mm
- height of fittings up to top edge of elbow 1150mm
- gauge 150 mm - 13 mm
- metal shower hose 1750mm with integrated anti-twist protection
- 1/2" connection
- slide bar
- Pipe diameter 23.5 mm
- quick clearing
- This product can help a building meet the requirements of Green Building Rating Systems, e.g. LEED®, BREEAM®, DGNB
- WRAS

This article does not include a hand shower!

Intrinsic protection against back flow.

| | | |
|--|--------------------------------|---------------|
| | Brushed Bronze | 34 459 979-42 |
| | Chrome | 34 459 979-00 |
| | Brushed Platinum | 34 459 979-06 |
| | Platinum | 34 459 979-08 |
| | Dark Chrome | 34 459 979-19 |
| | Light Gold | 34 459 979-26 |
| | Brushed Light Gold | 34 459 979-27 |
| | Brushed Durabronze (23kt Gold) | 34 459 979-28 |
| | Matte Black | 34 459 979-33 |
| | Brushed Champagne (22kt Gold) | 34 459 979-46 |
| | Champagne (22kt Gold) | 34 459 979-47 |
| | Brushed Chrome | 34 459 979-93 |
| | Brushed Dark Platinum | 34 459 979-99 |

Required miscellaneous

| | | |
|--|--|-----------------------|
| | Hand shower FlowReduce - Brushed Bronze | 28 012 979-42 0010 |
|--|--|-----------------------|

Required miscellaneous

| | | |
|--|-------------------------------------|---------------|
| | Hand shower - Brushed Bronze | 28 016 979-42 |
|--|-------------------------------------|---------------|

Required miscellaneous

| | | |
|--|--|-----------------------|
| | Hand shower FlowReduce - Brushed Bronze | 28 016 979-42 0010 |
|--|--|-----------------------|

Required miscellaneous

| | | |
|--|--|-----------------------|
| | Hand shower FlowReduce - Brushed Bronze | 28 018 979-42 0010 |
|--|--|-----------------------|

Required miscellaneous

| | | |
|--|-------------------------------------|---------------|
| | Hand shower - Brushed Bronze | 28 012 979-42 |
|--|-------------------------------------|---------------|

Required miscellaneous

| | | |
|--|-------------------------------------|---------------|
| | Hand shower - Brushed Bronze | 28 017 979-42 |
|--|-------------------------------------|---------------|

Required miscellaneous

| | | |
|--|-------------------------------------|---------------|
| | Hand shower - Brushed Bronze | 28 018 979-42 |
|--|-------------------------------------|---------------|

Showerpipe with shower thermostat without hand shower FlowReduce -
Brushed Bronze

SERIES SPECIFIC

34 459 979 Product version from 4/1/2024

mm [inches]
1:10

1:10

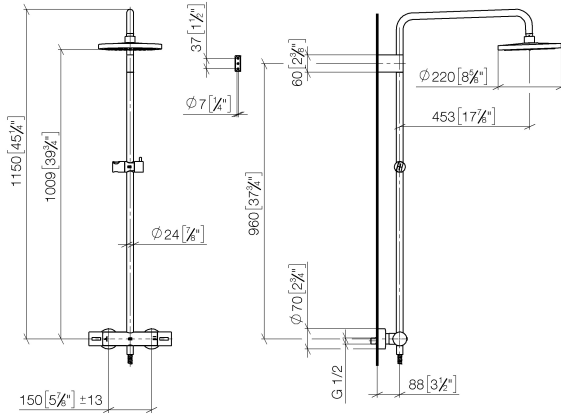

Flow rate chart



Codes & Standards

DIN 4109

ISO 3822

Scottish Water Byelaws

UK Water Supply Regulations

Ü-Zeichen



Showerpipe with shower thermostat without hand shower FlowReduce - Brushed Bronze

SERIES SPECIFIC

34 459 979 Product version from 4/1/2024

Certificates and sustainability

WRAS_2204

LGA_38

Showerpipe with shower thermostat without hand shower FlowReduce - Brushed Bronze

SERIES SPECIFIC

34 459 979 Product version from 4/1/2024

Parts for other
finishes can be found
here: [Chrome](#)

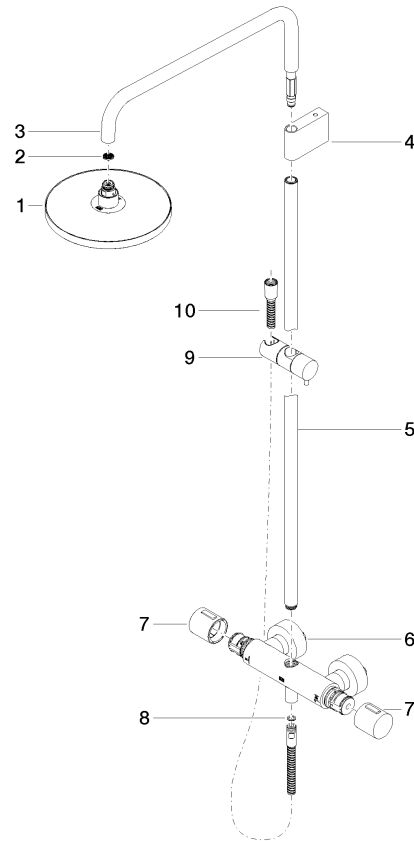

Spare parts list

| No. | Item Number | Name | Quantity used | Delivery time |
|-----|----------------------|--|---------------|---------------|
| | 4 90 17 11 150 00-42 | holder | 1.00 | 30 |
| | 1 90 12 05 092 20-42 | shower | 1.00 | 30 |
| | 2 09 23 01 039 90 | sieve | 1.00 | 2 |
| | 3 90 28 22 348 00-42 | pipe | 1.00 | 30 |
| | 9 12 570 970-42 | Slide unit - Brushed Bronze | 1.00 | 30 |
| | 5 90 28 22 349 00-42 | pipe | 1.00 | 30 |
| | 10 28 322 970-42 | Metal shower hose 1/2" x 3/8" x 1750 mm - Brushed Bronze | 1.00 | 30 |
| | 6 04 17 01 250 00-42 | connection | 1.00 | 60 |
| | 8 90 14 20 026 00 90 | seal | 1.00 | 2 |
| | 7 90 17 33 015 00-42 | handle | 2.00 | 30 |