







## MEM Bath spout without diverter for free-standing assembly - Chrome

MEM

13 672 780 Product version from 9/30/2005



- 280mm projection
- cascade
- total height 830 - 900 mm
- height up to aerator 665 – 735 mm
- push-on rosette 130 x 130 mm
- max. flow 47.8 l/min at 3 bar flow pressure
- WRAS

|   |                                |               |
|---|--------------------------------|---------------|
|  | Chrome                         | 13 672 780-00 |
|  | Brushed Platinum               | 13 672 780-06 |
|  | Platinum                       | 13 672 780-08 |
|  | Dark Chrome                    | 13 672 780-19 |
|  | Brushed Durabronze (23kt Gold) | 13 672 780-28 |
|  | Brushed Champagne (22kt Gold)  | 13 672 780-46 |
|  | Champagne (22kt Gold)          | 13 672 780-47 |

### Required miscellaneous



- Concealed floor mounting -**
- max. recess depth 150 mm
  - min. recess depth 80 mm

35 945 970 90

## MEM Bath spout without diverter for free-standing assembly - Chrome

MEM

13 672 780 Product version from 9/30/2005

mm [inches]



### Flow rate chart

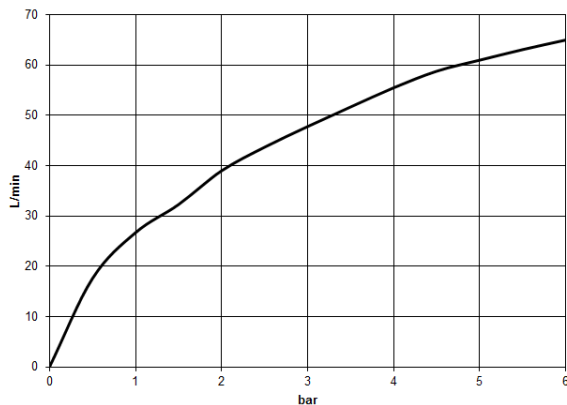

### Codes & Standards

|                |      |          |          |
|----------------|------|----------|----------|
| ASME A112.18.1 | cUPC | DIN 4109 | ISO 3822 |
|----------------|------|----------|----------|

|                           |                                |           |
|---------------------------|--------------------------------|-----------|
| Scottish Water<br>Byelaws | UK Water Supply<br>Regulations | Ü-Zeichen |
|---------------------------|--------------------------------|-----------|



MEM Bath spout without diverter for free-standing assembly - Chrome

MEM

13 672 780    Product version from 9/30/2005

Certificates and sustainability

|            |           |        |             |
|------------|-----------|--------|-------------|
| IAPMO_4976 | WRAS_2005 | LGA_18 | WRAS_250602 |
|------------|-----------|--------|-------------|

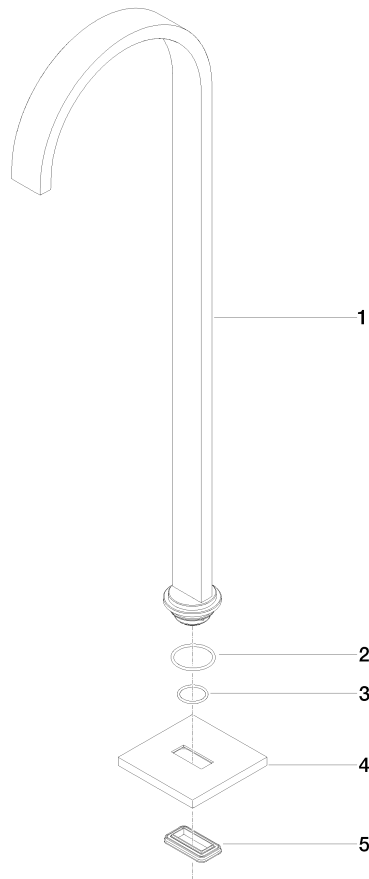

**Spare parts list**

| No. | Item Number        | Name    | Quantity used | Delivery time |
|-----|--------------------|---------|---------------|---------------|
| 5   | 09 14 03 106 90    | seal    | 1.00          | 2             |
| 2   | 09 14 10 084 90    | seal    | 1.00          | 2             |
| 1   | 04 28 22 183 00-00 | spout   | 1.00          | 60            |
| 4   | 09 27 78 022-00    | rosette | 1.00          | 10            |
| 3   | 09 14 10 018 90    | seal    | 1.00          | 2             |