

## MEM Bath spout for wall mounting - Platinum

MEM

13 801 782 Product version from 3/10/2014



- 220mm projection
- rectangular, air-enriched flow
- rosette 60 x 60 mm
- hole diameter 37 mm
- 1/2" connection
- max. flow 38.5 l/min at 3 bar flow pressure
- WRAS

|   |                                     |               |
|---|-------------------------------------|---------------|
|  | Platinum                            | 13 801 782-08 |
|  | Chrome                              | 13 801 782-00 |
|  | Brushed Platinum                    | 13 801 782-06 |
|  | Dark Chrome                         | 13 801 782-19 |
|  | Brushed Durabronze<br>(23kt Gold)   | 13 801 782-28 |
|  | Brushed Dark<br>Brass               | 13 801 782-39 |
|  | Brushed<br>Champagne (22kt<br>Gold) | 13 801 782-46 |
|  | Champagne (22kt<br>Gold)            | 13 801 782-47 |
|  | Brushed Dark<br>Platinum            | 13 801 782-99 |

### Recommended miscellaneous



#### **Concealed wall elbow -**

35 085 970 90

- max. recess depth 163 mm
- min. recess depth 90 mm

## MEM Bath spout for wall mounting - Platinum

MEM

13 801 782 Product version from 3/10/2014

mm [inches]



### Flow rate chart



### Codes & Standards

ASME A112.18.1

cUPC

Scottish Water  
Byelaws

UK Water Supply  
Regulations



## MEM Bath spout for wall mounting - Platinum

---

MEM

13 801 782 Product version from 3/10/2014

### Certificates and sustainability

---

WRAS\_2203

IAPMO\_4976

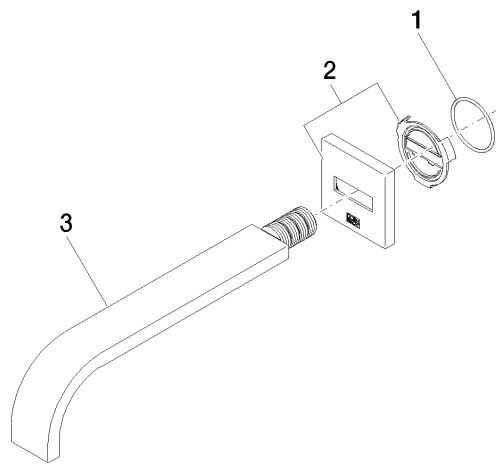

Spare parts list

| No. | Item Number        | Name    | Quantity used | Delivery time |
|-----|--------------------|---------|---------------|---------------|
| 1   | 09 14 10 111 90    | seal    | 1.00          | 2             |
| 2   | 90 27 78 035 00-08 | rosette | 1.00          | 40            |
| 3   | 04 28 22 290 00-08 | spout   | 1.00          | 40            |