

TARA Bath shower set for bath rim or tile edge installation - Chrome

TARA

27 512 882 Product version from 4/1/2024



- spout: circular, air-enriched flow
- max. flow 23.5 l/min at 3 bar flow pressure
- Hand shower: COMPACT RAIN, max. flow rate 6.8 l/min (at 3 bar)
- complete hand shower set with anti-scale system
- 220mm projection
- with anti-scale system
- automatic bath/shower diverter
- height of mixer 290 mm
- height up to aerator 135 mm
- hole diameter valve 32 mm
- hole diameter spout 32 mm
- hole diameter for complete hand shower set 32 mm
- rosette for spout Ø 55mm
- rosette for complete hand shower set Ø 50mm
- rosette for deck valve Ø 55mm
- metal shower hose 1750mm with integrated anti-twist protection

Available with 260 mm or 300 mm projection on request (x-TRA SERVICE).

Intrinsic protection against back flow.

| | | |
|---|-------------------------------|---------------|
|  | Chrome | 27 512 882-00 |
|  | Brushed Platinum | 27 512 882-06 |
|  | Platinum | 27 512 882-08 |
|  | Dark Chrome | 27 512 882-19 |
|  | Brushed Durabrass (23kt Gold) | 27 512 882-28 |
|  | Matte Black | 27 512 882-33 |
|  | Brushed Bronze | 27 512 882-42 |
|  | Brushed Champagne (22kt Gold) | 27 512 882-46 |
|  | Champagne (22kt Gold) | 27 512 882-47 |
|  | Brushed Chrome | 27 512 882-93 |
|  | Brushed Dark Platinum | 27 512 882-99 |

Recommended miscellaneous



Perfecto installation kit -

12 614 970 90

Recommended miscellaneous



Decorative caps for Perfecto - Chrome

- 1 pair

12 801 970-00

27 512 882 Product version from 4/1/2024

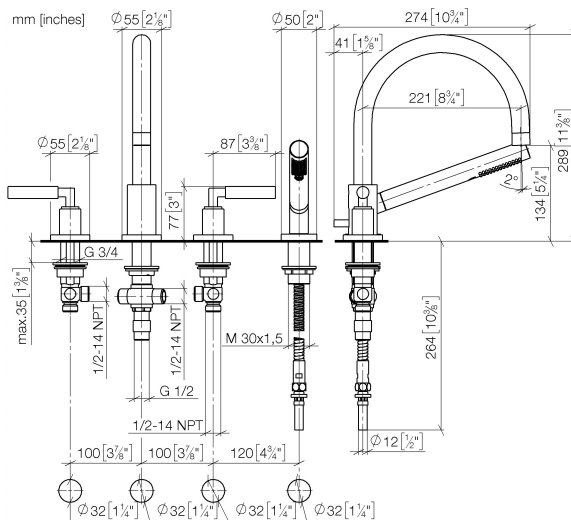

Flow rate chart

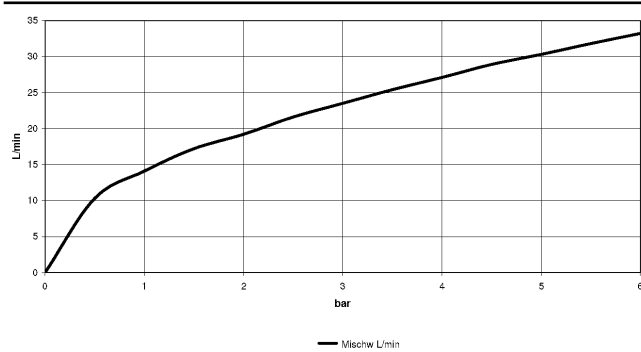

Codes & Standards

ASME A112.18.1

cUPC

DIN 4109

EN 1717

ISO 3822

Ü-Zeichen



TARA Bath shower set for bath rim or tile edge installation - Chrome

TARA

27 512 882 Product version from 4/1/2024

Certificates and sustainability

IAPMO_4976

LGA_18

Belgaqua_21-026-2

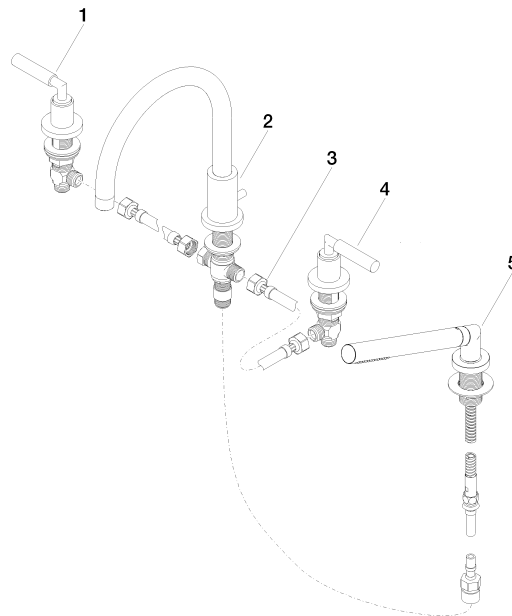

Spare parts list

| No. | Item Number | Name | Quantity used | Delivery time |
|--|---------------|---|---------------|---------------|
| 1 | 20 000 882-00 | TARA Deck valve clockwise closing - Chrome | 1.00 | - |
| Spare part can no longer be ordered, please order the replacement item | | | | |
| 2 | 13 512 892-00 | spout | 1.00 | 60 |
| 5 | 27 702 979-00 | Hand shower set for bath rim or tile edge installation - Chrome | 1.00 | 10 |
| 4 | 20 000 883-00 | TARA Deck valve anti-clockwise closing - Chrome | 1.00 | - |
| Spare part can no longer be ordered, please order the replacement item | | | | |
| 3 | 12 502 970 90 | High pressure hose 1/2" x 1/2" x 400 mm - | 2.00 | 2 |