





LULU Bath spout for wall mounting - Chrome

13 801 710 Product version from 3/31/2009



- 200mm projection
- circular normal flow
- hole diameter 37 mm
- 1/2" connection
- plug-link mounting
- max. flow 23.5 l/min at 3 bar flow pressure
- WRAS

	Chrome	13 801 710-00
	Brushed Platinum	13 801 710-06

Recommended miscellaneous



- | | |
|-------------------------------|---------------|
| Concealed wall elbow - | 35 085 970 90 |
| • min. recess depth mm | |
| • max. recess depth mm | |

LULU Bath spout for wall mounting - Chrome

13 801 710 Product version from 3/31/2009

mm [inches]

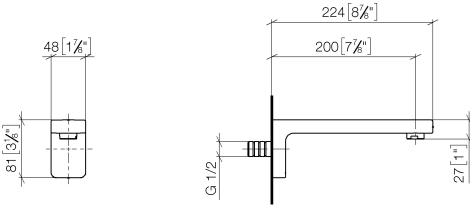

Flow rate chart

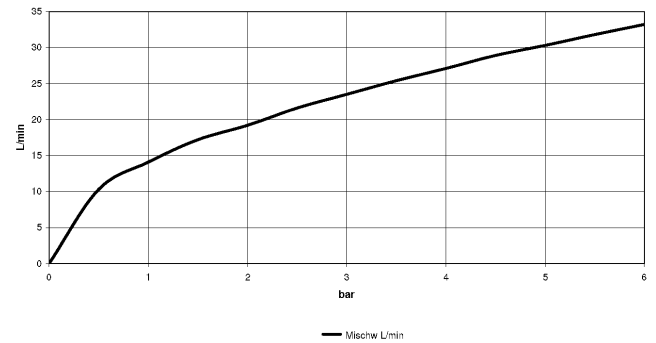

Codes & Standards

ASME A112.18.1	cUPC	DIN 4109	ISO 3822
Scottish Water Byelaws	UK Water Supply Regulations	Ü-Zeichen	



LULU Bath spout for wall mounting - Chrome

13 801 710 Product version from 3/31/2009

Certificates

LGA_9	IAPMO_4976	WRAS_2305
-------	------------	-----------

LULU Bath spout for wall mounting - Chrome

13 801 710 Product version from 3/31/2009

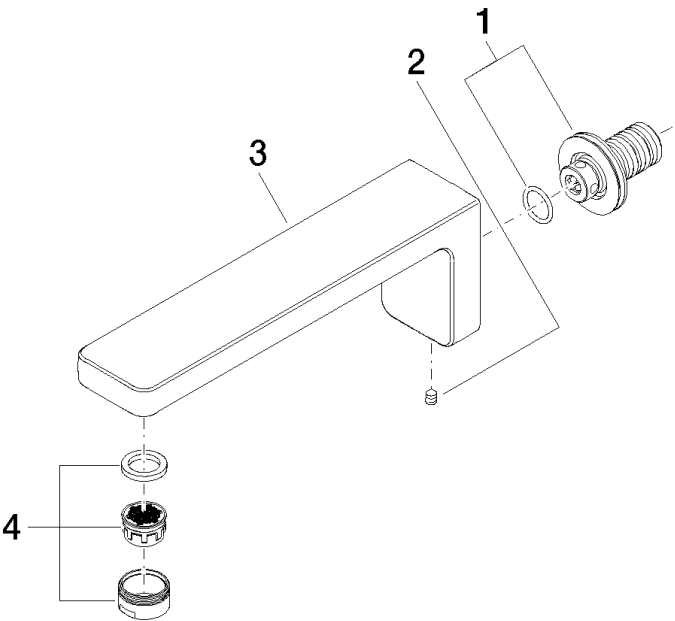

Spare parts list

No.	Item Number	Name	Quantity used	Delivery time
1	90 24 03 108 00 90	nipple set	1	2
2	90 31 11 004 00 90	pin	1	2
3	09 11 71 090 10-00	spout	1	10
4	90 23 01 118 00-00	aerator	1	10