

## MEM Bath spout for wall mounting - Brushed Dark Platinum

MEM

13 801 782 Product version from 3/10/2014



- 220mm projection
- rectangular, air-enriched flow
- rosette 60 x 60 mm
- hole diameter 37 mm
- 1/2" connection
- max. flow 38.5 l/min at 3 bar flow pressure
- WRAS

	Brushed Dark Platinum	13 801 782-99
	Chrome	13 801 782-00
	Brushed Platinum	13 801 782-06
	Platinum	13 801 782-08
	Dark Chrome	13 801 782-19
	Brushed Durabronze (23kt Gold)	13 801 782-28
	Brushed Dark Bronze	13 801 782-39
	Brushed Champagne (22kt Gold)	13 801 782-46
	Champagne (22kt Gold)	13 801 782-47

### Recommended miscellaneous



**Concealed wall elbow -**

- min. recess depth 90 mm
- max. recess depth 163 mm

35 085 970 90

## MEM Bath spout for wall mounting - Brushed Dark Platinum

MEM

13 801 782 Product version from 3/10/2014

mm [inches]

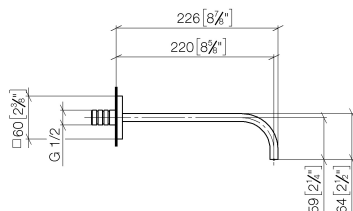

Flow rate chart

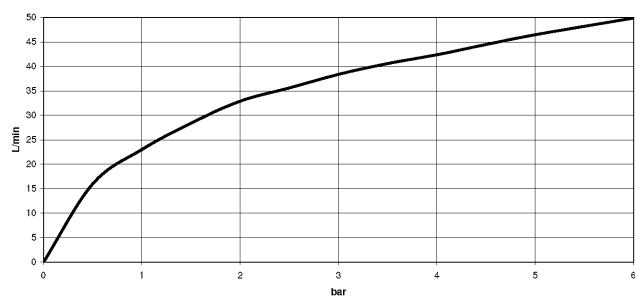

### Codes & Standards

ASME A112.18.1

cUPC

Scottish Water  
Byelaws

UK Water Supply  
Regulations



## MEM Bath spout for wall mounting - Brushed Dark Platinum

---

MEM

13 801 782 Product version from 3/10/2014

### Certificates and sustainability

---

WRAS\_2203

IAPMO\_4976

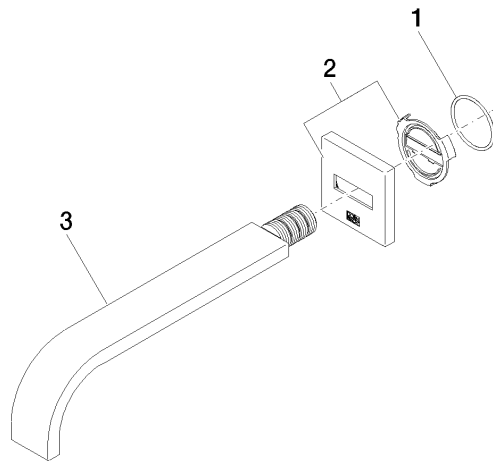

**Spare parts list**

No.	Item Number	Name	Quantity used	Delivery time
2	90 27 78 035 00-99	rosette	1.00	20
3	04 28 22 290 00-99	spout	1.00	20
1	09 14 10 111 90	seal	1.00	2