

## MEM Deck valve anti-clockwise closing hot - Platinum

MEM

20 000 783



- hole diameter 32 mm
- rosette 60 x 60 mm
- with hot marking
- WRAS 2103001

|                                                                                    |                                     |               |
|------------------------------------------------------------------------------------|-------------------------------------|---------------|
|  | Platinum                            | 20 000 783-08 |
|  | Chrome                              | 20 000 783-00 |
|  | Brushed Platinum                    | 20 000 783-06 |
|  | Dark Chrome                         | 20 000 783-19 |
|  | Brushed Durabronze<br>(23kt Gold)   | 20 000 783-28 |
|  | Brushed<br>Champagne (22kt<br>Gold) | 20 000 783-46 |
|  | Champagne (22kt<br>Gold)            | 20 000 783-47 |
|  | Brushed Dark<br>Platinum            | 20 000 783-99 |

20 000 783

mm [inches]

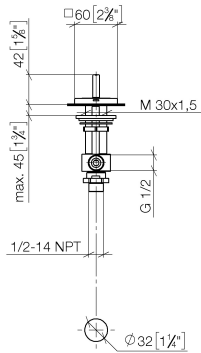

Flow rate chart



Codes & Standards

ASME A112.18.1

cUPC

Scottish Water  
Byelaws

UK Water Supply  
Regulations



## MEM Deck valve anti-clockwise closing hot - Platinum

---

MEM

20 000 783

### Certificates

---

IAPMO\_4976

WRAS\_2103

20 000 783

**Product version from 3/10/2014**

Parts for other  
finishes can be found  
here: Chrome

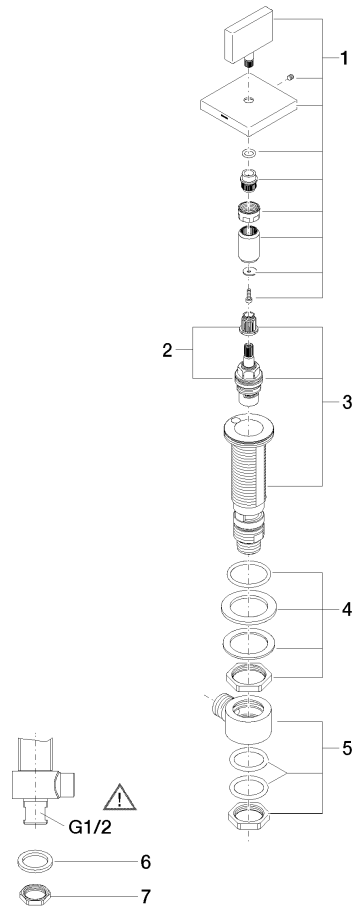



## MEM Deck valve anti-clockwise closing hot - Platinum

MEM

20 000 783

### Spare parts list

#### Product version from 3/10/2014

| No. | Item Number        | Name           | Quantity used | Delivery time |
|-----|--------------------|----------------|---------------|---------------|
|     | 90 20 78 002 05-08 | handle ( hot ) | 7             | 40            |