

META Single-lever basin mixer with stand pipe without pop-up waste - Chrome

META

22 584 661



- 202mm projection
- circular, air-enriched flow
- total height 1197 - 1267 mm
- height up to water outlet point 1098 mm
- rosette Ø 135 mm
- max. flow 5.7 l/min
- lead-free
- This product can help a building meet the requirements of Green Building Rating Systems, e.g. LEED®, BREEAM®, DGNB
- pivoting spout
- WRAS 240502021

| | | |
|--|-------------------------------|---------------|
|  | Chrome | 22 584 661-00 |
|  | Brushed Platinum | 22 584 661-06 |
|  | Dark Chrome | 22 584 661-19 |
|  | Light Gold | 22 584 661-26 |
|  | Brushed Light Gold | 22 584 661-27 |
|  | Matte Black | 22 584 661-33 |
|  | Brushed Bronze | 22 584 661-42 |
|  | Brushed Champagne (22kt Gold) | 22 584 661-46 |
|  | Champagne (22kt Gold) | 22 584 661-47 |
|  | Brushed Chrome | 22 584 661-93 |
|  | Brushed Dark Platinum | 22 584 661-99 |

Required miscellaneous



- Concealed floor mounting -**
- max. recess depth 150 mm
 - min. recess depth 80 mm

35 945 970 90

Required miscellaneous



- Concealed floor mounting -**
- max. recess depth 150 mm
 - min. recess depth 80 mm

35 945 970 90

22 584 661

mm [inches]

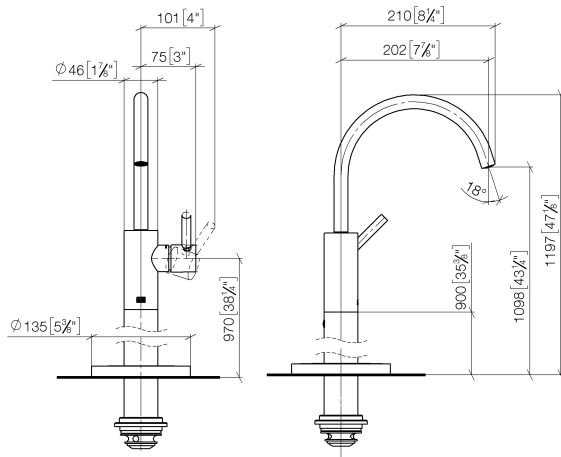

Flow rate chart



Codes & Standards

DIN 4109

ISO 3822

Scottish Water
Byelaws

UK Water Supply
Regulations

Ü-Zeichen



META Single-lever basin mixer with stand pipe without pop-up waste - Chrome

META

22 584 661

Certificates

LGA_38

WRAS_240502

Product version from 5/1/2022





META Single-lever basin mixer with stand pipe without pop-up waste - Chrome

META

22 584 661

Spare parts list

Product version from 5/1/2022

| No. | Item Number | Name | Quantity used | Delivery time |
|-----|--------------------|-------|---------------|---------------|
| | 90 28 22 313 00-00 | spout | 17 | 10 |