

## VAIA Shower set without hand shower - Chrome

VAIA

26 413 809



- slide bar
- rosette Ø 60 mm
- gauge 800 mm
- metal shower hose 1700mm with integrated anti-twist protection
- shower hose connector 3/8"
- Pipe diameter 18 mm
- WRAS 2009048

This article does not include a hand shower!

	Chrome	26 413 809-00
	Brushed Platinum	26 413 809-06
	Platinum	26 413 809-08
	Dark Chrome	26 413 809-19
	Brushed Durabronze (23kt Gold)	26 413 809-28
		26 413 809-39
	Brushed Bronze	26 413 809-42
		26 413 809-43
	Brushed Champagne (22kt Gold)	26 413 809-46
	Champagne (22kt Gold)	26 413 809-47
	Brushed Dark Platinum	26 413 809-99

## VAIA Shower set without hand shower - Chrome

VAIA

26 413 809

### Recommended miscellaneous



**Concealed wall elbow -**  
 • max. recess depth 163 mm  
 • min. recess depth 90 mm

35 085 970 90

### Recommended miscellaneous



**VAIA Wall elbow - Chrome**

28 450 809-00

### Required miscellaneous



**Hand shower FlowReduce - Chrome**

28 012 979-00  
0010

### Required miscellaneous



**Hand shower - Chrome**

28 012 979-00

### Required miscellaneous



**Hand shower - Chrome**

28 018 979-00

### Required miscellaneous



**SERIES-VARIOUS Hand shower - Chrome**

28 029 979-00

### Required miscellaneous



**SERIES-VARIOUS Hand shower FlowReduce - Chrome**

28 025 979-00  
0010

### Recommended miscellaneous



**VAIA Wall elbow - Chrome**

28 450 809-00

### Required miscellaneous



**Hand shower - Chrome**

28 017 979-00

### Required miscellaneous



**Hand shower - Chrome**

28 016 979-00

### Required miscellaneous



**Hand shower FlowReduce - Chrome**

28 016 979-00  
0010

### Required miscellaneous



**Hand shower FlowReduce - Chrome**

28 018 979-00  
0010

### Required miscellaneous



**SERIES-VARIOUS Hand shower FlowReduce - Chrome**

28 027 979-00  
0010

VAIA Shower set without hand shower - Chrome

VAIA

26 413 809

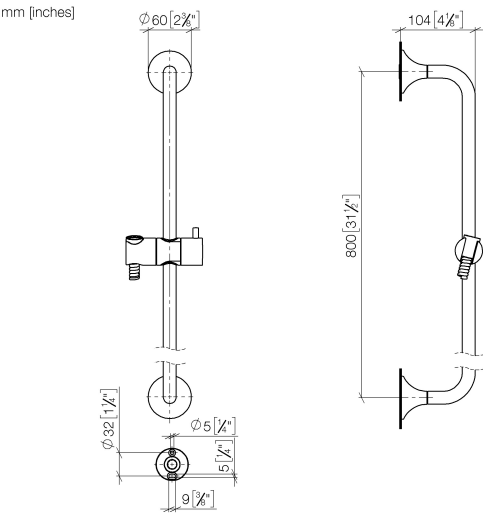

Codes & Standards

ASME A112.18.1	cUPC	Scottish Water Byelaws	UK Water Supply Regulations
XP P 41-280			

Certificates

IAPMO_4976	WRAS_2009	ACS_20 ACC LY
------------	-----------	---------------

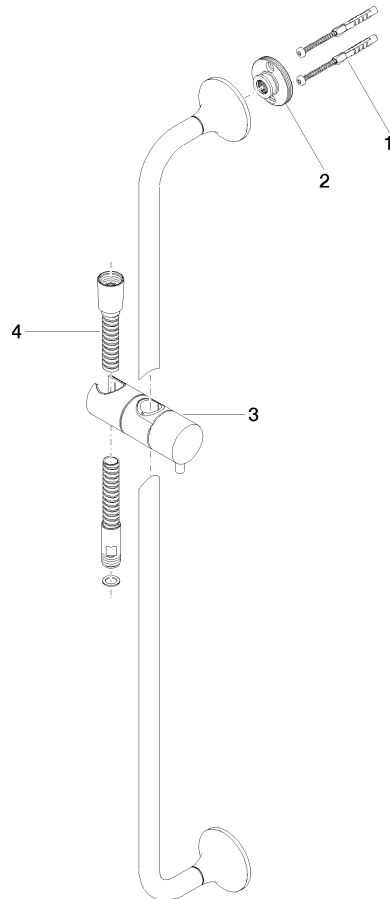



## VAIA Shower set without hand shower - Chrome

VAIA

26 413 809

### Spare parts list

No.	Item Number	Name	Quantity used	Delivery time
	05 30 31 025 00 90	fixing set	6	2